

ToolPRO

3 YEAR
WARRANTY



18V X 2

25L FRIDGE FREEZER

PLU: 713737



CONTENTS

Safety Information.....	3
In The Box.....	8
Operating Instructions.....	9
Maintenance.....	16
Troubleshooting.....	17
Technical Data.....	19
Warranty.....	20

SAFETY INFORMATION

WARNING SYMBOLS:



Read the operator's manual.



Detachable supply unit.



Warning.



Double insulation (For Charger/AC charger adaptor).



Positive terminal.



For indoor use only (For Charger/AC charger adaptor).



Negative terminal.



Do not burn.



Batteries may enter water cycle if disposed improperly, which can be hazardous for ecosystem. Do not dispose of waste batteries as unsorted municipal waste.



Li-Ion battery This product has been marked with a symbol relating to 'separate collection' for all battery packs and battery pack. It will then be recycled or dismantled in order to reduce the impact on the environment. Battery packs can be hazardous for the environment and for human health since they contain hazardous substances.



SMPS (Switch mode power supply unit) (For Adaptor).



SMPS incorporating a short-circuit-proof safety isolating transformer (inherently or non-inherently) (For Adaptor).



Energy efficiency rating (For Adaptor).



Warning: Risk of fire / flammable materials



Fuse.



Pressure



The output plug is with positive center pole and negative outer pole (For Adaptor).



RCM marking.

ABN: Australian Business Number. By this number, business information such as entity type, status, business location etc. can be found at website <http://abr.business.gov.au>.

ABN of Positec Australia Pty Limited is 14 101 682 357.

PRODUCT SAFETY

USERS CAN VIEW THE ELECTRONIC INSTRUCTIONS AT www.ToolPRO.com.

GENERAL SAFETY WARNINGS

 **WARNING!** Read all safety warnings and all instructions. Failure to follow the warnings and instructions may result in electric shock, fire and/or serious injury.

Save all warnings and instructions for future reference.

1. This appliance is not intended for use by persons (including children) with reduced physical, sensory or mental capabilities, or lack of experience and knowledge, unless they have been given supervision or instruction concerning use of the appliance by a person responsible for their safety.
2. Children aged from 8 years and above are allowed to use the appliances. Children should be supervised to ensure that they do not play with the appliance. Cleaning and user maintenance shall not be made by children without supervision.
3. The battery must be removed from the socket-outlet before cleaning or maintaining the appliance. The battery is not washable.
4. Check the voltage specification on the type plate corresponds to that of the energy supply. The appliance is only to be used with the power supply unit provided with the appliance.

DO NOT EXPOSE THE APPLIANCE OR BATTERY TO EXCESSIVE TEMPERATURES

1. Rechargeable batteries are to be removed from the appliance before being charged.
2. Different types of batteries or new and used batteries are not to be mixed.
3. Exhausted batteries are to be removed from the appliance and safely disposed of.
4. If the appliance is to be stored unused for a long period, the batteries should be removed.
5. Do not use non-rechargeable batteries in place of rechargeable batteries.
6. Do not use modified or damaged batteries.
7. **WARNING:** Use only with Toolpro battery charger or additional battery chargers listed in Operator's Manual.

SAFETY WARNINGS TO YOUR FRIDGE FREEZER

1. Suitable for camping use.
2. The appliance may be connected to more than one source of energy.
3. **WARNING:** Keep ventilation openings, in the appliance enclosure or in the built-in structure, clear of obstruction.
4. **WARNING:** Do not use mechanical devices or other means to accelerate the defrosting process, other than those recommended by the manufacturer.
5. **WARNING:** Do not damage the refrigerant circuit.
6. **WARNING:** Do not use electrical appliances inside the food storage compartments of the appliance, unless they are of the type recommended by the manufacturer.
7. Do not store explosive substances such as aerosol cans with a flammable propellant in this appliance.
8. This appliance is intended to be used in household and similar applications;

9. **WARNING:** When positioning the appliance, ensure the supply cord is not trapped or damaged.
10. **WARNING:** Do not locate multiple portable socket-outlets or portable power supplies at the rear of the appliance
11. **WARNING:** To avoid a hazard due to instability of the appliance, it must be fixed in accordance with the instructions.
12. To avoid contamination of food, please respect the following instructions:
 - a) Opening the door for long periods can cause a significant increase of the temperature in the compartments of the appliance.
 - b) Clean regularly surfaces that can come in contact with food and accessible drainage systems.
 - c) Store raw meat and fish in suitable containers in the fridge freezer, so that it is not in contact with or drip onto other food.
 - d) Two-star frozen-food compartments are suitable for storing pre-frozen food, storing or making ice-cream and making ice cubes.
 - e) One-, two- and three-star compartments are not suitable for the freezing of fresh food.
 - f) If the refrigerating appliance is left empty for long periods, switch off, defrost, clean, dry and leave the door open to prevent mould developing within the appliance.

This is a class III appliances and it must only be supplied at safety extra low voltage corresponding to the marking on the appliance.

WARNING! For the purposes of recharging the battery, only use the detachable supply unit provided with this appliance or charger listed in the manual.

WARNING! Only use the supply unit provided with this appliance with the following specifications: <14.5V DC 4.1A> <100-240V~50/60Hz, 1.8A>.

SAFETY WARNINGS FOR BATTERY PACK

- a) **Do not dismantle, open or shred cells or battery pack.**
- b) **Do not short-circuit a battery pack. Do not store battery packs haphazardly in a box or drawer where they may short-circuit each other or be short-circuited by conductive materials.** When battery pack is not in use, keep it away from other metal objects, like paper clips, coins, keys, nails, screws or other small metal objects, that can make a connection from one terminal to another. Shorting the battery terminals together may cause burns or a fire.
- c) **Do not expose battery pack to heat or fire. Avoid storage in direct sunlight.**
- d) **Do not subject battery pack to mechanical shock.**
- e) **In the event the battery leaks and contents makes contact with skin or eyes, flush immediately with running water. Flush eyes by holding eyelids apart and flush the eye continuously with running water. Continue flushing until advised to stop by a Poisons Information Centre (e.g. phone Australia 13 11 26; New Zealand 0800 764 766) or a doctor, or for at least 15 minutes. If pain returns or you experience an adverse reaction contact the Poisons Information Centre (e.g. phone Australia 13 11 26; New Zealand 0800 764 766) or a doctor without delay.**
- f) **Keep battery pack clean and dry.**
- g) **Wipe the battery pack terminals with a clean dry cloth if they become dirty.**

- h) Battery pack needs to be charged before use. Always refer to this instruction and use the correct charging procedure.
- i) Do not maintain battery pack on charge when not in use.
- j) After extended periods of storage, it may be necessary to charge and discharge the battery pack several times to obtain maximum performance.
- k) Recharge only with the charger specified by manufacturer. Do not use any charger other than that specifically provided for use with the equipment.
- l) Do not use any battery pack which is not designed for use with the equipment.
- m) Keep battery pack out of the reach of children.
- n) Retain the original product literature for future reference.
- o) Remove the battery from the equipment when not in use.
- p) Dispose of properly.
- q) Do not mix cells of different manufacture, capacity, size or type within a device.
- r) Keep the battery away from microwaves and high pressure.
- s) Warning! Do not use non-rechargeable batteries.
- t) If the battery gets hot, smokes, or swells. Immediately stop using the item and remove the battery pack from the charger or tool. Contact your retailer for further advice.

ADDITIONAL SAFETY INSTRUCTIONS FOR YOUR BATTERY CHARGER



WARNING! Read all safety warnings and all instructions. *Failure to follow all instructions listed below may result in electric shock, fire and/or serious injury.*

Save all warnings and instructions for future reference.

- This appliance is not intended for use by persons (including children) with reduced physical, sensory or mental capabilities, or lack of experience and knowledge, unless they have been given supervision or instruction concerning use of the appliance by a person responsible for their safety.
 - Children should be supervised to ensure that they do not play with the appliance.
1. Before charging, read the instructions.
 2. For charge ToolPRO battery pack only.
 3. Do not charge a leaking battery.
 4. Do not use chargers for works other than those for which they are designed.
 5. Before charging, ensure your charger is matching the local AC supply.
 6. The charging device must be protected from moisture.
 7. Do not use the charging device outdoors.
 8. Do not short out the contacts of battery or charger.
 9. Respect the polarity “+/-“ when charging.
 10. Do not open the unit and keep it out of the reach of children.
 11. Do not charge the batteries of other manufactures or ill-suited models.
 12. Ensure that the connection between the battery charger and battery is correctly positioned and is not obstructed by foreign bodies.
 13. Keep battery charger's slots free of foreign objects and protect against dirt and humidity. Store in a dry and frost-free place.
 14. When charging batteries, ensure that the battery charger is in a well-ventilated area and away from inflammable materials. Batteries can get hot during charging. Do not overcharge any batteries. Ensure that batteries and chargers are not left unsupervised during charging.
 15. Do not recharge non-rechargeable batteries, as they can overheat and break.
 16. Longer life and better performance can be obtained if the battery pack is charged when the air temperature is between 18°C and 24°C. Do not charge the battery pack in air

temperatures below 0°C, or above 40°C. This is important as it can prevent serious damage to the battery pack.

17. Charge only battery pack of the same model provided by manufacturer and of models recommended by manufacturer.
18. Do not expose the appliance or battery to excessive temperatures.
19. Rechargeable batteries are to be removed from the appliance before being charge.
20. Different types of batteries or new and used batteries are not to be mixed.
21. Exhausted batteries are to be removed from the appliance and safely disposed of.
22. If the appliance is to be stored unused for a long period, the batteries should be removed.
23. Do not use non-rechargeable batteries in place of rechargeable batteries.
24. Do not use modified or damaged batteries.

ADDITIONAL SAFETY WARNINGS FOR ADAPTOR

1. The outlet should be close to the device and be slightly accessible.
2. Use the device NOT with a damaged connecting cable or case.
3. Follow the technical data given by the manufacturer if you use the device.
4. Pull out the plug of the outlet if the device is not used.
5. Do not use the device for works other than those for which they are designed.
6. Max. Ambient temperature 45°C.
7. The mains connection management of this device cannot be substituted. By damage of the power cable the device has to be thrown away.
8. The device may not be put out to splashing water, rain or humidity.
9. Objects with liquids, e.g. vases, should not be put on the device.

IN THE BOX

- | | |
|----------------------------------|-----------------------------------|
| ① Door | ⑪ Handle Length Adjustment Button |
| ② Cup Holder | ⑫ Battery Port Cover |
| ③ Battery Port Latch | ⑬ Battery Port |
| ④ On/Off Button | ⑭ Wheel |
| ⑤ Temperature Adjustment Buttons | ⑮ Adaptor Port |
| ⑥ Mode Adjustment Button | ⑯ 240V AC adaptor |
| ⑦ Door Latch | ⑰ Cigarette Lighter Adaptor |
| ⑧ Sealing Strip | ⑱ Bottle opener |
| ⑨ Storage Box | ⑲ Storage box divider |
| ⑩ Pull Handle | |

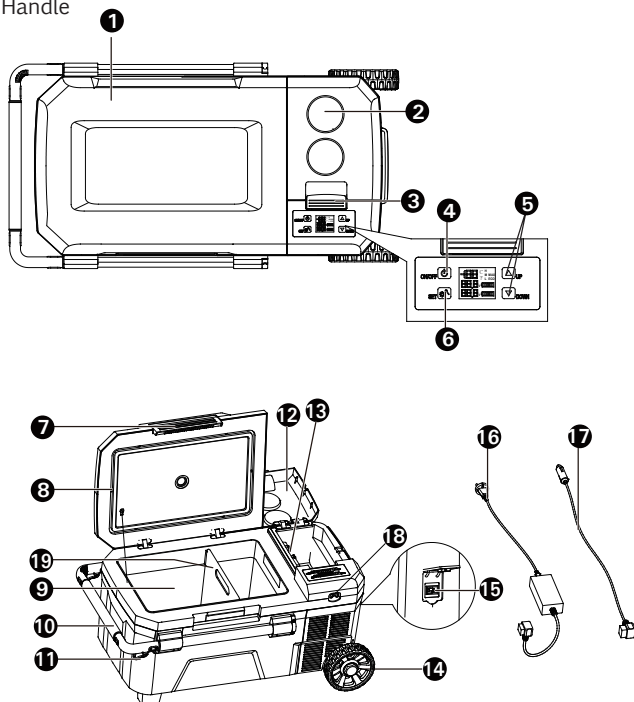

ACCESSORIES

Battery pack
 Battery charger
 Cigarette lighter adaptor
 240V AC adaptor

2
 1
 1
 1

OPERATING INSTRUCTIONS



NOTE: Before using the fridge freezer, read the instruction book carefully.

1. CHARGING

We strongly recommend to use ToolPRO battery & charger kit. Please contact you local Supercheap Auto store for more details or log onto www.supercheapauto.com.au for Australia or www.supercheapauto.co.nz for New Zealand customers to find out more details.

BEFORE PUTTING INTO OPERATION

CHARGING THE BATTERY PACK WITH CHARGER

NOTE:

- Do not use any charger other than that specifically provided for use with the equipment.
- If the battery pack is very hot, you must remove your battery pack from the charger and allow time for the battery to cool down before recharging.
- Please charge the battery to reach full before storage. If the tool will not be used for long periods of time, charge the battery every 3 months.
- Do not leave batteries on charger for long periods of time once fully charged.





CHARGING PROCEDURE (SEE FIG. A1)

- Plug the charger into an appropriate outlet. The green light will illuminate.
- Slide the battery pack into the charger, make sure the battery is in the correct charge position firmly. The green light will be off and red light will illuminate to indicate the charging process has started.
- When charging is completed, the red light turn off and green light will illuminate.
- After fully charged, unplug the charger and remove the battery pack.

Note: If the battery pack is locked in the charger, press the battery pack release button and remove it.

⚠ WARNING: When battery pack runs out after continuous use or exposure to direct sunlight or heat, allow time for the battery to cool down before re-charging to achieve the full charge.

CHARGING INDICATOR

Light	ON/OFF flash	Status
Green on 	————	Charger plug in, live (No battery inserted)
Red on 	————	Charging
Green on 	————	Fully charged
Green flash 	-----	Hot/Cold Delay
Red flash 	-----	Defective Battery

2. INSTALLING AND REMOVING THE BATTERY PACK (SEE FIG. A2)

Depress the battery pack release button firmly first and then slide the battery pack out from your fridge freezer. After recharge, slide the battery pack back into fridge freezer's battery port. A simple push and light pressure will be sufficient.

⚠ WARNING: Remember to remove battery pack or adaptor each time when adjusting, cleaning or leaving fridge freezer unused.

⚠ WARNING: The battery pack can only be charged by the charger. It cannot be charged when installed on the fridge freezer or connected to other power sources.

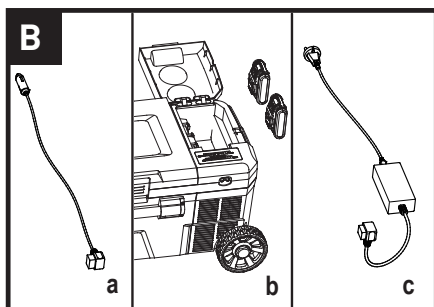
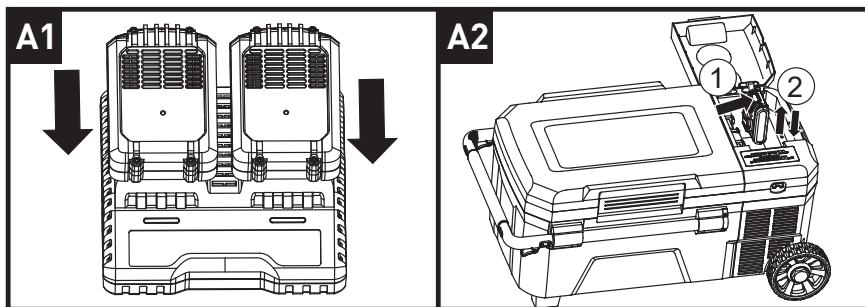

3. FRIDGE FREEZER POWER SUPPLY MODE (SEE FIG. B)

- Car mode: Use a "Cigarette Lighter Adaptor" to power the fridge freezer by utilizing the car's cigarette lighter socket.
- Battery power mode: Insert the batteries into the fridge freezer to start.
- AC power mode: Connect the fridge freezer to a power supply with 240V AC adaptor, then the fridge freezer is ready to work.

4. PULL HANDLE (SEE FIG. C1, C2)

Utilize the pull handle when moving the fridge freezer. The handle can extend or retract by pressing the pull handle length adjustment button.

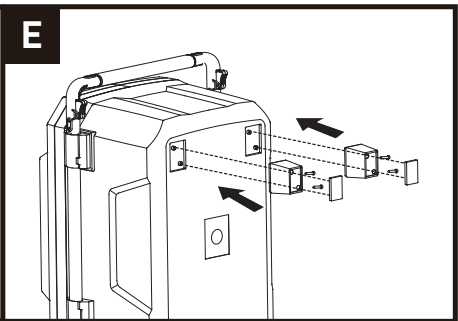
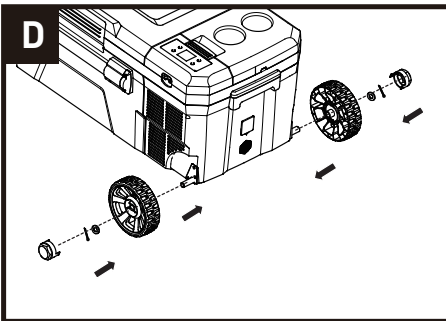
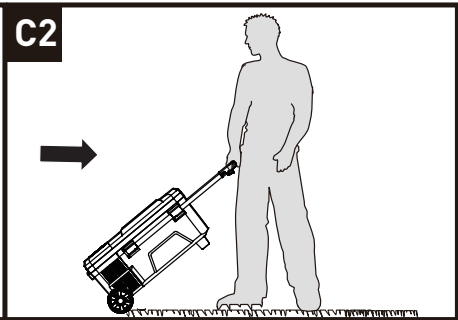
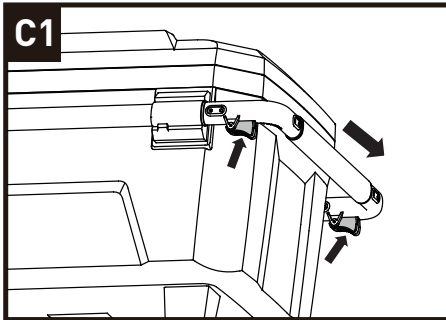

5. WHEEL ASSEMBLY (SEE FIG. D)

- 1) Place the wheel into the rod then place the washer into the rod.
- 2) Put the clip through the hole on the rod.
- 3) Install the wheel cap to lock the wheel. Make sure the wheel cap locked into place.

6. STAND ASSEMBLY (SEE FIG. E)

- 1) Align the holes on the stand with the holes on the fridge freezer base and install the stand into the hole on the fridge freezer base.
- 2) Fix the stand with the screws.
- 3) Attach anti-slip mat.

7. CONTROL PANEL (SEE FIG. F)

UP/DOWN : Press UP or DOWN for temperature setting.

MAX : Fast-cooling mode.

ECO : Energy-saving mode.

H L M : External power supply protection

L R : Left/Right battery case

 : Current temperature.

°C / °F : Celsius/Fahrenheit.

 : Set button.

 : On/OFF button.

 : Battery capacity indicator (only for battery power mode).

F

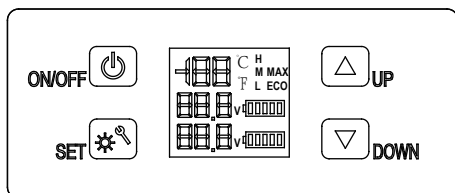

8. MODE SELECTION

A) AC POWER MODE (SEE FIG. G1, G2)

Turn on:

- 1) Plug the 240V AC adaptor into the adaptor port and connect the plug to a power supply.
- 2) Press the ON/OFF button.
- 3) The temperature and voltage are displayed on the control panel, the fridge freezer starts working.

Turn off:

- 1) Long press the ON/OFF button, the control panel turns off. The fridge freezer stops working.
- 2) Remove the adaptor from the power supply.

G1

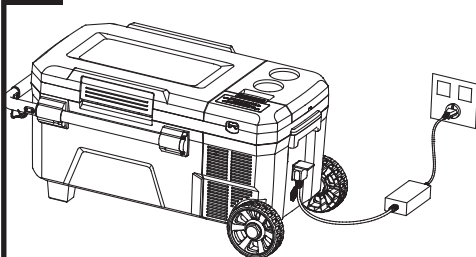

G2

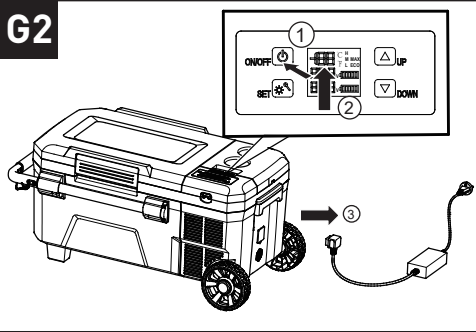

B) BATTERY POWER MODE (SEE FIG. H1, H2)

Turn on:

- 1) Put the batteries into the battery port.
- 2) Press the ON/OFF button to turn the fridge freezer on.
- 3) Close the battery port cover, make sure that the battery port latch clicks into place.

Turn off: Long press the ON/OFF button to power the fridge freezer off.

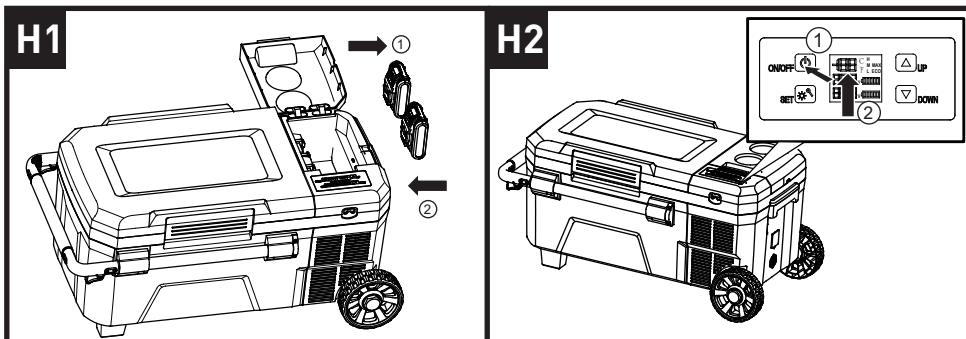

C) CAR MODE (SEE FIG. I1, I2)

Turn on:

- 1) Plug the cigarette lighter adaptor into the adaptor port and to the power supply in the car.
- 2) Press the ON/OFF button to turn the fridge freezer on.

Turn off:

- 1) Long press the ON/OFF button to power the fridge freezer off.
- 2) Remove the adaptor from the power supply.

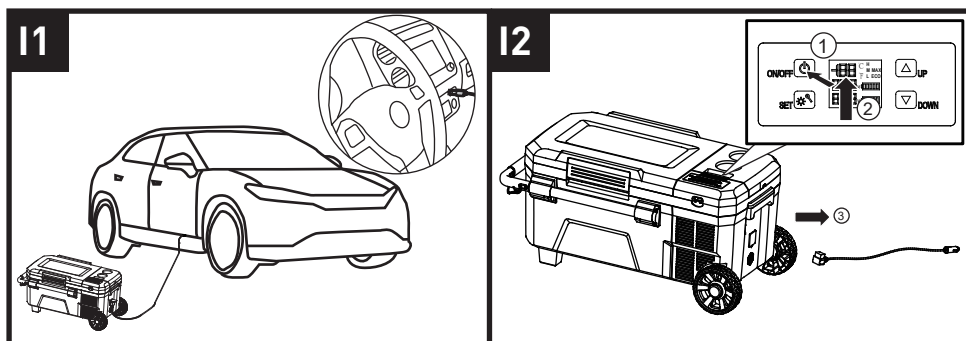

9. SET THE COOLING MODE (SEE FIG. J)

Turn the fridge freezer on, then press the set button once, then patterns on the control panel flash. Press the set button again to choose the preferred cooling mode. MAX for fast-cooling or ECO for energy saving.

NOTE: The default setting is MAX mode.

10. SET THE TEMPERATURE (SEE FIG. K)

Turn the fridge freezer on. Press the UP or DOWN button to adjust the temperature.

NOTE: Temperature setting range is: -20°C to 20°C / -4 °F to 68 °F.

⚠ WARNING: When the fridge freezer reaches the set temperature, it will rise by 2 degrees after a period of time, and then it will cool down to the set temperature again.

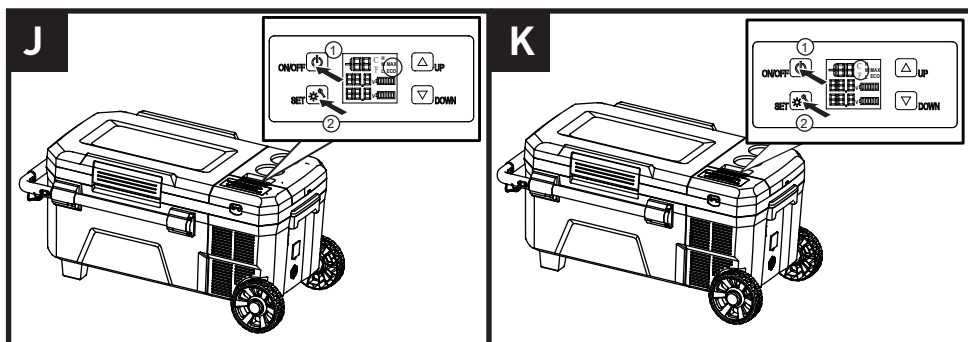

11. SETTING THE TEMPERATURE UNIT

Turn the fridge freezer on. Long press UP and DOWN button at the same time for 3 seconds until E1 is displayed. Then press the set button again until E5 is shown. Press UP or DOWN button to select Celsius or Fahrenheit.

NOTE: Factory default is Celsius / °C.

12. TRANSPORTATION AND MOVING (SEE FIG. C2)

1) Turn off the fridge freezer.

2) Lift the handle, push handle length adjustment button, leave the fridge freezer at a 30° angle and move the fridge freezer gently to anywhere you need to go.

⚠ WARNING: Make sure the fridge freezer is in the horizontal level during work. Turn off the fridge freezer if the fridge freezer is placed at an certain angle.

NOTE: When used outside, for best cooling results and extended runtime, pre-cool the fridge freezer with the AC charger adaptor or cigarette lighter adaptor. When the fridge freezer has reached desired temperature, install the batteries for portable cooling.

13. PARAMETER SETTING

Press “UP” and “DOWN” buttons 3 seconds to set the parameter. The control panel will flash E1 at the same time. Press set button again to change the choose, E1 to E9 will be displayed sequentially. Press “UP” or “DOWN” button to show value of the parameter. You also can change or save the value.

Parameter	Function	Setting scope	Initial value
E1	Minimum control temperature	-40°C~Control temperature	-20°C
E2	Maximum control temperature	Control temperature~40°C	+20°C
E3	Temperature hysteresis	1~10°C	2°C
E4	Restart protection time	0~10 minutes	0 minute
E5	°C/°F switchover	°C/°F	°C
E6	Temperature compensation value: Setting temperature≥-6°C	-10°C~+10°C	0°C

E7	Temperature compensation value: -7°C≥Setting temperature≥-12°C	-10°C~-10°C	0°C
E8	Temperature compensation value: Setting temperature≤-13°C	-10°C~-10°C	0°C
E9	Supercooling point	-10°C~0°C	0°C

*Displayed temperature=Measured temperature+Temperature compensation value

Restore factory settings: When the power is on, press “UP” and “DOWN” buttons for 3 seconds, and “E1” will be displayed. Then press “UP” and “DOWN” buttons for 3 seconds at the same time, and the control panel will display the full value. At this time, all parameters are restored to the factory settings.

 **WARNING:** Non-professionals should be careful when using other settings except E1 and E5 codes.

14. EXTERNAL POWER SUPPLY PROTECTION MODE

In order to prevent the fridge freezer from running down the car battery, the fridge freezer is equipped with EXTERNAL POWER SUPPLY PROTECTION MODE.

How to select EXTERNAL POWER SUPPLY PROTECTION MODE:

1. When the fridge freezer is ON, press the set mode button for 3 seconds until screen flashes, then press the set mode button again to select protection mode H (high), M (medium, L (low). Default setting is H (high) mode.

INPUT	DC 12 V		DC 24 V	
	CUT OUT	CUT IN	CUT OUT	CUT IN
L	9 V	10.3 V	21.3 V	22.7 V
M	10.1 V	11.4 V	22.3 V	23.7 V
H	11.1 V	12.4 V	24.3 V	25.7 V

NOTE:

It is suggested to select H when connected to car power, while, M or L should be set when it is connected to a portable battery or other back-up battery.

15. RECOMMENDED TEMPERATURE FOR COMMON FOOD

Common Food	Recommended Temperature
Fruits	5~8 °C / 41~46 °F
Vegetable	3~10°C / 37~50 °F
Meat	-18 °C / 0 °F
Drinks	5 °C / 41 °F
Cold Cuts/Cheese	4 °C / 39 °F
Wine	10 °C / 50 °F
Ice cream	-10 °C / 14 °F

MAINTENANCE

For Battery tools

The ambient temperature range for the use and storage of tool is 32 °F~113 °F (0 °C~45 °C).

The ambient temperature range for the discharge of battery is 14 °F~113 °F (-10 °C~45 °C)

The ambient temperature range for the storage of battery is 32 °F~77 °F (0 °C~25 °C).

The recommended ambient temperature range for the charging system during charging is 41 °F~104 °F (5 °C~40 °C).

Cleaning

Clean the fridge freezer by using a wet cloth to wipe out the inside after use.



WARNING:

1. Turn the fridge freezer off and unplug the product before cleaning the fridge freezer.
2. Do not submerge the fridge freezer or rinse it with water.
3. Do not use any abrasive cleaning agents to clean the fridge freezer as these agents may cause damages to the product.

Frost will reduce the cooling capacity. It is suggested to defrost in time to avoid this:

1. Switch off and unplug the device;
2. Empty the storage box;
3. Leave the door open;
4. Wipe off the defrosted water with a soft cloth.



WARNING: Never use the hard or sharp tools to break the ice or remove any objects which have frozen in place.

Storage

Short-time storage

Turn the fridge freezer off and unplug the product. Use a dry cloth to clean the inside of the fridge freezer and place it in storage.

Long-time storage



1. Switch off and unplug the device.
2. Empty the storage box and use a dry cloth to wipe the excess water from the fridge freezer,;
3. Put the fridge freezer in a dry place and keep the lid slightly open to avoid odors.
4. Recommended storage environment: ambient temperature: 77 °F / 25 °C, ambient humidity: 75%.

TROUBLESHOOTING

Problem	Reasons/Suggestions
Fridge freezer does not work.	<ol style="list-style-type: none"> 1. Check if the ON/OFF switch is on; 2. Check if connected to a power source or batteries are installed; 3. Check if the fuse is burnt; 4. Ensure power supply is functioning correctly; 5. Do not switch on/off the fridge freezer frequently as it may cause start delay of the compressor.
Objects are frozen in the fridge freezer.	The temperature is set too low.
Fridge freezer storage box is abnormally warm.	<ol style="list-style-type: none"> 1. The fridge freezer has stored a large amount of warm or hot food recently; 2. The fridge freezer lid is opened frequently; 3. The fridge freezer has been cut off power for a long time.
Water flow noise from the fridge freezer inside.	This is normal and comes from the compressor inside.
Water drops around the fridge freezer lid.	It is normal that the moisture will condense to water when it touches a cold surface of the fridge freezer.
The compressor is slightly noisy when running.	No need to worry because the noise will be reduced after the compressor is stably running.
Code F1 shown	<p>Possible reasons: low voltage. Adjust the power protection mode from High to Medium or from Medium to Low.</p>
Code F2 shown	<p>Possible reasons: condenser fan is overloaded. Cut the power off for five minutes and re-start If the code shows again, please contact manufacturer for help.</p>
Code F3 shown	<p>Possible reasons: the compressor is starting too frequently. Cut the power off for five minutes and re-start If the code shows again, please contact manufacturer for help.</p>
Code F4 shown	<p>Possible reasons: compressor not kicking in. Cut the power off for five minutes and re-start If the code shows again, please contact manufacturer for help.</p>
Code F5 shown	<p>Possible reasons: overheating of the compressor & electronics. Cut the power off for five minutes and re-start If the code shows again, please contact manufacturer for help.</p>
Code F6 shown	<p>Possible reasons: no parameter can be detected by the controller. Cut the power off for five minutes and re-start If the code shows again, please contact manufacturer for help.</p>
Code F7/ F8 shown	<p>Possible reasons: temperature sensor is faulty. Contact manufacturer for help.</p>

Code FA/FB shown	Possible reasons: Compressor module failure. Remove the batteries out and plug the batteries again to see if it works. If code still shows, contact manufacturer for help.
Code FC/C7 shown	Possible reasons:Low battery voltage or faulty battery pack. Remove the batteries out and plug the batteries again to see if it works. If code still shows, contact manufacturer for help.
Code C1/C2 shown	Possible reasons: The ambient temperature is too high. Wait for the temperature to drop to recover
Code C3 shown	Possible reasons: The ambient temperature is too low. If it does not recover after the temperature rises and restart the machine, please remove the batteries out and plug the batteries again to see if it works. If code still shows, contact manufacturer for help.
Code C4/C5/C6/C8/ C9 shown	Possible reasons:Battery pack failure. Remove the batteries out and plug the batteries again to see if it works. If code still shows, contact manufacturer for help.

TECHNICAL DATA

Voltage	18V 	
Capacity	25L	
Temperature control setting range	-4 °F to 68 °F (-20 °C~20 °C)	
Power supply input	100-240V~ 50-60Hz 1.8A	
Power supply output	14.5V  4.1A	
Cigarette lighter charging input	12/24V	
Climatic class	T	
Refrigerant	R1234YF	
Machine weight (without battery)	14.6 kg	
Charger input (ACG1820D2)	100-240V~50/60Hz, 50W	
Charger output (ACG1820D2)	20V  2.0A	
Battery capacity (ABP1840TD1)	4Ah Li-ion battery	
Charging time	4Ah Li-ion battery	
	2 hours (1 x battery)	4 hours (2 x batteries)

WARRANTY

WARRANTY STATEMENT FOR ToolPRO

Our goods come with guarantees that cannot be excluded under the Australian Consumer Law. You are entitled to a replacement or refund for a major failure and for compensation for any other reasonably foreseeable loss or damage. You are also entitled to have the goods repaired or replaced if the goods fail to be of acceptable quality and the failure does not amount to a major failure. Where a failure does not amount to a major failure, we are entitled to choose between providing you with a repair, replacement or refund. To obtain compensation, you would need to provide documentary evidence of the loss or damage suffered, and documentary evidence that such loss or damage was a reasonably foreseeable consequence of a failure by us to comply with a consumer guarantee under the Australian Consumer Law. Such evidence may include photographs, statutory declarations, receipts or reports (e.g. from your doctor), depending on the loss or damage.

In addition to any rights and remedies you may have under the Australian Consumer Law and any other applicable law, if this product becomes defective due to faulty materials or workmanship within a period of 3 years from the date of purchase, we guarantee to:

- Replace or repair all defective parts, free of charge; or
- Repair products free of charge; or
- Replace the unit with a new or re-conditioned unit free of charge.

Your warranty is subject to the following conditions:

- Battery packs are guaranteed for a 12 month period only.
- This product has not been misused, abused, neglected, altered, modified or repaired by anyone other than an authorized service centre.
- Only genuine ToolPRO accessories and parts have been used on or with the product.
- This product has been subjected to fair wear and tear.
- This product has not been used for trade or professional purposes.
- This product has not been used for rental purposes.
- This product has not sustained damage through foreign objects, substances or accidents.

Your warranty does not cover:

- Components that are subject to natural wear and tear caused by use in accordance with operating instructions.
- Unauthorized/improper maintenance/handling or overload are excluded from this warranty as are accessories such as bulbs, blades and bits, etc.
- Accessories supplied with this product.

For claims under this ToolPRO warranty, please contact the ToolPRO Helpline. To make a claim you will need to provide proof of purchase in the form of a valid receipt that displays the date and place of purchase. Any expense you incur in claiming under the ToolPRO warranty will be borne by you.

ToolPRO Helpline 1300 889 028

This guarantee statement does not replace but is in addition to your statutory rights.

This warranty applies only to the original purchaser and may not be transferred.

All repairs and replacement products will be covered by the limited warranty of the balance of the warranty period from the date of the original purchase.

This ToolPRO warranty is provided by Positec Australia Pty Limited ACN 101 682 357 of 25 Research Drive, Croydon South VIC 3136

Return product to place of purchase.





PLU: 713737

CODE: LEC1825D

Manufactured and Packaged for

SRGS PTY. LTD.

ABN 23 113 230 050

6 Coulthards Avenue, Strathpine,
Queensland 4500, Australia.

MADE IN CHINA