

**SCA**

VALUE YOU CAN TRUST



**QUALITY  
ASSURED**



# 1400W 1500PSI HIGH PRESSURE WASHER

---

## INSTRUCTION MANUAL



PLU 637450

# CONTENTS

Safety Information.....	3
In The Box.....	6
Accessories.....	8
Assembly.....	8
Material & Paint Selection.....	11
Operating Instruction.....	12
Maintenace.....	15
Troubleshooting.....	16
Technical Data.....	17
Warranty.....	19

# SAFETY INFORMATION



Important - Please read these instructions fully before starting assembly.

## WARNING SYMBOLS



Read the manual



Warning



Warning: Do not direct the jet at persons, animals and electrical equipment



Machine not suitable for connection to the potable water mains



Double insulation



RCM marking

ABN: Australian Business Number. By this number, business information such as entity type, status, business location etc. can be found at website <http://abr.business.gov.au>.

ABN of Positec Australia Pty Limited is 14 101 682 357

## GENERAL POWER TOOL SAFETY WARNINGS



**WARNING!** Read all safety warnings and all instructions. Failure to follow the warnings and instructions may result in electric shock, fire and/or serious injury.

### Save all warnings and instructions for future reference.

- This machine is not intended for use by persons (including children) with reduced physical, sensory or mental capabilities, or lack of experience and knowledge.
  - Children should be supervised to ensure that they do not play with the appliance.
- If the supply cord is damaged, it must be replaced by the manufacturer, its service agent or similarly qualified persons in order to avoid a hazard.

## ADDITIONAL POWER TOOL SAFETY WARNINGS



**WARNING:** Do not use the appliance without reading the instruction sheet.

- Safety boots, safety gloves, safety helmets with visors, hearing protection etc. shall be worn while operating the machine.
- When opening the trigger gun, there is a danger of the kickback force and the sudden torque on the spray assembly. Please hold the nozzles tightly.
- **WARNING** This machine has been designed for use with the cleaning agent supplied or recommended by the manufacturer. The use of other cleaning agents or chemicals may adversely affect the safety of the machine.
- **WARNING** During use of high pressure cleaners, aerosols may be formed. Inhalation of aerosols can be hazardous to health.
- **WARNING** High pressure jets can be dangerous if subject to misuse. The jet must not be directed at persons, live electrical equipment or the machine itself.
- **WARNING** Do not use the machine within range of persons unless they wear protective clothing.
- **WARNING** Do not direct the jet against yourself or others in order to clean clothes or foot-wear.
- Disconnect from the electrical power supply before carrying out user maintenance
- **WARNING** High pressure cleaners shall not be used by children or untrained personnel.
- **WARNING** Risk of explosion – Do not spray flammable liquids.
- **WARNING** To ensure machine safety, use only original spare parts from the manufacturer or approved by the manufacturer.
- **WARNING:** High pressure hoses, fittings and couplings are important for the safety of the appliance. Use only hoses, fittings and couplings recommended by the manufacturer
- **WARNING** Water that has flown through backflow preventers is considered to be non-potable.
- **WARNING** The machine shall be disconnected from its power source by removing the plug from the socket-outlet during leaning or maintenance and when replacing parts or

converting the machine to another function.

- WARNING Do not use machine if a supply cord or important parts of the machine are damaged, e.g. safety devices, high pressure hoses, trigger gun.
- WARNING If an extension cord is used, the plug and socket must be of watertight construction.
- WARNING Inadequate extension cords can be dangerous. If an extension cord is used, it shall be suitable for outdoor use, and the connection has to be kept dry and off the ground. It is recommended that this is accomplished by means of a cord reel which keeps the socket at least 60 mm above the ground.
- The electric supply connection shall be made by a qualified electrician and comply with AS/NZS 3000. It is recommended that the electric supply to this machine should include either a residual current device that will interrupt the supply if the leakage current to earth exceeds 30 mA for 30 ms or a device that will prove the earth circuit.

# IN THE BOX

- 1 Spray gun
- 2 Spray gun holder
- 3 On/Off switch
- 4 Connection lance
- 5 Outlet
- 6 Outlet lock knob
- 7 Wheels\*2
- 8 Electric cable
- 9 Holder for electric cable
- 10 Handle
- 11 Trigger switch
- 12 Hose holder
- 13 Inlet water connector
- 14 High pressure hose
- 15 Nozzle cleaning tool (O ring)
- 16 Lance holder fence
- 17 Lock-off switch ( See I1)

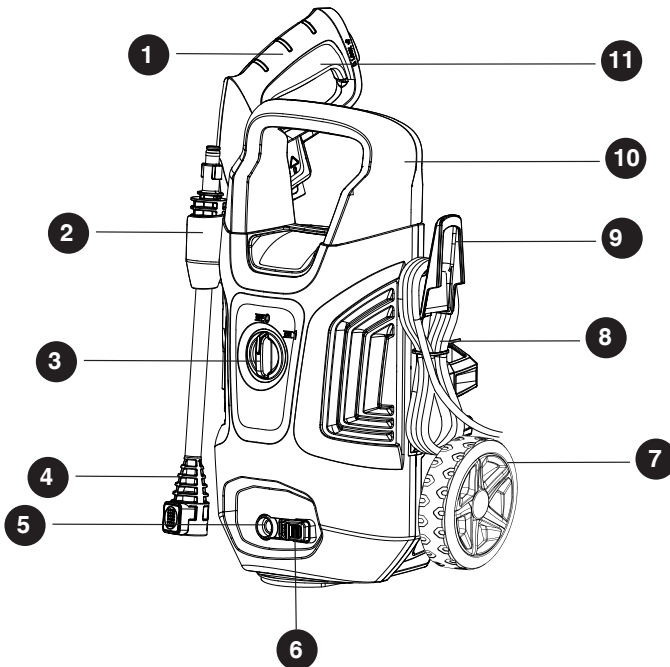

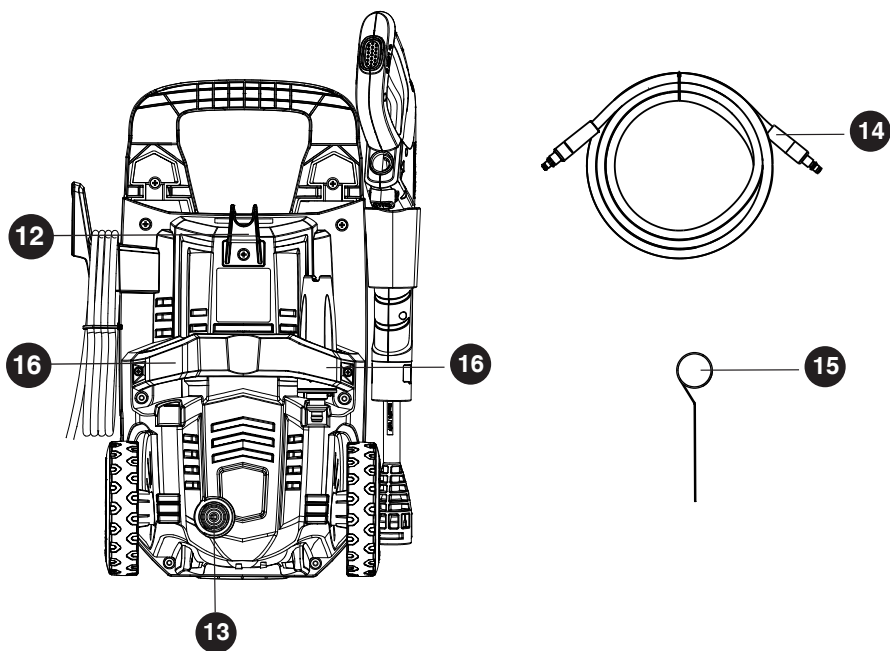

# ACCESSORIES

Spray gun	1
Normal nozzle	1
Pressure hose(3M)	1
Soap bottle	1
Spray gun holder	1
Electric cable holder	1
Inlet water connector	1
Connection lance	1

# ASSEMBLY



**NOTE:** Before using the tool, read the instruction book carefully.

## ASSEMBLY

### 1. Assembling spray gun holder

Press the spray gun holder (2) on to the machine. (Fig. A)

### 2. Mounting of holder for electric cable

Press the holder for electric cable (9) on to the machine. (Fig. B)

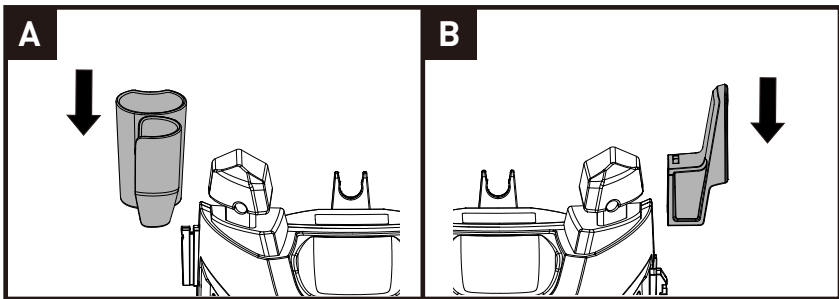



### 3. Mounting of inlet water connector

Attach inlet water connector (13) to the machine's inlet. (Fig. C, D)

### 4. Mounting of adjustable spray nozzle and lance holder

Place the adjustable spray nozzle and lance holder on to the machine, and fix the screws. (Fig. E)

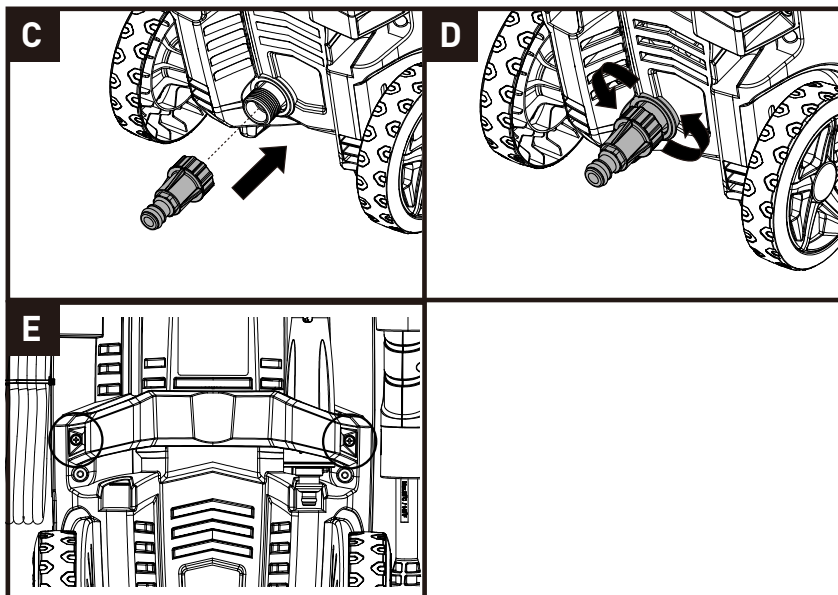

### 5. Mounting of handle

Press the handle (10) on to the machine, and fix the screws. (Fig. F1, F2)

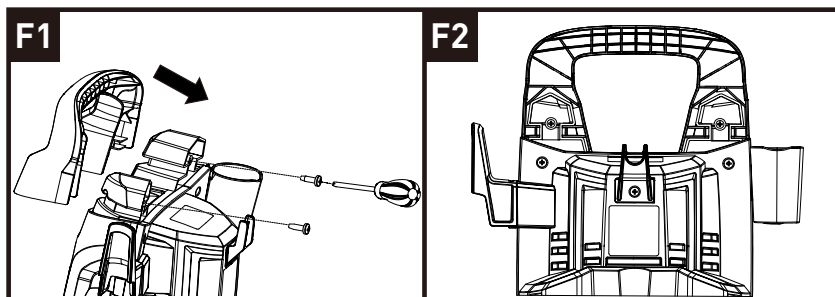

## 6. Assembling the high pressure hose

- 1) Make sure that on/off switch (3) is in off position. (Fig. G1)
- 2) Insert the high-pressure hose (14) to spray gun (1). (Fig. G2)
- 3) Insert the lance into spray gun (1), and twist 1/4 turn. Then insert the adjustable spray nozzle into the lance, and twist 1/4 turn until rectangular tab appears. (Fig. G3, G4)
- 4) Connect the high-pressure hose (14) to the high-pressure outlet (5). (Fig. G5)

**NOTE:** When remove the high-pressure hose from the spray gun (1), firstly press the button, then take the hose out of the spray gun (1).

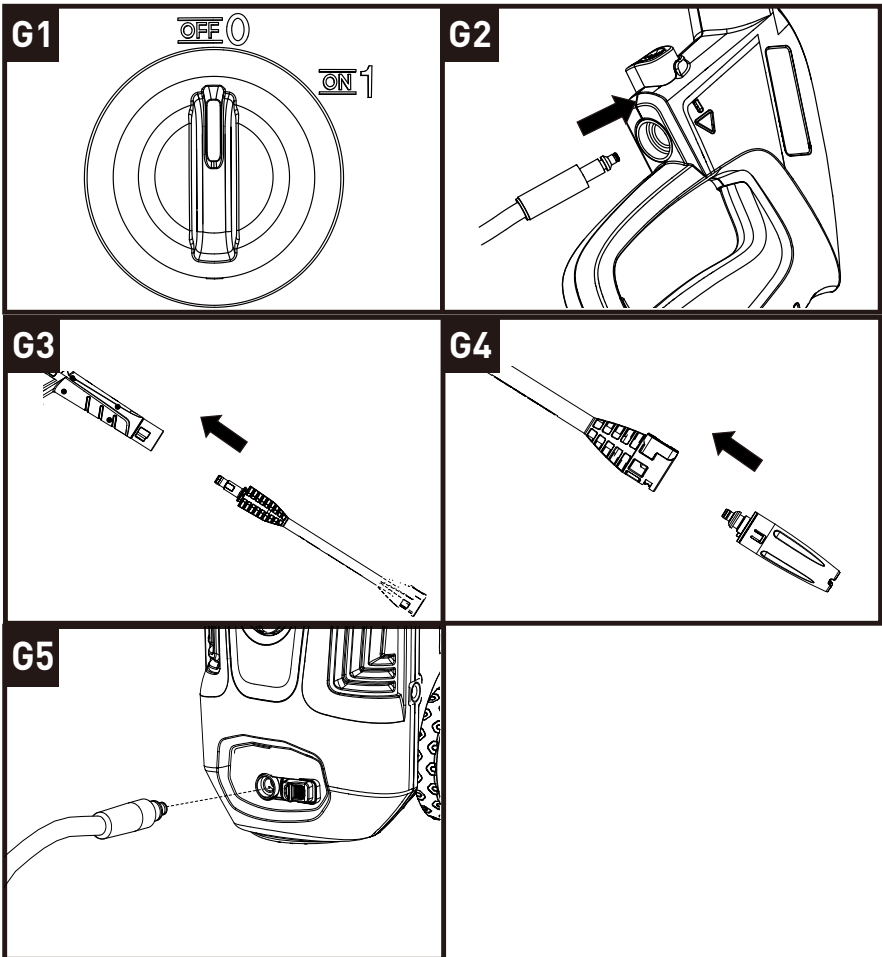

### 7. Connecting water supply

Attach garden hose to water supply and turn water on. (Fig. H)

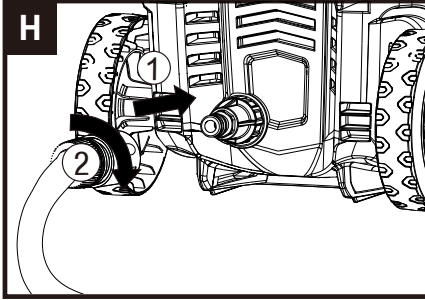

# OPERATION INSTRUCTION

## Caution!

1. Never use the pressure washer to draw in water contaminated with solvents (e.g. paint thinners, gasoline, oil, etc.).
2. Dirt in the feed water will damage the unit. To avoid this risk, we recommended checking the water filter (located inside the water inlet; to clean it out see maintenance section).
3. Always prevent debris from being drawn into the unit by using a clean water source and an accessory water source and an accessory water filter if required.

## Water supply (cold water only)

1. Do not draw non-water liquids through the unit. For use with cold water supply only.
2. Water hose must be at least a 1/2" in diameter.
3. Flow rate of water supply must not fall below 5.5 l/min.
4. Flow rate can be determined by running the water for one minute into an empty container.
5. The water supply temperature must not exceed 40°C (104°F).

## 1. ON/OFF safety switch

- 1) Connect the plug to into a properly grounded outlet.
- 2) Before turning the unit on, press the gun trigger to bleed any trapped air out of the pump and hose.
- 3) Your switch is in a locked off position to prevent in accidental starting. (Fig. I1)
- 4) Depress lock off button then gun trigger and release lock off button. Your switch is now on. (Fig. I2)
- 5) To switch off just release the gun trigger.
- 6) Start the pressure washer by turning ON/OFF switch (3) to ON. Press the trigger.  
Reminder: motor does not run continuously, only when trigger is squeezed. (Fig. I3, I4)

## Surface preparation

Before starting any cleaning task it is important the area for objects which could create a hazard. Remove objects from the work area which area which could be tripped over, such as toys or outdoor furniture. Ensure that all doors and windows are closed tight.

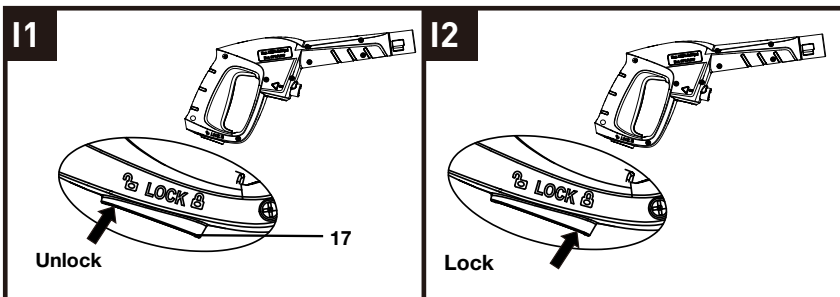

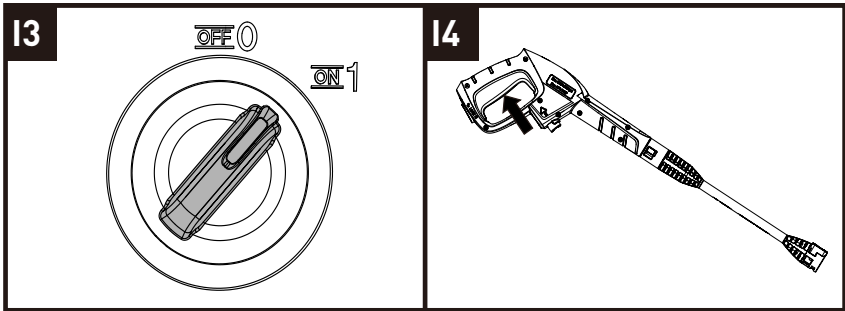

## 2. USING THE ACCESSORIES

### 2.1 Adjustable wand

The adjustable nozzle allows you to use any variety of spray patterns from a fan spray to a pencil jet spray. When using pressure washer to clean wood decks, siding, vehicles etc., always start using the fan spray and begin spraying from a minimum 36" away to avoid damaging the surface of the material you are cleaning.

**CAUTION:** Do not adjust the nozzle while the trigger is squeezed.

### 2.2 Adjusting the spray

The adjustable spray nozzle can adjust from fan to jet setting. The spray is adjusted from jet spray to fan spray by turning the nozzle as shown in J1, J2.

**NOTE:** the pressure of the spray on the surface you are cleaning increases as you move the wand closer to the surface.

**CAUTION:** Jet spray adjustment is very aggressive. Do not adjust while spraying. We recommend that for most cleaning applications a 20-degree spray angle should be used to avoid damage to the surface being sprayed.

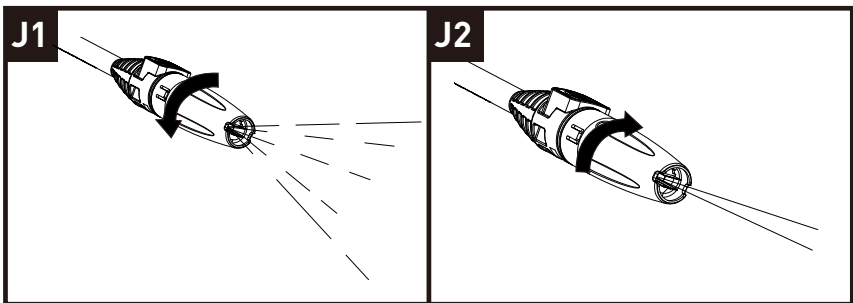

## STORAGE

The machine should be stored in a frost-free room! Pump, hose and accessories should always be emptied of water prior to storing as follows:

1. Stop the machine and detach water hose and accessory.
2. Restart the machine and activate the trigger. Let the machine run until no more water runs through the spray gun (1).
3. Stop the machine, unplug and wind up hose and cable.
4. Place spray handle, nozzles and other accessories in the holders of the machine. Should the machine by mistake be frozen, it will be necessary to check it for damage.

### **NEVER START-UP A FROZEN MACHINE.**

Frost damages are not covered by the guarantee! Winding up of electric cable (8) and high pressure hose

To avoid accidents, the electric cable (8) and the high pressure hose (14) should always be wound carefully up around the handle (10). Wind up the cable on the appropriate hook.

### **Storage of accessories**

The lance and the nozzles can be stored on the pressure washer.

# MAINTENANCE

**WARNING!** Always disconnect the electrical plug from the socket prior to maintenance or cleaning. To ensure a long and problem free working life, please take the following advice:

- Wash out water hose, high pressure hose, spray lance and accessories before mounting.
- Clean the connectors of dust and sand.
- Rinse the detergent spraying attachment after use.
- Clean the nozzles.

Any repair should always be made in an authorized workshop with original spare parts. If the supply cord is damaged, it must be replaced by the manufacturer, its service agent or similarly qualified persons in order to avoid a hazard.

## Cleaning of water inlet filter

Clean the water inlet filter regularly once a month or more frequently according to use. Carefully loosen the filter with a screwdriver and clean it. Check that it is intact before re mounting it.

The inlet filter must always be fitted inside the water inlet pipe to filter out sand, limestone and other impurities, as they will damage the pump valves.

**CAUTION:** Failure to fit the filter will invalidate the guarantee.

## Cleaning of nozzle

A clogging up in the nozzle causes a pump pressure which is too high. This is why cleaning is required immediately.

1. Stop the machine and disconnect the nozzle.
2. Clean the nozzle.

**IMPORTANT:** The cleaning tool should only be used when the nozzle is detached! (Fig. K)

3. Flush the nozzle backwards with water.

## Cleaning of machine vents

The machine should be kept clean so as to let cooling air pass freely through the machine vents.

## Greasing of couplings

To ensure an easy connection and that o-rings do not dry up. The couplings should be greased regularly.

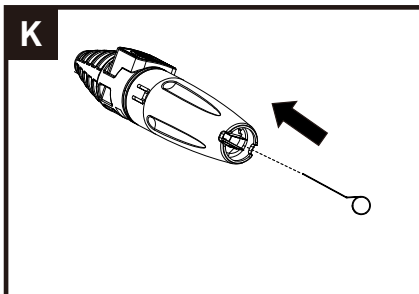

# TROUBLESHOOTING

Disconnect the machine from the power source before making any repair. To avoid unnecessary disappointments, you should check the following before contacting the service organization:

Symptom	Possible causes	Solution
Machine refuses to start	Machine not plugged in Defective socket Fuse has blown Defective extension cable	Plug in machine Try another socket. Replace fuse. Switch off other machines. Try without the extension cable.
Fluctuating pressure	Pump sucking air Valves dirty, worn out or stuck Pump seals worn out	Check that hoses and connections are airtight. Clean and replace or refer to local distributor Clean and replace or refer to local distributor
Machine stops	Fuse has blown Incorrect mains voltage  Thermal sensor activated Nozzle partially blocked	Replace fuse. Switch off other machines. Check that the mains voltage corresponds to specification on the model tag. Leave the washer for 5 minutes to cool down. Clean the nozzle
Fuse blows	Fuse too small	Change to an installation higher than the amp. consumption of the machine. You may try without the extension cable.
Machine pulsating	Air in inlet hose  Inadequate supply of mains water  Nozzle partially blocked Water filter blocked Hose kinked	Pump allow machine to run with open trigger until regular working pressure resumes. Check that the water supply corresponds to specifications required Warning! Avoid using long, thin hoses (min. 1/2") Clean the nozzle Clean the filter Straighten out hose.
Machine often starts and stops by itself	Pump/spray gun is leaking Centre.	Contact your nearest Service
Machine starts, but no water comes out	Pump/hoses or accessory frozen No water supply Water filter blocked Nozzle blocked	Wait for pump/hoses or accessory to thaw. Connect inlet water. Clean the filter Clean the nozzle



# TECHNICAL DATA

Voltage	220-240V~50/60Hz
Rated power	1400 W
Rated pressure	7 MPa(1000 psi)
Max Pressure	10.5 MPa(1500 psi)
Rated water flow rate	5.5 l/min
Maximum inlet water pressure	0.7 MPa(100 psi)
Protection class	□ /II
Protection degree	IPX5
Machine weight	4.5 kg
Product dimensions	270*265*490 mm

**NOISE Information**

A weighted sound pressure  
 A weighted sound power  
 Guaranteed sound power  
 $K_{PA}$  &  $K_{WA}$   
 Wear ear protection.

$L_{PA} = 73.4 \text{ dB(A)}$   
 $L_{WA} = 87.4 \text{ dB(A)}$   
 $= 92 \text{ dB(A)}$   
 $3.0 \text{ dB(A)}$

**VIBRATION INFORMATION**

Vibration emission value	$a_h = 0.979 \text{ m/s}^2$ (Main handle)
	$a_h = 1.020 \text{ m/s}^2$ (Auxiliary handle)
Uncertainty $K = 3.0 \text{ m/s}^2$	

The declared vibration total value may be used for comparing one tool with another, and may also be used in a preliminary assessment of exposure.

 **WARNING:** The vibration emission value during actual use of the power tool can differ from the declared value depending on the ways in which the tool is used dependant on the following examples and other variations on how the tool is used:  
 How the tool is used and the materials being cut or drilled.

The tool being in good condition and well maintained.

The use the correct accessory for the tool and ensuring it is sharp and in good condition.

The tightness of the grip on the handles and if any anti vibration accessories are used.

And the tool is being used as intended by its design and these instructions.

**This tool may cause hand-arm vibration syndrome if its use is not adequately managed.**

 **WARNING:** To be accurate, an estimation of exposure level in the actual conditions of use should also take account of all parts of the operating cycle such as the times when the tool is switched off and when it is running idle but not actually doing the job. This may significantly reduce the exposure level over the total working period.

Helping to minimize your vibration exposure risk.

ALWAYS use sharp chisels, drills and blades.

Maintain this tool in accordance with these instructions and keep well lubricated (where appropriate).

If the tool is to be used regularly then invest in anti vibration accessories.

Plan your work schedule to spread any high vibration tool use across a number of days.

# WARRANTY

Our product is guaranteed to be free from quality and manufacturing defects for a period of 12 months.

If your product becomes defective during this period, SRGS PTY LTD will offer you either a replacement, credit or refund where a product is faulty; wrongly described; different from the sample shown to you or do not do what they are supposed to do.

This warranty will not cover substantially modified product; misuse or abuse of the product contrary to user instructions or packaging label; change of mind and normal wear and tear.

Our goods come with guarantees that cannot be excluded under the Australian Consumer Law. You are entitled to a replacement or refund for a major failure and for compensation for any other reasonably foreseeable loss or damage. You are also entitled to have the goods repaired or replaced if the goods fail to be of acceptable quality and failure does not amount to a major failure.

To claim the warranty, take the product to the front Service Desk of your nearest store of purchase. You will need to show receipt or other proof of purchase. Additional information may be required to process your claim. Should you not be able to provide proof of purchase with a receipt or bank statement, identification showing name, address and signature may be required to process your claim.

Any expenses relating to the return of your product to the store will normally have to be paid by you. For online store purchases, SRGS PTY LTD will pay for the return freight for any product assessed as having a major failure.

The benefits to the customer given by this warranty are in addition to other rights and remedies of the Australian Consumer Law in relation to the goods or services to which this warranty relates.

This warranty is provided by SRGS PTY LTD, 6 Coulthards Avenue, Strathpine QLD 4500, Australia. Phone: 1300 175 010.

**SCA**

VALUE YOU CAN TRUST



**QUALITY  
ASSURED**

**1** YEAR  
WARRANTY

# 1400W 1500PSI HIGH PRESSURE WASHER

## INSTRUCTION MANUAL



**QUALITY  
ASSURED**

*"If the product fails to perform as specified  
we'll happily offer a refund or exchange"*

Manufactured & packaged for SRGS PTY LTD ABN 23 113 230 050  
6 Coulthards Avenue Strathpine QLD 4500, Australia  
MADE IN CHINA