

## INSTRUCTIONS FOR USE:

Thank you for purchasing the Bigboi Mini+. Before you start enjoying the features and benefits of touchless drying please take a minute to read the below and familiarizes yourself with the dryer.

### IN THE BOX

- Bigboi Blower MINI+
- 5 meter hose
- 1 replacement filter
- 2 lockable hose nozzles

Open the dryer box, take out the dryer, and check its appearance, if there is no damage; go on with following steps:

1. Place or fix the dryer, connecting the hose with hose adapter. Fastening clockwise with 45 degree.
2. Plug in the dryer (please make sure the power supply voltage in your country matches the machine);
3. Switch on the dryer and adjust it to your desired wind speed. The temperature will adjust automatically during operation subject to your speed and motor set up. Then the dryer can begin the drying process.

### IMPORTANT NOTICE

1. This machine use AC power source, power must have good grounding before used.
2. To maintain a smooth flow of air,

For further information on any Bigboi products, please contact [hello@ibigboi.com](mailto:hello@ibigboi.com)

please keep a safe distance from the surface. This will allow the warm filtered air to travel smoothly over a larger surface making the drying more efficient and preventing Taking in water which may damage the machine.

3. Clean the filters regularly to ensure a smooth air flow.
4. If the motor does not work after being plug in, please turn off heat Switch immediately to avoid damaging the heating element.
5. Do not let minors close or play with the machine!
6. The appliance is not to be used by persons (including children) with reduced physical sensory or mental capabilities or lack of experience and knowledge, unless they have been given supervision or instruction. Children being supervised not to play with the appliance

### MAINTENANCE INSTRUCTION

1. The shell of the machine can be cleaned with a soft cloth and neutral detergent solution (to avoid spoiling the paint work) then use a dry cloth to clean it;
2. Use water or strong fan to clean the filters regularly. Note that filters cannot be fixed on the machine until it is totally dry, in case the water may damage the machine. The machine has a standby filter packaged with it.
3. When the machine runs out of carbon brush, please contact a professional to check and update the required parts.

## BIGBOI BLOWR MINI+ INSTRUCTION MANUAL

BLOW  MINI+



# TOUCHLESS CAR, MOTORCYCLE & MARINE DRYER

## STRUCTURE

### REPRESENTATION

| NO | Name                                    | Amount |
|----|---|--------|
| 1  | Air nozzle                              | 2      |
| 2  | Handle                                  | 1      |
| 3  | Hose                                    | 1      |
| 4  | Hose adapter                            | 1      |
| 5  | Front cover                             | 1      |
| 6  | Shield                                  | 1      |
| 7  | Bracket                                 | 1      |
| 8  | Electric fan                            | 1      |
| 9  | Anti-vibration pad for motors           | 1      |
| 10 | Case component                          | 1      |
| 11 | Motor stand                             | 1      |
| 12 | Electric fan                            | 1      |
| 13 | Anti-vibration pad for motors           | 1      |
| 14 | Back cover                              | 1      |
| 15 | Inner noise elimination cover           | 1      |
| 16 | Filter                                  | 1      |
| 17 | Outer noise elimination cover           | 1      |
| 18 | Screw nuts                              | 1      |
| 19 | Signal                                  | 2      |
| 20 | Power switch ( select 1 or 2 motors )   | 1      |
| 21 | Velocity adjustment knob                | 1      |
| 22 | Stages switch(speed full or adjustable) | 1      |

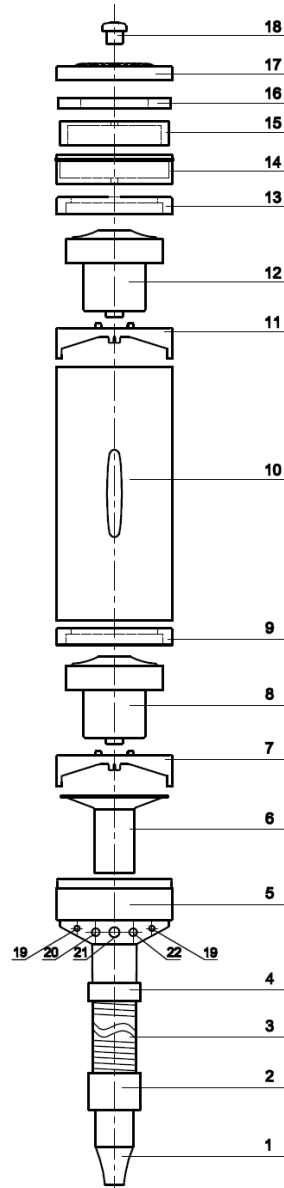

## PRODUCT FEATURES

See the label of the machine.

### FUNCTIONS & FEATURES

#### **Soft Start**

Thanks to the protection from current buffers, when the dryer starts, the dryers will not discharge any impulse current, exerting no adverse influence upon the neighboring working electrical equipment.

#### **Low Noise and Powerful Airflow**

The specially-designed noise reduction system will deliver 10%-greater airflow than any other twin-motor dryers, with over 4HP (2800watts) this model can dry your car, motorcycles, boat or ski faster in a less noise environment which will benefit the operator.

#### **Full Function**

This model is especially designed with high speed setting, which can work at full speed, as well as minimum airflow and high-heat settings, allowing precision drying and accurate wind speed when needed.

#### **BBT (Bigboi Temperature Technology)**

4 Stage adjustable warm filtered air 15c /40c higher than the surrounding environment. All this available at a touch of your fingertips.

- 1 motor- you have 2 stages where you can change the heating, please note this is done automatically on this unit. 1st stage is in full mode where the unit motor will generate the heat to a designed level. 2nd stage is in adjustment mode where you can adjust the motor speed to give you different heat settings along the way.

- 2 motors- same as the above but giving you 4 stages in total. Its not like the mini where a heating element is needed inside that you can select and increase the heat. The unit has been designed to alter its heat for ease of use depending on the stages you select.

#### **Adjustable wind control**

With the Centre piece of the control panel, showcasing the bigboi logo is the wing control nob. This will allow the user to adjust the wind speed from 30kmh to 275kmh.

#### **Extra Long**

We understand sizes matters, so at bigboi we have extended our commercial grade hose to a massive 5 meters. This will allow you to maneuver around your selected car, Motorcycles, boat or ski with ease.

#### **Accessories**

Visit **your supporting countries distributor website** to see how you can make your blower even more awesome with accessories.