

—PRINETTI®



40cm DC
PEDESTAL FAN

IA5001

INSTRUCTION MANUAL



Please read and save all instructions to ensure safe and effective use of this Appliance

Contents

Important Safety and General Instructions	03
Getting To Know Your DC Fan	05
Parts List Diagram	06
Before First Use	08
Assembly Instructions	09
Operating Instructions	12
Cleaning, Care and Maintenance	14
Warranty Information	15

PRINETTI®

02 AFTER SALES SUPPORT **AU** 📞 1300 777 137 **NZ** 📞 0800 824 556 ✉️ service@unclebills.com.au

Important Safety and General Instructions

Read this manual thoroughly before first use, even if you are familiar with this type of product. The safety precautions enclosed herein reduce the risk of fire, electric shock and injury when correctly adhered to. Please keep this user manual in a safe place along with your purchase receipt and carton for future reference. If applicable, pass these instructions and packaging on to the next owner of the appliance. Always follow basic safety precautions and accident prevention measures when using an electrical product.

1. Read all instructions before using the Prinetti® Pedestal Fan DC 40cm.
2. Close supervision is necessary when any appliance is used by or near children.
3. Do not use the Fan for other than its intended use.
4. Before turning on, ensure the electrical voltage and frequency of the circuit corresponds to those indicated on the rating label of the appliance.
5. To protect against the risk of electric shock, do not immerse the motor unit, cord set or adaptor in water or any other liquid, or rinse under a tap.
6. The Fan is not intended to be operated by means of an external timer or any type of separate remote control system.
7. The use of attachments not recommended or sold by the manufacturer may cause fire, electric shock or injury.
8. This Fan is intended to be used indoors for household use only.
9. Do not use an extension cord unless completely necessary with this product. If an extension cord is used please ensure that it has a rating equal to or exceeding the rating of this appliance.
10. Do not pull or carry by the cord, use the cord as a handle, close a door on the cord, or pull the adaptor and cord around sharp edges or corners. Keep cord away from heated surfaces.
11. Do not bend or damage the adaptor and power cord.
12. Always unplug the appliance when not in use. To disconnect from the power supply, grip the adaptor and pull from the power socket. Never pull by the cord. The adaptor plug must be removed from the power socket before cleaning, servicing, maintenance or moving the Fan.
13. Do not move or lift the Fan while the adaptor and cord is still connected to the wall outlet or still on. Always ensure it is switched off.

PRINETTI®

Important Safety and General Instructions (cont.)

14. Never force the adaptor plug into a power outlet.
15. To reduce the risk of electrocution, never operate this product with wet hands, submerge underwater or spill liquids into the product.
16. Do not leave the Fan unattended when in use.
17. Do not place the appliance near a hot gas or electric burner.
18. Do not cover the appliance whilst in use. If it is covered there is a risk of fire.
19. Improper installation may result in the risk of fire, electric shock and/or injury to persons.
20. If the supply cord or adaptor plug is damaged, do not use the appliance. Please return to your place of purchase along with your receipt for a refund or exchange.
21. The manufacturer is not responsible for any eventual damages caused by improper or faulty use.
22. The unit has no user-serviceable parts contained within. Do not attempt to repair, disassemble or modify the appliance. This will void the warranty.
23. Do not use the appliance at room temperatures above 40°C.
24. Do not leave the appliance exposed to harsh weather conditions (direct sunlight, rain, etc.).
25. Do not place the product in or near an open window as rain may enter the appliance and cause electrical short-circuiting.
26. Do not insert fingers or any other object through the front or rear grille or into any opening of the product.
27. This appliance is not intended for use by persons (including children) with reduced physical, sensory or mental capabilities or lack of experience and knowledge, unless they have been given supervision or instruction concerning use of the appliance by a person responsible for their safety.
28. Children should be supervised to ensure they do not play with the appliance.
29. Ensure the Fan is switched off and unplugged before removing the front or rear grille.

PRINETTI®

Getting To Know Your DC Fan

More Power Efficient than a Normal Fan

A typical 40cm Pedestal Fan will use up to 50 watts per hour, while a DC Fan can use as low as 3 watts per hour on the lowest setting. A DC Fan is also operated via the use of a Low Voltage AC Power Adaptor instead of using Mains Power to operate as per normal Fans. Less power used, means less energy consumed, which translates to extra money in your pocket in the end.

Quieter than a Normal Fan

Because of the brushless DC motor found in DC Fans, the DC Fan actually operates quieter than a normal AC motor Pedestal Fan.

More Environmentally Friendly than a Normal Fan

DC Fans are more power efficient, so they use less electricity consumption and leave a smaller environmental footprint than normal Fans.



PRINETTI®

AFTER SALES SUPPORT **AU** 📞 1300 777 137 **NZ** 📞 0800 824 556 ✉️ service@unclebills.com.au

05

Parts List Diagram

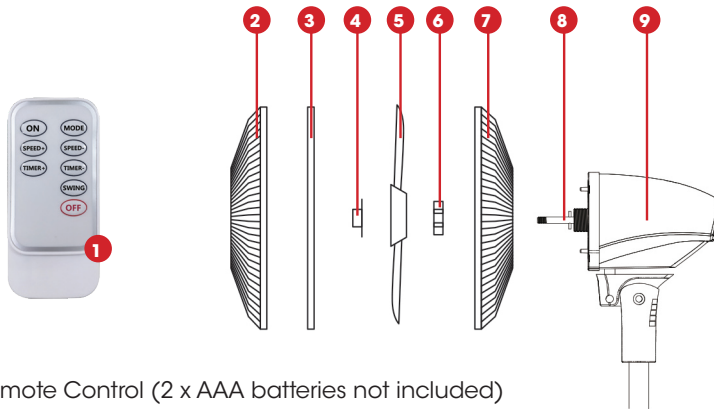

1. Remote Control (2 x AAA batteries not included)
2. Front Grille
3. Grille Ring
4. Blade Locking Cap
5. Blade
6. Grille Locking Nut
7. Rear Grille
8. Motor Shaft
9. Motor Housing
10. Height Adjustable Screw (located on the rear)
11. LED Display
12. Control Panel
13. Main Body
14. Screw
15. Extension Pole
16. Cover Tube
17. DC Socket (rear)
18. Tube Base
19. Weighted Base
20. Locking Screw

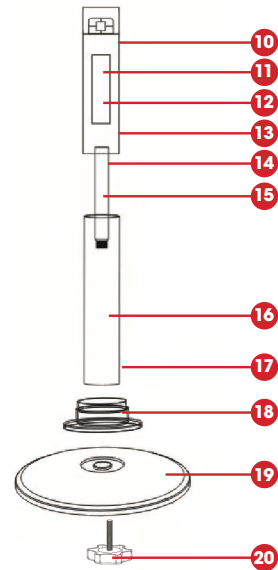

Included Not Pictured: AC Adaptor and Cord

PRINETTI®

Parts List Diagram (cont.)

Remote Control

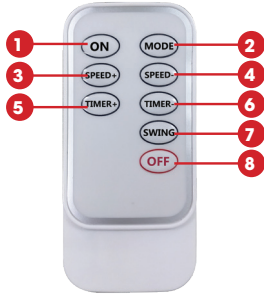

- | | |
|-------------------|-------------------|
| 1. ON Button | 5. Timer + Button |
| 2. Mode Button | 6. Timer - Button |
| 3. Speed + Button | 7. Swing Button |
| 4. Speed - Button | 8. OFF Button |

Control Panel

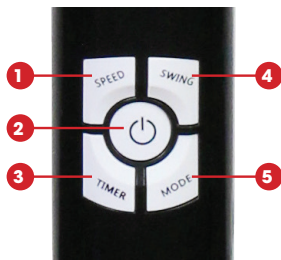

1. Speed Button
2. ON/OFF Button
3. Timer Button
4. Swing Button
5. Mode Button

Display Panel

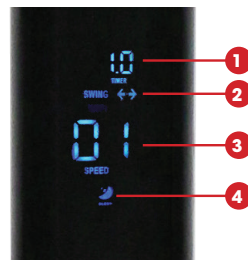

1. Timer
2. Swing Direction
3. Speed
4. Mode

PRINETTI®

Before First Use

Prior to using your Fan, please read all safety and operating instructions thoroughly. Please ensure you follow the steps below before using this Fan. We recommend you keep the original packaging for storing your Fan when not in use.

1. Unpack the product but keep all packaging material until you have made sure your new Fan is undamaged and in good working order. Ensure all parts indicated in the above parts list have been included in the gift box. Plastic wrapping can be a suffocation hazard for babies and young children, so ensure all packaging materials are kept out of reach of children.
2. Uncoil the cord and straighten it to remove any kinks. Do not use the product if any parts are damaged. In case of damage, phone the After Sales Support Line.

PRINETTI®

08 AFTER SALES SUPPORT AU 📞 1300 777 137 NZ 📞 0800 824 556 ✉️ service@unclebills.com.au

Assembly Instructions

NOTE: The Fan can be used only when completely and correctly assembled, that is complete with base, support, and protection grilles.

Using Fig. 1 below, to help you assemble the fan as follows:

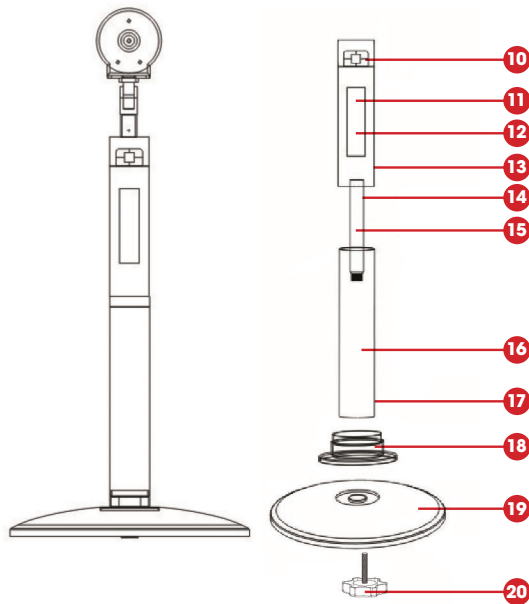

Fig. 1

1. Remove all parts of the Fan from the gift box and lay out in front of you.
2. The main body of the Fan comes pre-assembled and does not require any further assembly.
3. Loosen the screw (14) from the extension pole (15) and connect the extension pole (15) to the main body (13), and re fasten the screw (14).
4. Remove the locking screw (20) (this will be attached to the end of the tube). Turn the base over, place the silver-coloured tube base (18) on top of the weighted base (19).
5. Insert the cover tube (16) into the tube base (18) on the weighted base (19).

PRINETTI®

Assembly Instructions (cont.)

6. Attach the main body (13) with connected extension pole (15) to the weighted base (19) using the locking screw (20) at the underside of the weighted base (19), tightening it securely.
7. Tighten the height adjustment screw (10) to your desired height.

Assembling the Fan Head

Using Fig. 2 below, to help you assemble the fan head as follows:

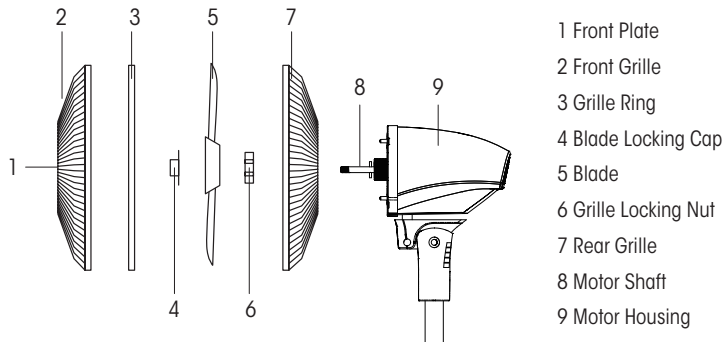

Fig. 2

1. Remove the blade locking cap (4) by turning it clockwise from the motor shaft (8). Then remove the grille locking nut (6) that is attached to the motor shaft (8) by turning it anticlockwise.
2. Insert the rear grille (7) onto the motor shaft (8) and position it so that the locator posts on the motor shaft (8) align with the alignment holes on the rear grille (7).
3. Lock the rear grille (7) into place with the grille locking nut (6) by tightening the grille locking nut (6) clockwise till the rear grille (7) sits securely against the motor shaft (8).
4. Slide the blade (5) onto the motor shaft (8), ensuring to match the flat part of the shaft with the flat part of the blade opening.
5. Tighten the blade (5) with the blade locking cap (4), turning it anticlockwise to tighten it securely.

PRINETTI®

Assembly Instructions (cont.)

6. Test the fan by rotating the blade with your hands, ensuring there is no contact with the blade locking cap. The fan blade should rotate freely.
7. The front and rear grille are held together with a grille ring (3), which has two grooves, one for each of the grilles. Slightly loosen the large screw at the bottom of the ring and ensure the edge of the grille sits in the correct groove when placing it over the rear grille.
8. Hold the front grille (2) against the rear grille (7) and ensure the edge sits securely in the correct groove of the grille ring. Retighten the screw to secure the grilles together.

PRINETTI®

Operating Instructions

Remote Control

The Fan has a remote control that allows for remote operation of the Fan functions.

When using the remote control ensure that you are in eyesight of the Fan and are pointing the remote control directly at the Fan.

NOTE: If the Fan is unresponsive, move closer to the Fan and ensure that there is nothing between the remote control and the Fan itself. If the Fan continues to be unresponsive, check and replace the batteries if required.

Inserting the Batteries (not included)

If the appliance is new or the battery in the remote control is flat, new 2 x AAA size batteries must be inserted.

1. Press the catch towards the middle of the remote and pull out the battery compartment.
2. Insert a new battery. Ensure the correct polarity (+/-) when inserting the batteries.
3. Slide the battery compartment back in again.

The remote control's buttons operate identically to those on the control panel. To select or alter any function, use the remote control as you would the control panel.

CAUTION: Dispose of all used batteries at designated disposal points. Never dispose of batteries in a fire as this may cause an explosion or leakage of dangerous chemical and fumes.

Powering the Fan ON and OFF

The following instructions are for when you are controlling the Fan by the control panel or the remote control.

1. Place the Fan on a flat, dry, stable surface. Insert the appliance plug of the AC adaptor in the DC socket at the back of the fan body. Then plug the power plug into a power outlet. All available setting options will be illuminated briefly on the LED display panel.
2. Press the ON/OFF button to switch on the Fan. When the Fan is switched on the first time, the Fan will start blowing air at the lowest fan speed (1). On subsequent uses, it will start at the previously selected fan speed.
3. Press the ON/OFF button to set the Fan to standby.

PRINETTI®

Operating Instructions (cont.)

- The Fan has 15 speed settings, 1 being lowest and 15 being highest. Press the SPEED+ button on the remote control or the SPEED- button on the remote control to increase or decrease the Fan speed, or the SPEED button on the control panel. Each time you press the button the selected speed will be shown on the LED display panel.

Mode Selection

Press the MODE button on the remote control or control panel repeatedly to get to the selection you require. This will be shown on the LED display panel.

Normal: In this mode the Fan operates at a constant speed (the mode indicator will show the fan icon on the LED display panel).

Natural: In this mode the Fan simulates a natural breeze by the cycling on and off (the mode indicator will show the palm tree icon on the LED display panel).

Sleep: In this mode the Fan simulates a soft, natural breeze suitable for night-time use (the mode indicator will show the half-moon icon on the LED display panel).

Setting the Timer

The Fan has a timer that allows the user to program the Fan for a period of time and then it will automatically turn off.

The timer can be programmed by pressing the TIMER / TIMER +/- button(s) to set the timer in 30-minute increments for up to 10hrs. The set number of hours will appear on the LED display panel. Once the programmed time has expired, the Fan will automatically turn off.

PRINETTI®

Cleaning, Care and Maintenance

Always switch off and unplug the Fan from the power outlet before moving or cleaning.

1. To clean the exterior of the Fan, wipe over the surface with a soft, damp cloth and dry thoroughly. Do not use detergents or abrasive cleaners.
2. To clean the grille and the motor air vents, use a vacuum cleaner to remove light dust.
3. If the Fan is not used for long periods (eg. over winter), it is recommended to store the Fan in its original packaging in a cool, dry place.
4. This product is permanently lubricated at the factory before shipping and will not require further lubrication for the life of the product.

NOTE: It is essential that the motor air vents be kept free from dust and lint.

CAUTION: Do not disassemble the motor housing of this Fan for cleaning of internal parts, as doing so may result in product damage and will void the warranty.

CAUTION: Do not immerse the Fan in water or any other liquids.

CAUTION: Do not apply lubricants to the Fan. Additional lubrication could increase the risk of a fire hazard.

PRINETTI®

Warranty Information

Congratulations on your purchase

This Prinetti® Pedestal Fan DC 40cm is warranted to be free from defects in material and workmanship under normal use and service conditions for a period of 12 months from the date of purchase of this article. Evidence of unfair usage or incorrect adjustment by the owner will void this promise. Defects that occur within this warranty period, under normal use and care, will be repaired, replaced or refunded at our discretion.

The benefits conferred by this manufacturer's warranty are in addition to all other rights and remedies in respect of the product which the consumer has under the Australian Consumer Law.

Our goods come with guarantees that cannot be excluded under the Australian Consumer Law. You are entitled to a replacement or refund for a major failure and for compensation for any other reasonably foreseeable loss or damage. You are also entitled to have the goods repaired or replaced if the goods fail to be of acceptable quality and the failure does not amount to a major failure.

Conditions of Warranty

All warranty coverage extends only to the original retail purchaser from the date of purchase. Please keep your receipt, tax invoice or other proof of purchase.

This warranty does not extend to any damage to a product caused by abuse, improper or abnormal usage, or repairs not provided by us or our Service Centre. Nor does this warranty extend to products used for commercial or rental purposes. This warranty does not cover ordinary wear, tear and weathering, failure to follow directions, improper installation, improper maintenance or acts of God (such as damage caused by storms, lightning, heavy winds and by snow or ice).

Making A Warranty Claim

In order to make a claim under this warranty please direct your enquiries to our Service Centre. You can contact them on 1300 777 137 or send mail to them at:

Uncle Bill's Service Centre:

2/24 Anderson Road, Smeaton Grange, NSW 2567 – if mailing please include your contact details.

A service representative will then assist you in the appropriate action to be taken. For efficient processing of your enquiry please have proof of purchase, the date of purchase and the retailer name you purchased the item from, and the brand on the product. Photos of the product, and scans of receipts, may be requested to assist with your claim.

PRINETTI®

Warranty Information (cont.)

The service centre representative will assess the claim. If:

1. There is a minor fault, they can offer either a replacement spare part, replacement unit, repair or other suitable remedy.
2. There is a major fault, they can offer a replacement, repair or suggest you return to the store you purchased it from for a full refund.

PLEASE NOTE: A request for compensation will need documentary evidence of the loss or damage suffered. It will also need to be evidenced that such a loss was a reasonably foreseeable result of a failure by Uncle Bill's to comply with a consumer guarantee under the Australian Consumer Law.

3. The product was damaged through abnormal use, no refund or repair can be offered.

If the product needs to be returned and all the warranty criteria has been met, the consumer is to return the product to the place of purchase (along with their proof of purchase) and all costs involved with this will be the responsibility of the consumer.

Our sales and service centre has been set up to provide assembly assistance, technical support, replacement parts and accessories, and to efficiently handle all warranty related matters. Please note upon receiving your warranty claim our Service Centre will send, via post or email, a repair and refurbished goods or parts notice.

If you require an alternative format of this instruction manual such as website, DVD or by email please contact service@unclebills.com.au to obtain a copy.

SERVICE CENTRE

Contact details and hours of operation:

Phone: 1300 777 137

Email: service@unclebills.com.au

9:00am – 4:30pm (AEST) Monday to Friday (excluding Public Holidays)

9:00am – 3:00pm (AEST) Saturday

This product is warranted and imported by:

Uncle Bill's (Australia) Pty Ltd
48B Egerton Street
Silverwater NSW 2128, Australia
Phone: 02 8799 3500

Item: IA5001



PRINETTI®