

NX[®] Smart Home



NX-GL4

Smart RGBW LED Garden Lights USER MANUAL

ENGINEERED FOR THE NEXT GENERATION™





CONTENTS

1.0 WARNINGS	2
2.0 INTRODUCTION	2
2.1 Pre-Installation.....	2
3.0 NX SMART APP SETUP	3
3.1 App Download.....	3
3.2 App Registration.....	4
3.3 Home Management	5
3.4 Add your Garden Lights to the App.....	7
4.0 OPERATION	10
4.1 Garden Light Colour Options	10
4.2 Smart Controller	11
4.3 Google Home Integration.....	11
4.4 Amazon Alexa Integration	13
4.5 Automation	14
4.6 Additional App Functions	15
5.0 SPECIFICATIONS	15
6.0 WARRANTY TERMS & CONDITIONS	16

1.0 WARNINGS

- Consult a licensed electrician if you are unsure of the AC connection or do not have a power point within connection range.
- Do not disassemble the Adaptor, Smart Controller or Lights.
- There are no user serviceable parts within this kit.
- Do not stare directly at the LED lights.

2.0 INTRODUCTION

Thank you for purchasing the NX-GL4 Smart RGBW LED Garden Lights. These lights can be controlled directly by the Smart Controller, via our free smartphone app and by your voice, using Amazon Alexa or Google Assistant.

2.1 PRE-INSTALLATION

1. This system works with 2.4GHz WiFi networks only.
Depending on your router model, you may need to disable 5HGz networks while connecting the Garden Lights to your WiFi network. Please see 'Quick Explainer' on page 7.
2. Insert the NX-GL4 Garden Lights power cable in to the AC adaptor and firmly tighten the locking nut.
3. Please install your NX-GL4 Garden Lights within the range of your WiFi router. To test this, pair the lights with the NX Smart App at a location close to the router. Once paired, you can test different installation locations within your WiFi range.

PLEASE NOTE:

- It may take 1-2 minutes for the lights to re-connect with the WiFi network once you have relocated them.

4. Before installing the lights in your garden, lay the cable along the ground to ensure they will reach your desired installation location. This kit includes extra-long cable lengths to ensure maximum installation flexibility.

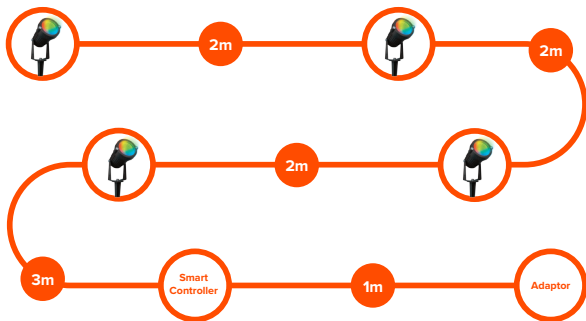

3.0 NX SMART APP SETUP

3.1 APP DOWNLOAD

Download the NX Smart app from the Apple or Google Play stores by searching '**NX Smart**' or scan the QR code below.

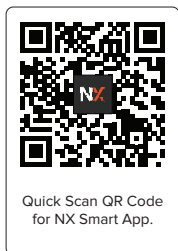

3.2 APP REGISTRATION

To register, select **'Sign Up.'** Please read and agree to the privacy policy, then enter your email address.

Select **'Get Registration Code'** then retrieve the code sent to your email. Please enter the code into the app to create your account and set your password.

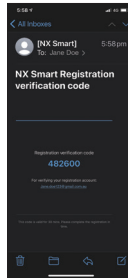
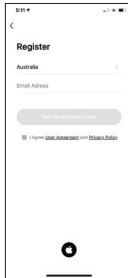

You will be asked to authorise access to several services including **'Bluetooth,' 'Notifications'** and **'Location Services.'** All of these functions enhance the operation of the app. To activate Music Mode, you'll be asked for access to your smartphone's microphone.

3.3 HOME MANAGEMENT

To enable extra NX-GL4 Garden Lights control options, like adding other users and organising your garden lights into different areas, follow the steps below (you can also set up Home Management later).

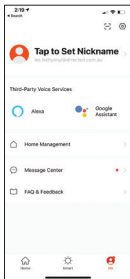
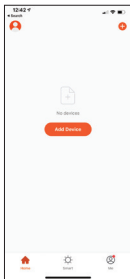

CONFIGURATION STEPS:

1. Select **'Me'** on the menu at the bottom of the screen.
2. Select **'Home Management.'**

Then select **'My Home'** to configure your default home setting.

3. Add a home name, then set **'Location'** (optional). After this step, you can add and name garden areas (the app refers to this as a 'room').

For example, **'Side Garden.'** Always select **'Save'** when you have finished making changes.

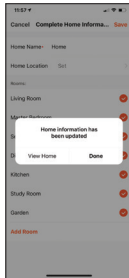
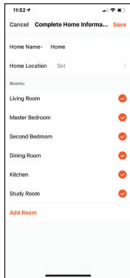

3.4 ADD YOUR GARDEN LIGHTS TO THE APP

1. Ensure your smartphone is connected to your 2.4GHz WiFi network (this is a specific home network, if you are unsure of the difference, please read the quick explainer below).
2. Power up your NX-GL4 Garden Lights. Within 3 seconds, they should start flashing red. If they don't, press and hold the button on the smart controller (figure below) for 5 seconds until they start flashing.

QUICK EXPLAINER:

- Modern home routers typically provide two WiFi networks (5GHz and 2.4GHz). These separate networks won't always be named clearly, especially if you have re-named your home WiFi network.
- For your NX-GL4 Garden Lights to work, you will need to pair them to the 2.4GHz WiFi network, which has a greater range and a stronger and more reliable signal. If you are unsure which of your WiFi networks is 2.4GHz, please clarify with your network provider.

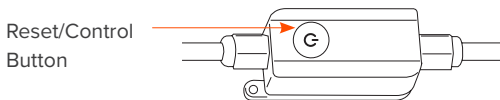

3. The NX-GL4 Garden Lights have the latest pairing technology to ensure quick and easy setup. To pair the lights to your app, please ensure that Bluetooth is enabled on your smartphone.

4. Select 'Add Device.'

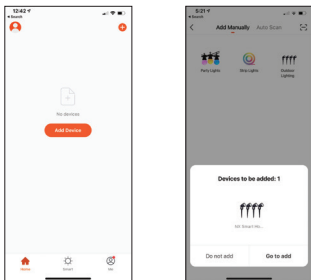

'Garden Lights' will show on the screen as the device to be added.

Select 'Go to Add' to confirm this selection.

5. On the next screen, select the '+' icon (as circled in below image) to confirm this selection.

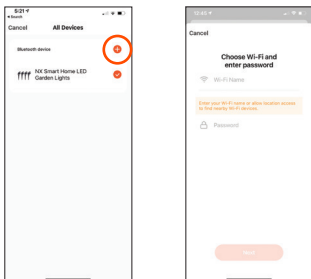

6. Your WiFi network name will be displayed. If your 2.4GHz WiFi network name is not displayed, please leave the app, connect your Smartphone to the 2.4GHz network then return to the app and enter the WiFi password and select confirm. You can also enter the network name manually if it is not displayed. Please refer to our 'Quick Explainer' on page 7 if this is not clear. If you still cannot find your 2.4GHz WiFi, please contact your internet provider.

NOTE:

- Bluetooth is only used to enable easy connection to the lights. After they are connected to WiFi, Bluetooth is not required.

7. The pairing process will start. A confirmation screen will be shown when complete. At this stage you can rename your NX-GL4 Garden Lights if you choose to. This name will be used to trigger your lights if you are using Amazon Alexa and Google Assistant. You can change the name by selecting the pen icon (circled in the image below).

You can allocate the lights to a specified living area if you have set up Home Management and easily control multiple devices and/or create smart automations.

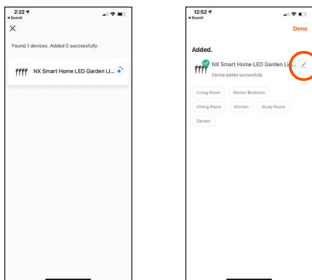

4.0 OPERATION

There are four operation modes available for the NX-GL4 Garden Lights. The ON/OFF switch for the LED's is located at the bottom centre of the operation mode screen.

4.1 GARDEN LIGHT COLOUR OPTIONS



1. **White:** The NX Smart LED Garden Lights are supplied with discreet cool white LED's to provide natural white light. As the LED's are cool white only, the white menu only allows you to adjust the brightness of the LED's.
2. **Colour:** Slide your finger around the colour wheel to select your desired colour. Brightness is adjusted by the slider. There is also a contrast slider that when adjusted to 50% and lower, allows you to select pastel colours.
3. **Scene:** There are four fixed ambient light scenes and four flash scenes available for selection. The four ambient scene settings (Warm, Cool, Sunset and Ocean) need to be set by the user first using the circled edit control.

The four flash scenes: Relax, Party, RGBFlash and Chill are preprogrammed but can also be adjusted using the edit control.

4. **Music Mode:** Uses your smartphone microphone to trigger the NX-GL4 Garden Lights. The app needs to be left open and the smartphone unlocked for this function to work.

4.2 SMART CONTROLLER

If a smartphone is unavailable, you can use the button on the smart controller to operate the lights. With each button press, the lights will turn on, then cycle through all 8 scenes and the last press will turn the lights off.

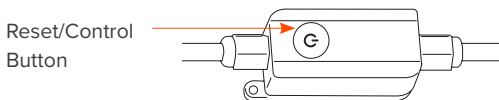

4.3 GOOGLE HOME INTEGRATION

1. Open the Google Home app, select '+', then select '**Set up device**' on the next menu, then '**Works with Google**' on the following menu.

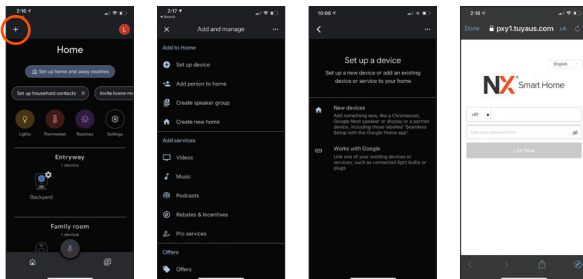

2. Then search for **'NX Smart'** and enter your NX Smart app login email and password.

3. Select **'Link Now'** to link the devices.

4. Finally, select **'NX Smart'** and then Authorise.

Google Assistant will find your device(s) and they will be displayed on the app home page.

Now you can control the Garden Lights with Google Assistant.

Just start with **'hey Google'** to use your voice to control your NX Smart Home Garden Lights.

Some example commands follow - or try your own variations!

Remember whatever you named the NX-GL4 Garden Lights as in the NX Smart App will also be their Google Assistant name.

- Ok Google, turn on Garden Lights.
- Ok Google, turn off Garden Lights.
- Ok Google, set Garden Lights brightness to 20%.
- Ok Google, set Garden Lights to blue.

4.4 AMAZON ALEXA INTEGRATION

Open your Amazon Alexa app and from the home menu, select **'More.'** Select **'Skills & Games.'** then using the search tool at the top right corner of the screen, enter **'NX Smart'** to search for the NX Smart app.

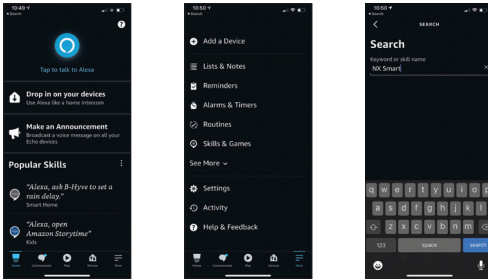

After you select **'NX Smart,'** select **'Enable to Use'** on the next screen. Then enter your NX Smart App login email address and password and select **'Authorise.'**

Once your NX Smart account is linked to Alexa, select **'Done'** on the following page then **'Discover Devices.'**

Some example commands follow - or try your own variations!
Remember whatever you named the NX-GL4 Garden Lights as in the NX App will also be their Alexa name.

- Alexa, turn on Garden Lights.
- Alexa, turn off Garden Lights.
- Alexa, make Garden Lights brightness 20%.
- Alexa, make Garden Lights to blue.

4.5 AUTOMATION

There are various ways you can enhance your smart product experience. Automation lets you control your NX-GL4 Garden Lights based on other conditions such as:

- Time
- Temperature
- The operation of another smart device

To activate the Automation function, follow these steps:

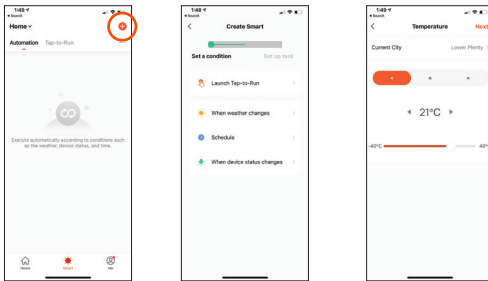

From the home screen, perform the following actions:

1. Select **'Smart'**
2. Add an Automation routine, select **'+'** (circled at the top of the screen)
3. Select an Automation action. In this example we will select **'When Weather Changes'**
4. Select a specific weather condition, so we will select **'Temperature Conditions'**
5. Select the trigger temperature then **'Next'**
6. Select the action to be performed, We will select **'run the device'** for this example
7. Select the device you want to control

8. Select the device operation. In this example we will select **'Switch'** then **'ON'** to turn the lights on

9. Select **'Save'** and select **'Next'**

You are finally presented with a summary screen of the automation actions created. To finish, select **'Save.'**

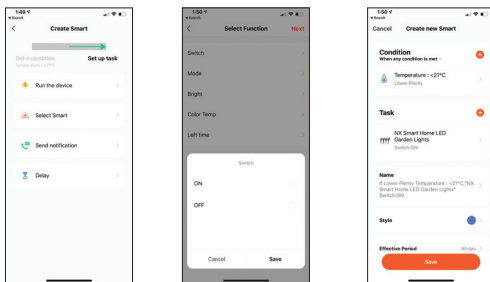

4.6 ADDITIONAL APP FUNCTIONS

Additional app functions are described in the **'FAQ & Feedback'** section, and via the **'Me'** menu in the app.

5.0 SPECIFICATIONS

Model: NX-GL4

WiFi: 2.4GHz only, IEEE802.11b/g/n

Water Resistance: Lights IP65; Adaptor IP44

App Requirements: IOS 10.0 or Android 5 and above.

Operating Voltage: 12VDC 1A

Google Play and the Google Play logo are trademarks of Google Inc. Industries.

Amazon, Alexa and all related logos are trademarks of Amazon.com, Inc. or its affiliates.

6.0 WARRANTY TERMS & CONDITIONS

Our goods come with guarantees that cannot be excluded under the Australian Consumer Law. You are entitled to a replacement or refund for a major failure and for compensation for any other reasonably foreseeable loss or damage. You are also entitled to have the goods repaired or replaced if the goods fail to be of acceptable quality and the failure does not amount to a major failure.

This warranty is provided in addition to your rights under the Australian Consumer Law. Directed Electronics Australia Pty Ltd (Directed Electronics) warrants that this product is free from defects in material and workmanship for a period of 12 months from the date of purchase or for the period stated on the packaging. This warranty is only valid where you have used the product in accordance with any recommendations or instructions provided by Directed Electronics.

This warranty excludes defects resulting from alterations of the product, accident, misuse, abuse or neglect. In order to claim the warranty, you must return the product to the retailer from which it was purchased or if that retailer is part of a National network, a store within that chain, along with satisfactory proof of purchase. The retailer will then return the goods to Directed Electronics.

Directed Electronics will repair, replace or refurbish the product at its discretion. The retailer will contact you when the product is ready for collection. All costs involved in claiming this warranty, including the cost of the retailer sending the product to Directed Electronics, will be borne by you.

Email: info@nx-tech.com.au

INDEMNITY

You agree to defend, indemnify and hold harmless NX and its subsidiaries and affiliates from and against any and all claims, proceedings, injuries, liabilities, losses, costs and expenses (including reasonable legal fees), including but not limited to, claims alleging negligence, invasion of privacy, copyright infringement and/or trademark infringement against NX and its subsidiaries and affiliates or the NX services, relating to or arising out of your breach of any provision of these terms, your misuse of the NX or NX services, or your unauthorized modification or alteration of products or software.

WARRANTY AND WARRANTY DISCLAIMER

NX has a limited warranty on whereby NX warrants to you and only to you that the NX products will be free from defects in materials and workmanship for one (1) year from the date of your purchase of the on NX products (unless a longer warranty period is required by law).

The specifics of this NX limited warranty are at <https://www.nx-tech.com.au/warranty>

To the extent possible under governing law, other than the above product warranty for the NX products you understand and agree that the NX services are provided on an "as is" and "as available" basis. NX makes no warranty that the NX services will meet your requirements or that use of the NX services will be uninterrupted, timely, secure or error-free nor does NX make any warranty as to the accuracy or reliability of any information obtained through the NX services (including third party content), that any defects in the NX services will be corrected or that the NX products or NX services will be compatible with any other specific hardware or service. Further, NX does not warrant that the NX services or the NX servers that provide you with data and content are free of viruses or other harmful components.

NX also assumes no responsibility for and shall not be liable for any damages caused by viruses that may infect your NX products, computer software, or other hardware.

NX's equipment and services do not cause and cannot eliminate occurrences of certain events, including, but not limited to, fires, floods, burglaries, robberies and medical problems. NX makes no guarantee or warranty, including any implied warranty of merchantability or fitness for a particular purpose, that the NX equipment and services provided will detect or avert such incidents or their consequences. NX does not undertake any risk that you or your vehicle or property, or the person or property of others, may be subject to injury or loss if such an event occurs. The allocation of such risk remains with you, not NX.

Other than the above product warranty for the NX products, NX and its suppliers disclaim all warranties of any kind, whether express, implied, or statutory, regarding the NX equipment and any associated app/service. Including any implied warranty of title, merchantability, fitness for a particular purpose, or noninfringement of third-party rights.

Because some jurisdictions do not permit the exclusion of implied warranties, the last sentence of this section may not apply to you. NX hereby further expressly disclaims all liability for any claims for service failures that are due to normal product wear, product misuse, abuse, product modification, improper product selection or your non-compliance with any and all applicable federal, state or local laws. This warranty and warranty disclaimer give you specific legal rights, and you may have other rights that vary by state, province, or country. Other than as permitted by law, NX does not exclude, limit or suspend other rights you have, including those that may arise from the nonconformity of a sales contract. For a full understanding of your rights you should consult the laws of your state, province, or country. For our Australian Customers: please note that this warranty is in addition to any statutory rights in Australia in relation to your goods which, pursuant to the Australian consumer Law, cannot be excluded.

LIMITATIONS OF NX LIABILITY

Under no circumstances will NX be liable in any way for any content, including, but not limited to, the loss of content, any errors or omissions in any content, or any loss or damage of any kind incurred in connection with use of or exposure to any content posted, emailed, accessed, transmitted, or otherwise made available via the NX app.

NX liability for damages, especially for breach of duty or obligation, delay in performance, non-performance, or malperformance shall be precluded, except when these are due to negligent breaches of any significant contractual duty or obligation on the part of NX. Any liability for negligence is limited to direct losses usually and typically foreseeable in such case. Should the claim for damages be based on wilful or grossly negligent breach of contractual duty or obligation on the part of NX, the preclusion and limitation of liability mentioned in the preceding sentences will not apply. The preceding preclusion and limitation of liability will also not apply to claims for damages arising out of loss of life, bodily injury, or health impacts for which NX may be liable, or for non-contractual liability.

Some states and countries do not allow the exclusion or limitation of incidental or consequential damages, so the above limitation or exclusion may not apply to you. Additionally, this provision is not intended to limit NX's liability in the event of NX's wilful or intentional misconduct.



ENGINEERED FOR THE NEXT GENERATION™

