

ALTIUS



CAR HEAD UP DISPLAY WITH WIRELESS CHARGING

ATHUDW-SCA

USER GUIDE



WELCOME

We hope you enjoy your purchase!

ALTIUS products are carefully designed and produced to the highest standards of performance and safety, backed by our comprehensive 1 Year Warranty.

This user guide will provide all the information required for you to setup and use your new product.

CONTENTS

Welcome	2
General Safety Warnings	4
Product Overview	6
Operation	8
Troubleshooting	10
Specifications	11
Compliance and Responsible Disposal	12



GENERAL SAFETY WARNINGS



This product complies with Australian Safety Standard AS/NZS 62368.1 to ensure the safety of the product.

Plastic wrapping can be a suffocation hazard for babies and young children, so ensure all packaging materials are out of their reach.

To prevent environmental factors (dampness, dust, food, liquid etc.) harming the product, only use it in a well-ventilated, clean and dry environment, away from excessive heat or moisture.

Keep the product away from direct sunlight or heat sources.

In case of damage, do not disassemble, repair or modify the product yourself. Contact After Sales Support for advice on repair or replacement, or refer servicing to qualified personnel only.

Children should be supervised to ensure they do not play with the product.

Do not place or store appliance where it can fall or be pulled into a bath or sink.

This product is not intended for use by persons (including children) with reduced physical, sensory or mental capabilities, or lack of experience and knowledge, unless they have been given supervision or instruction concerning use of the product by a person responsible for their safety.

Do not expose the product to microwaves.

Clean using a dry cloth only - do not use water or chemicals.

Keep the product away from oils, chemicals or any other organic liquids.

Use this appliance only for its intended purpose as described in this guide.



CAUTION

Do not adjust the head up display whilst driving.

PRODUCT OVERVIEW

What's in the box:

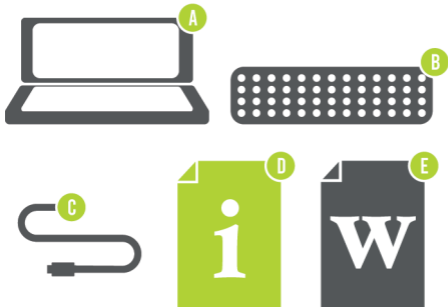

A. Car Head Up Display

B. Anti Slip Base

C. Micro USB Cable

D. User Guide

E. Warranty Certificate

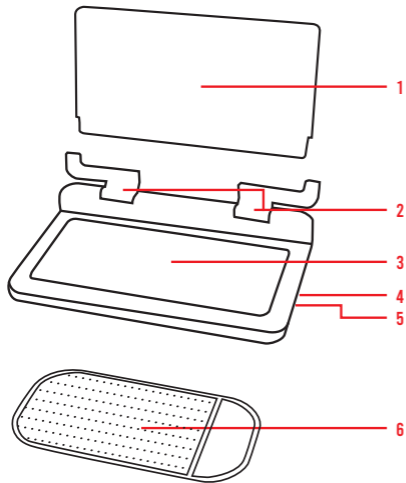

1. Reflective display lens

2. Adjustable hinges

3. Wireless charging anti slip pad

4. Micro USB port

5. LED indicator

6. Anti slip base

OPERATION

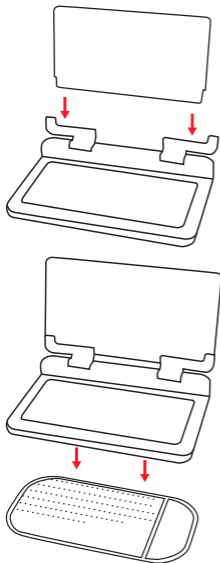

1. Remove the protective films off the reflective display lens, ensuring that the side with the blue film is facing towards you.
2. Insert the reflective display lens onto the hinges, ensuring the side with the blue film is facing inside and the side with the clear film is behind.
3. Remove the protective film off the anti slip base and place onto desired location on car.
4. Place the head up display on top of the anti slip base.
5. Turn on your desired Head Up Display app (or download on the App/ Google Play store if you don't already have one) and place onto the wireless charging anti slip pad.
6. Your smartphones display screen can now be viewed through the reflective display lens.

The head up display can also wireless charge your smartphone.

1. Connect the supplied micro USB cable to the micro USB port on the unit. Connect to your car's cigarette lighter socket using an adaptor (not included).
2. Place your smartphone facing up on the wireless charging anti slip pad.
3. When the smartphone is charging, the colour of the LED indicator reflects the charging status:
Red - Ready to charge
Blue - Charging
Red (flashing) - Error. Metal or other object on the pad or smart phone does not support wireless charging.
4. If it doesn't start charging, try adjusting the position and/or remove your smart phone case.



Your smartphone must support wireless charging for this function to work.

TROUBLESHOOTING

PROBLEM	SOLUTION
Wireless charging not working	<ul style="list-style-type: none">• Check that your smart phone supports wireless charging• Adjust the position of the smart phone to the centre of the wireless charging/anti slip pad.• Remove the smart phone case.• Check and remove any metal or other objects between the mobile phone and wireless charging/anti slip pad.• Make sure you are connected to a power source.
Entire smartphone screen not being reflected	<ul style="list-style-type: none">• Adjust the hinges of the product until the full display can be seen.

SPECIFICATIONS

Power input	5VDC 2A
Wireless charging power output	5W
Dimensions	150 x 95 x 24 mm
Weight	156 g

COMPLIANCE AND RESPONSIBLE DISPOSAL

Packaging

The packaging of your product has been selected from environmentally friendly materials and can usually be recycled. Please ensure these are disposed of correctly. Plastic wrapping can be a suffocation hazard for babies and young children, please ensure all packaging materials are out of reach and are safely disposed of. Please recycle these materials rather than throwing them away.

Product

At the end of its working life, do not throw this product out with your household rubbish. An environmentally friendly method of disposal will ensure that valuable raw materials can be recycled. Electrical and electronic items contain materials and substances which, if handled or disposed of incorrectly, could potentially be hazardous to the environment and human health.

This product complies with the Australian Safety Standard AS/NZS 62368.1 to ensure the safety of the product.

NOTES

NOTES

NOTES

ALTIUS

**CUSTOMER HELPLINE AU:
1300 886 649**

**DISTRIBUTED BY:
TEMPO (AUST) PTY LTD,
PO BOX 6056,
FRENCHS FOREST
DC 2086**