

FITTING INSTRUCTIONS FOR RYCO CABIN FILTER RCA252M. MITSUBISHI Pajero NM, NP, NT, NS, NW & NX

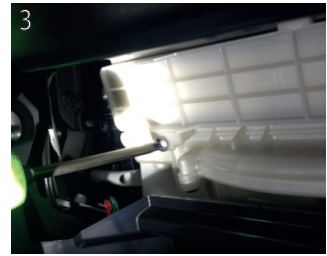

1. The Cabin air filter housing is located behind the glovebox unit on the passenger side. Open the glovebox and disengage the retaining lugs from each side of the unit by compressing the top sides towards the inside. Drop the unit gently pushing until supporting strut is visible. Disengage the strut by unclipping it from the lug and drop down the glovebox compartment. Refer to pic 1.

2. The white plastic area visible in pic 2 is the cabin air filter housing. Remove the screws securing the lid (refer to pic 3) and pull the lid out. Note that the lid is part of the filter so be gentle when pulling out to avoid accumulated debris from being spreading around.

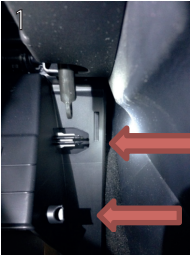
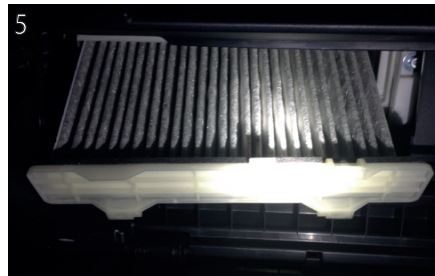
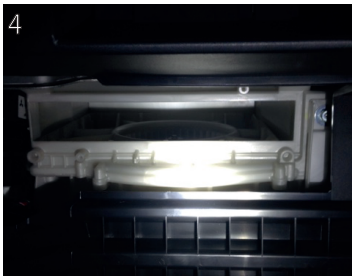

3. Once the filter has been removed proceed to clean the housing of any loose dirt and slide in the new cabin air filter element (refer to pic 5). Screw the lid back on and refit all remaining components in reverse order.

RYCO Group Pty Ltd
29 Taras Ave Altona
North Victoria 3025
Australia
www.rycofilters.com.au

**RYCO Group- A division of
GUD (NZ) Holdings Limited.**
19 Bell Avenue, Otahuhu,
Auckland 1060, New Zealand
www.ryco.co.nz