

TOOLPRO

1/2" Impact Wrench

Instruction Manual

PLU 573296



ToolPRO

Important - Please read these instructions fully before operating or maintaining your Brushless Impact wrench

These instructions contain important information that will help you get the best from your Brushless Impact wrench, ensuring it remains safe to operate.

Safety Information

Important - Please read these instructions fully before starting assembly

Warning Symbols



Read the instruction manual.



Wear safety glasses.



Wear ear protection.



Wear protective gloves.



Long and loose hair must be contained or securely tied back.



Do not abandon into the environment.



Keep out of the reach of children.



Warning!



Warning! Risk of crushing.



Direction of rotation



Class II construction(Double insulated).



WEEE-
Waste Electrical & Electronic
Equipment.
Do not dispose of waste of Waste
Electrical & Electronic Equipment
in with domestic rubbish.



Lithium-ion product.



Do not incinerate or throw into
fire.



For indoor use only.
Do not expose to rain.



Fuse.



Polarity indication.



Rated voltage.



RCM marking.

Safety Information

Important - Please read these instructions fully before starting assembly

General Safety Warnings



WARNING: Read all safety warnings and all instructions. Failure to follow the warnings and instructions may result in electric shock, fire and/or serious injury. **Save all warnings and instructions for future reference.**

- This appliance is not intended for use by persons (including children) with reduced physical, sensory or mental capabilities, or lack of experience and knowledge, unless they have been given supervision or instruction concerning use of the appliance by a person responsible for their safety.

- Children should be supervised to ensure that they do not play with the appliance. If the supply cord is damaged, it must be replaced by the manufacturer, its service agent or similarly qualified persons in order to avoid a hazard or serious injury.

General Power Tool Safety Warnings



WARNING! Read all safety warnings and all instructions. Failure to follow the warnings and instructions may result in electric shock, fire and/or serious injury. **Save all warnings and instructions for future reference.**

The term "power tool" in the warnings refers to your mains-operated (corded) power tool or battery-operated (cordless) power tool.

1) Work area safety

- a) Keep work area clean and well lit.** Cluttered or dark areas invite accidents.
- b) Do not operate power tools in explosive atmospheres, such as in the presence of flammable liquids, gases or dust.** Power tools create sparks which may ignite the dust or fumes.
- c) Keep children and bystanders away while operating a power tool.** Distractions can cause you to lose control.

2) Electrical safety

- a) Power tool plugs must match the outlet. Never modify the plug in any way. Do not use any adapter plugs with earthed (grounded) power tools.** Unmodified plugs and matching outlets will reduce risk of electric shock.
- b) Avoid body contact with earthed or grounded surfaces, such as pipes, radiators, ranges and refrigerators.** There is an increased risk of electric shock if your body is earthed or grounded.
- c) Do not expose power tools to rain or wet conditions.** Water entering a power tool will increase the risk of electric shock.

Safety Information

Important - Please read these instructions fully before starting assembly

General Power Tool Safety Warnings

- d) Do not abuse the cord. Never use the cord for carrying, pulling or unplugging the power tool. Keep cord away from heat, oil, sharp edges or moving parts.** Damaged or entangled cords increase the risk of electric shock.
- e) When operating a power tool outdoors, use an extension cord suitable for outdoor use.** Use of a cord suitable for outdoor use reduces the risk of electric shock.
- f) If operating a power tool in a damp location is unavoidable, use a residual current device (RCD) protected supply.** Use of an RCD reduces the risk of electric shock.

3) Personal safety

- a) Stay alert, watch what you are doing and use common sense when operating a power tool. Do not use a power tool while you are tired or under the influence of drugs, alcohol or medication.** A moment of inattention while operating power tools may result in serious personal injury.
- b) Use personal protective equipment. Always wear eye protection.** Protective equipment such as dust mask, non-skid safety shoes, hard hat, or hearing protection used for appropriate conditions will reduce personal injuries.
- c) Prevent unintentional starting. Ensure the switch is in the off-position before connecting to power source and/or battery pack, picking up or carrying the tool.** Carrying power tools with your finger on the switch or energising power tools that have the switch on invites accidents.
- d) Remove any adjusting key or wrench before turning the power tool on.** A wrench or a key left attached to a rotating part of the power tool may result in personal injury.
- e) Do not overreach. Keep proper footing and balance at all times.** This enables better control of the power tool in unexpected situations.
- f) Dress properly. Do not wear loose clothing or jewellery. Keep your hair, clothing and gloves away from moving parts.** Loose clothes, jewellery or long hair can be caught in moving parts.
- g) If devices are provided for the connection of dust extraction and collection facilities, ensure these are connected and properly used.** Use of dust collection can reduce dust-related hazards.

4) Power tool use and care

- a) Do not force the power tool. Use the correct power tool for your application.** The correct power tool will do the job better and safer at the rate for which it was designed.
- b) Do not use the power tool if the switch does not turn it on and off.** Any power tool that cannot be controlled with the switch is dangerous and must not be used.
- c) Disconnect the plug from the power source and/or the battery pack from the power tool before making any adjustments, changing accessories, or storing power tools.** Such preventive safety measures reduce the risk of starting the power tool accidentally.
- d) Store idle power tools out of the reach of children and do not allow persons unfamiliar with the power tool or these instructions to operate the power tool.** Power tools are dangerous in the hands of untrained users.

Safety Information

Important - Please read these instructions fully before starting assembly

General Power Tool Safety Warnings

- e) **Maintain power tools.** Check for misalignment or binding of moving parts, breakage of parts and any other condition that may affect the power tool's operation. If damaged, have the power tool repaired before use. Many accidents are caused by poorly maintained power tools.
- f) **Keep cutting tools sharp and clean.** Properly maintained cutting tools with sharp cutting edges are less likely to bind and are easier to control.
- g) **Use the power tool, accessories and tool bits etc. in accordance with these instructions, taking into account the working conditions and the work to be performed.** Use of the power tool for operations different from those intended could result in a hazardous situation.

5) Battery tool use and care

- a) **Recharge only with the charger specified by the manufacturer.** A charger that is suitable for one type of battery pack may create a risk of fire when used with another battery pack.
- b) **Use power tools only with specifically designated battery packs.** Use of any other battery packs may create a risk of injury and fire.
- c) **When battery pack is not in use, keep it away from other metal objects, like paper clips, coins, keys, nails, screws or other small metal objects, that can make a connection from one terminal to another.** Shorting the battery terminals together may cause burns or a fire.
- d) **Under abusive conditions, liquid may be ejected from the battery; avoid contact.** If contact accidentally occurs, flush with water. If liquid contacts eyes, additionally seek medical help. Liquid ejected from the battery may cause irritation or burns.

6) Service

Have your power tool serviced by a qualified repair person using only identical replacement parts. This will ensure that the safety of the power tool is maintained.

Safety Information

Impact Wrench Safety Warnings

Important: Super Cheap Auto recommends that this machine should not be modified or used for any application other than that for which it was designed. If you are unsure of its relative applications do not hesitate to contact us in writing and we will advise you.

- Power tools shall not be used in potentially explosive atmospheres unless specifically designed for that purpose.
- Unexpected tool movement due to reaction forces or breakage of inserted tool or reaction bar may cause injuries.
- Power tools shall be isolated from the energy source before changing or adjusting the inserted tool.

Warning!

- There is a risk of crushing by torque between you and the workpiece.
- There is a risk of loose clothing, hair etc., being caught in the rotating spindle of the power tool.
- There is a risk of being injured if hands are not kept away from the moving parts, specially observed when unscrewing in confined work spaces.
- There is a risk of being injured if hands are not kept away from the impact socket.
- There is a risk of danger to persons from high speed splinters being emitted from impact wrenches in the case of socket failure. Only use properly hardened impact sockets with this machine.
- Use only sockets and adaptors which are in good condition and are intended for use with impact wrenches.
- Adopt a suitable posture to counteract normal or unexpected movement of the power tool due to reaction forces from the power assembly tool.
- Impact wrenches are not torque wrenches and are not designed or capable of installing fasteners to a specified torque. For fasteners requiring a specific torque, install the fastener to well below the required value then complete the task with a hand torque wrench to avoid damaging the fastener or workpiece.
- Ensure the anvil ring is correctly maintained and if damaged or missing, is replaced immediately before work commences. Missing or damaged anvil rings may lead to sockets detaching from the wrench while rotating at high speed.
- Only use accessories specifically hardened for impact use. Do not use standard chrome type hand tool sockets as they will shatter and splinter causing injury.
- Do not modify this impact wrench in any way.
- When starting or finishing the removal and installation of fasteners there is a risk of crushing between the tool and the workpiece due to sudden movement or reaction forces.

Safety Information

Safety Warnings For Battery Pack

- a) **Do not dismantle, open or shred cells or battery pack.**
- b) **Do not short-circuit a battery pack. Do not store battery packs haphazardly in a box or drawer where they may short-circuit each other or be short-circuited by conductive materials.** When battery pack is not in use, keep it away from other metal objects, like paper clips, coins, keys, nails, screws or other small metal objects, that can make a connection from one terminal to another. Shorting the battery terminals together may cause burns or a fire.
- c) **Do not expose battery pack to heat or fire. Avoid storage in direct sunlight.**
- d) **Do not subject battery pack to mechanical shock.**
- e) **In the event of battery leaking, do not allow the liquid to come into contact with the skin or eyes.** If contact has been made, wash the affected area with copious amounts of water and seek medical advice.
- f) **Seek medical advice immediately if a cell or battery pack has been swallowed.**
- g) **Keep battery pack clean and dry.**
- h) **Wipe the battery pack terminals with a clean dry cloth if they become dirty.**
- i) **Battery pack needs to be charged before use. Always refer to this instruction and use the correct charging procedure.**
- j) **Do not maintain battery pack on charge when not in use.**
- k) **After extended periods of storage, it may be necessary to charge and discharge the battery pack several times to obtain maximum performance.**
- l) **Battery pack gives its best performance when it is operated at normal room temperature (20 °C ± 5 °C).**
- m) **When disposing of battery packs, keep battery packs of different electrochemical systems separate from each other.**
- n) **Recharge only with the charger specified by manufacturer.** Do not use any charger other than that specifically provided for use with the equipment. A charger that is suitable for one type of battery pack may create a risk of fire when used with another battery pack.
- o) **Do not use any battery pack which is not designed for use with the equipment.**
- p) **Keep battery pack out of the reach of children.**
- q) **Retain the original product literature for future reference.**
- r) **Remove the battery from the equipment when not in use.**
- s) **Dispose of properly.**

Safety Information

Additional Safety instructions For Your Battery Charger

1. Before charging, read the instructions.
2. For charging Li-ion battery pack only.
3. If the supply cord is damaged, it must be replaced by the manufacturer, its service agent or similarly qualified persons in order to avoid a hazard.
4. The battery terminal not connected to the chassis has to be connected first. The other connection is to be made to the chassis, remote from the battery and fuel line. The battery charger is then to be connected to the supply mains.
5. After charging, disconnect the battery charger from the supply mains. Then remove the chassis connection and then the battery connection.
6. Do not charge a leaking battery.
7. Do not use chargers for works other than those for which they are designed.
8. Before charging, ensure your charger is matching the local AC supply.
9. The charging device must be protected from moisture.
10. Do not use the charging device in the open.
11. Do not short out the contacts of battery or charger.
12. Respect the polarity "+/-" when charging.
13. Do not open the unit and keep out of the reach of children.
14. Ensure that the connection between the battery charger and battery is correctly positioned and is not obstructed by foreign bodies.
15. Keep battery charger's slots free of foreign objects and protect against dirt and humidity. Store in a dry and frost-free place.
16. When charging batteries, ensure that the battery charger is in a well-ventilated area and away from inflammable materials. Batteries can get hot during charging. Do not overcharge any batteries. Ensure that batteries and chargers are not left unsupervised during charging.
17. Do not recharge non-rechargeable batteries.
18. Longer life and better performance can be obtained if the battery pack is charged when the air temperature is between 18°C and 24°C. Do not charge the battery pack in air temperatures below 4.5°C, or above 40.5°C. This is important as it can prevent serious damage to the battery pack.
19. Charge only battery pack of the same model provided by manufacturer and of models recommended by manufacturer.

In The Box

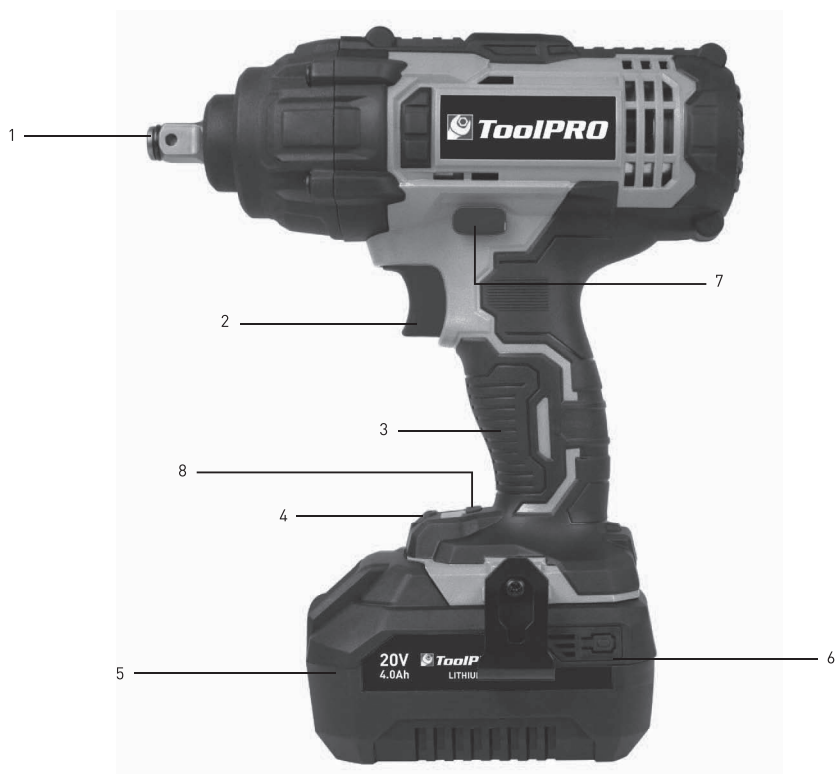

- ① 1/2" square drive with anvil ring
- ② Variable speed trigger switch
- ③ Rubber hand grip
- ④ LED Worklight
- ⑤ 4.0 Ah battery pack
- ⑥ Belt clip
- ⑦ Forward, Reverse Rotation And Lock control
- ⑧ Variable torque selector

Accessories

4.0 Ah battery pack	1
3.5A fast charger	1
Belt clip	1

Operating Instructions

Intended Use

This tool is intended for the fastening and loosening of bolts, nuts and various threaded fasteners.

This tool is not intended for use as a drill, Please check manually to ensure safety after fastening, and we recommend tightening to manufactures specifications.

1. CHARGING

Recharge only with the charger specified by the manufacturer. **A charger that is suitable for one type of battery pack may create a risk of fire when used with another battery pack.**

b) Use power tools only with specifically designated battery packs. **Use of any other battery packs may create a risk of injury and fire.**

BEFORE PUTTING INTO OPERATION

CHARGING THE BATTERY PACK

NOTE:

- a) **The battery in your new tool is not charged when it leaves the plant. Therefore it must be fully charged before using the first time.**
- b) Do not use any charger other than that specifically provided for use with the equipment.
- c) If the battery pack is very hot you must remove your battery pack from the charger and allow time for the battery to cool down before recharging.
- d) Please charge the battery to reach full or no less than half charge before storage. If the tool will not be used for long periods of time, charge the battery every 3-6 months.

Operating Instructions

Charging procedure:

To charge the battery pack{5}, it must first be removed from the tool.

To release the battery pack:

- 1) Press the battery pack release button{5.1} and gently slide the battery the pack off(Fig.1).
- 2) Plug the battery charger unit{9} into a 240V socket. The green LED{9.1} will illuminate to show the charger has power.
- 3) Slide the battery pack into place ensuring the battery terminals and the charger terminals make a good connection(Fig.2). After a few seconds delay the red LED{9.2} will light to show the battery pack is being charged and the green LED will go out.
- 4) When the battery pack is fully charged, the green LED {9.1} will light.
- 5) Disconnect battery charger from the power supply.

Caution: Do not pull the plug out of the power supply by pulling on the cord.

- Make sure to grasp the plug when removing from power supply to avoid damaging the cord.
- If the indicator lights fail to illuminate during the charging cycle, unplug the charger from the power supply socket outlet and replace the battery pack.



FIG.1



FIG.2



Operating Instructions

- 6) Remove the battery pack from the battery charger.
- Supporting the battery charger with hand, pull out the battery pack from the battery charger.
 - Make sure to grasp the plug when removing from power supply to avoid damaging the cord.

Caution: When the battery charger has been continuously used, the battery charger will be hot. Once the charging has been completed, give 15 minutes rest until the next charge. If the battery pack is charged when it is warm due to battery use or exposure to sunlight, the battery pack will not be recharged. In such a case, let the battery pack cool before charge.

If the red indicator flickers rapidly at 0.2 - second intervals, turn off from power supply and check for and take out any foreign objects in the charger's battery slot. If there are no foreign objects, it is probable that the battery pack or charger is malfunctioning. Allow battery/charger to normalise and try again. If a fault remains after trying this then contact SuperCheap Auto.

Battery pack charge status(Fig.3)

To display the amount of charge left in the battery pack press the charge level indicator button{5.2}.

Battery pack efficiency and charging advice

- Recharge the battery packs before they become completely exhausted.
- When you feel that the power of the tool becomes weaker, stop using the tool and recharge the battery pack. If you continue to use the tool and exhaust the electric current, the battery pack may become damaged.
- Avoid recharging at high temperatures. A rechargeable battery pack will be hot immediately after use. If such a battery pack is recharged immediately after use, its internal chemical substance will deteriorate and the battery life will be shortened. Leave the battery pack and recharge it after it has cooled for a while.
- The battery pack should only be used and/or charged when battery pack temperature is between 5°C and 30°C.
- The battery pack needs to be warmed-up or cooled down in order to prevent damage to the batteries internal components.

Note: Failure to warm up or cool down a battery pack could result in serious damage to the battey, charger and user.

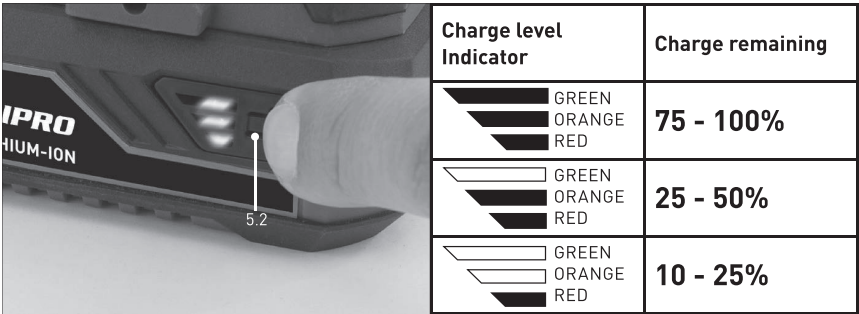

FIG.3

Operating

1. INSTALLING AND REMOVING SOCKETS - FIG.4

This wrench is supplied with a 1/2" Square Drive{1}.

Caution: This product is equipped with an electric brake. Never use any sockets or accessories that are not hardened for impact use.

Never use standard chrome vanadium steel sockets which can shatter and can cause personal injury.

To fit a socket:

- Push fit the socket over the anvil. The friction based ring holds the socket securely in place.

To remove a socket:

- Pull the socket away from the anvil to remove.

Note: Extra effort may be required when fitting and removing brand new sockets on their initial useage.

2. ROTATIONAL DRIVE SELECTION - FIG.5

The forward/reverse drive selector switch{7} determines the direction of rotation of the drive, i.e. clockwise or anticlockwise.

To alter the direction of rotation:

- Stop the machine and push switch{7} to the left or right.
- When the switch is pushed to the left, the drive will rotate clockwise.
- When the switch is pushed to the right, the drive will rotate anticlockwise.
- Before operation, check that the switch is set in the required position. Do not change the direction of rotation until the wrench comes to a complete stop.
- When the wrench is not in use move the direction switch to the middle setting to lock the trigger out.

Note: Failure to use the neutral position may activate the trigger inadvertently. This inadvertent operation may cause the wrench to become damaged.

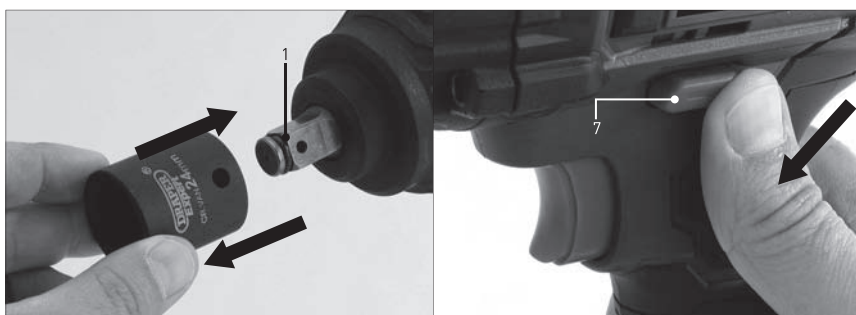

FIG.4

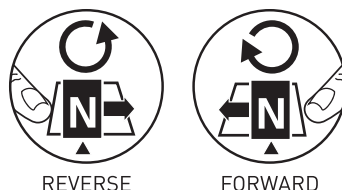

FIG.5

Operating

3. VARIABLE SPEED TRIGGER - FIG.6

When the trigger{2} is depressed, the drive will rotate provided the direction switch{7} is set in the forward or reverse position. This trigger switch is electronic which enables the user to vary the speed continuously.

- The speed varies according to how far the trigger switch is depressed.
- The further it is depressed, the faster the drive spindle will rotate.
- The lighter it is depressed, the slower it will rotate.

Note: If the fastening is heavily corroded, or extremely tight, it may be necessary to release the fixing by hand before continuing with the wrench.

Note: Always tighten fixings to the correct torque as indicated by the manufacturer using a calibrated torque wrench. Failure to do so may result in the fixing becoming damaged or insufficiently tightened.

Note: This product is equipped with an electric brake.

4. BELT CLIP- FIG.7

The spring steel belt clip{6} is convenient for hanging the drill temporarily. The clip can be installed on either side of the tool.

To install the clip:

- Locate the clip{6} in position and fasten with screw{6.1} supplied, take care to not overtighten and strip the thread.

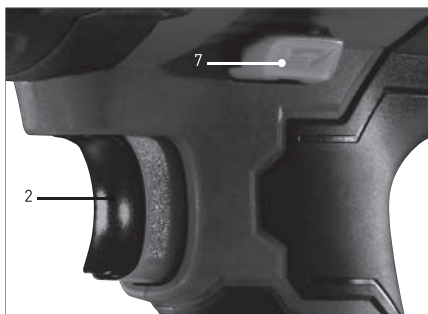

FIG.6

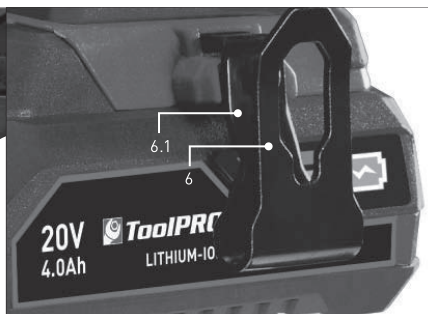

FIG.7

5. LED WORKLIGHT - FIG.8

To aid use in confined and inadequately lit spaces the LED worklight{4} automatically illuminates when the trigger is activated.

Operating

6. VARIABLE TORQUE SELECTOR - FIG.9

The engine has an electronic clutch with five different speed settings, the speed setting is adjusted by pressing the selector button(8).

Once turn on the machine, the green LED on the right side will display means the machine is set to the 5th speed.

Press the button(8) to go through the five speed settings and select the correct application.

Speed	No Load Speed (RPM min ⁻¹)	Impact rate (IPM min ⁻¹)	Torque (Nm)
1st speed	0-1500	0-2000	100
2nd speed	0-1700	0-2350	150
3rd speed	0-1900	0-2640	200
4th speed	0-2000	0-2780	300
5th speed	0-2300	0-3200	400

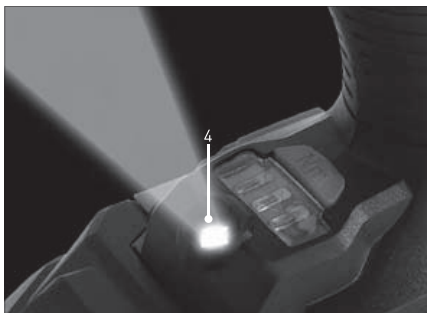

FIG.8



FIG.9

7. OPERATION

Proper fastening torque is determined by the kind of fastening, the size of the fastening or the material or workpiece.

- It is advisable to perform a test operation to determine the proper fastening time for the fastening you are using.
- Hold the wrench in straight alignment to the fastening.
- Depress the wrench and use for the required amount of time.
- After fastening, always check the torque with an appropriate torque wrench.

Note: Do not use this tool to install wheel nuts on wheels without a torque limiting device. Doing so could result in galled or broken nuts.

Note: Using a universal joint or extension bar may reduce the fastening force of the impact wrench and require longer fastening time.

Note: Using an impact wrench creates heat. The metal housing at the front of the wrench will become hot. In certain circumstances, the force required to tighten or remove fixings may cause the fixings themselves to become very hot! Wear suitable gloves to prevent burns.

Maintenance

Regular inspection and cleaning reduces the necessity for maintenance operations and will keep your tool in good working condition.
The motor must be correctly ventilated during tool operation. Avoid blocking the air inlets and vacuum the ventilation slots regularly.



POSSIBLE PROBLEM AND SOLUTION

Note: Remove the battery pack before carrying out adjustment, servicing or maintenance.

Problems	Possible cause	Required action
Motor does not start	<ul style="list-style-type: none">- Battery pack has no charge.- Battery faulty or damaged.	<ul style="list-style-type: none">- Re-charge battery.- Replace battery.
Motor runs, but slow/ losing power.	<ul style="list-style-type: none">- Battery pack has no charge.- Battery pack faulty or damaged.	<ul style="list-style-type: none">- Re-charge battery.- Replace battery.
Battery pack doesn't charge/ non-illumination / non illumination of charger.	<ul style="list-style-type: none">- Fuse blown in charger plug.- Charger faulty.	<ul style="list-style-type: none">- Replace fuse.- Replace charger.

Technical Data

Technical Data Table

Voltage	20 V 
No load speed	0-1500RPM/0-1700RPM/0-1900RPM/0-2000RPM/0-2300RPM
Impact rate	0-2000BPM/0-2350BPM/0-2640BPM/0-2780BPM/0-3200BPM
Max torque	400NM
Chuck Size	1/2"
Machine weight	2.5kg (Including battery)
Charger Protection class	 /II
Charging time	75minutes
Charger Input	230-240V-50/60Hz 85W
Charger Output	21.5V  3.5A
Battery capacity	4.0Ah Li-ion battery

Staple your purchase receipt here
Before returning this product for
warranty or any other reason, please call.
Manufactured and packaged for
SRGS PTY LTD, ABN 23 113 230 050
751 Gympie Road, Lawnton
Queensland 4501, Australia

WARRANTY

This product is guaranteed against defects a period of (3 years) from date of purchase. This warranty is provided by SRGS PTY LTD ABN 23 113 230 050 of 751 Gympie Rd Lawnton QLD 4501 Ph (07) 3482 7500. Supercheap Auto will offer a repair, replacement product or store credit if the product is assessed as being defective during the warranty period.

To claim under this warranty, take this product to the Front Service Desk of your nearest Supercheap Auto store. For store locations, visit www.supercheapauto.com.au (AUS) or www.supercheapauto.co.nz (NZ). You will need your receipt or proof of purchase. Additional information may be requested of you to process your claim. Should you not be able to provide proof of purchase with a receipt or a bank statement, identification showing your name, address and signature may be required to process your claim.

This product may need to be sent to the manufacturer to assess the defect before determining any claim. Faults or defects caused by product modification, misuse and abuse, normal wear and tear or failure to follow user instructions are not covered under this warranty.

Our goods come with guarantees that cannot be excluded under the Australian Consumer Law. You are entitled to a replacement or refund for a major failure and for compensation for any other reasonably foreseeable loss or damage. You are also entitled to have the goods repaired or replaced if the goods fail to be of acceptable quality and the failure does not amount to a major failure.

Any expenses incurred relating to the return of this product to store will normally have to be paid by you. For more information contact your nearest Supercheap Auto store.

The benefits to the consumer given by this warranty are in addition to other rights and remedies of the Australian Consumer Law in relation to the goods and services to which this warranty relates.

