

# TOOLPRO

## 18V Multi- Function Tool

Instruction Manual

CMT18WD.9

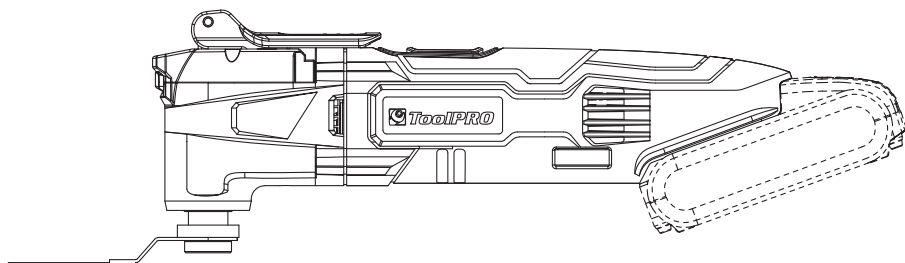

# ToolPRO

### After Sales Support

FREE CALL 1300 889 028  
EMAIL: [salesau@positecgroup.com](mailto:salesau@positecgroup.com)

**Important** - Please read these instructions fully before operating or maintaining your Oscillation Tool

These instructions contain important information that will help you get the best from your Oscillation Tool, ensuring it remains safe to operate.

If you need help or have damaged or missing parts, call the Customer Helpline on 1300889028

# Contents

<b>Safety Information</b> .....	<b>03</b>
<b>InTheBox</b> .....	<b>08</b>
<b>Accessories</b> .....	<b>08</b>
<b>Operating Instructions</b> .....	<b>09</b>
<b>Working hints for your Sander</b> .....	<b>14</b>
<b>Maintenance</b> .....	<b>14</b>
<b>Technical Data</b> .....	<b>15</b>

# Safety Information

**Important** - Please read these instructions fully before starting assembly

## Warning Symbols



To reduce the risk of injury, Please read the instruction manual



Warning



Wear ear protection



Wear eye protection



Wear dust mask



Indoor use only



Batteries may enter water cycle if disposed improperly, which can be hazardous for ecosystem. Do not dispose of waste batteries as unsorted municipal waste.



Do not burn



Waste electrical products must not be disposed of with household waste. Please recycle where facilities exist. Check with your local authorities or retailer for recycling advice.



**Li-Ion**



**Li-Ion**

Li-ion battery. This product has been marked with a symbol relating to 'separate collection' for all battery packs and battery pack. It will then be recycled or dismantled in order to reduce the impact on the environment. Battery packs can be hazardous for the environment and for human health since they contain hazardous substances.



Fuse



Positive terminal



Negative terminal



RCM marking



Read the operator's manual

**ABN:** Australian Business Number. By this number, business information such as entity type, status, business location etc. can be found at website <http://abr.business.gov.au>.  
ABN of Positec Australia Pty Limited is 14 101 682 357

# Safety Information

**Important** - Please read these instructions fully before starting assembly

## General Power Tool Safety Warnings



**WARNING!** Read all safety warnings and all instructions. Failure to follow the warnings and instructions may result in electric shock, fire and/or serious injury.

**Save all warnings and instructions for future reference.**

The term "power tool" in the warnings refers to your mains-operated (corded) power tool or battery-operated (cordless) power tool.

### 1) Work area safety

- a) **Keep work area clean and well lit.** Cluttered or dark areas invite accidents.
- b) **Do not operate power tools in explosive atmospheres, such as in the presence of flammable liquids, gases or dust.** Power tools create sparks which may ignite the dust or fumes.
- c) **Keep children and bystanders away while operating a power tool.** Distractions can cause you to lose control.

### 2) Electrical safety

- a) **Power tool plugs must match the outlet. Never modify the plug in any way. Do not use any adapter plugs with earthed (grounded) power tools.** Unmodified plugs and matching outlets will reduce risk of electric shock.
- b) **Avoid body contact with earthed or grounded surfaces, such as pipes, radiators, and refrigerators.** There is an increased risk of electric shock if your body is earthed or grounded.
- c) **Do not expose power tools to rain or wet conditions.** Water entering a power tool will increase the risk of electric shock.
- d) **Do not abuse the cord. Never use the cord for carrying, pulling or unplugging the power tool. Keep cord away from heat, oil, sharp edges or moving parts.** Damaged or entangled cords increase the risk of electric shock.
- e) **When operating a power tool outdoors, use an extension cord suitable for outdoor use.** Use of a cord suitable for outdoor use reduces the risk of electric shock.
- f) **If operating a power tool in a damp location is unavoidable, use a residual current device (RCD) protected supply.** Use of an RCD reduces the risk of electric shock.

### 3) Personal safety

- a) **Stay alert, watch what you are doing and use common sense when operating a power tool. Do not use a power tool while you are tired or under the influence of drugs, alcohol or medication.** A moment of inattention while operating power tools may result in serious personal injury.
- b) **Use personal protective equipment. Always wear eye protection.** Protective equipment such as dust mask, non-skid safety shoes, or hearing protection used for appropriate conditions will reduce personal injuries.
- c) **Prevent unintentional starting. Ensure the switch is in the off-position before connecting to power source and/or battery pack, picking up or carrying the tool.** Carrying power tools with your finger on the switch or energising power tools that have the switch on invites accidents.

# Safety Information

**Important** - Please read these instructions fully before starting assembly

## General Power Tool Safety Warnings

- d) **Remove any adjusting key or wrench before turning the power tool on.** A wrench or a key left attached to a rotating part of the power tool may result in personal injury.
- e) **Do not overreach. Keep proper footing and balance at all times.** This enables better control of the power tool in unexpected situations.
- f) **Dress properly. Do not wear loose clothing or jewellery. Keep your hair, clothing and gloves away from moving parts.** Loose clothes, jewellery or long hair can be caught in moving parts.
- g) **If devices are provided for the connection of dust extraction and collection facilities, ensure these are connected and properly used.** Use of dust collection can reduce dust-related hazards.

### 4) Power tool use and care

- a) **Do not force the power tool. Use the correct power tool for your application.**  
The correct power tool will do the job better and safer at the rate for which it was designed.
- b) **Do not use the power tool if the switch does not turn it on and off.** Any power tool that cannot be controlled with the switch is dangerous and must be repaired.
- c) **Disconnect the plug from the power source and/or the battery pack from the power tool before making any adjustments, changing accessories, or storing power tools.** Such preventive safety measures reduce the risk of starting the power tool accidentally.
- d) **Store idle power tools out of the reach of children and do not allow persons unfamiliar with the power tool or these instructions to operate the power tool.**  
Power tools are dangerous in the hands of untrained users.
- e) **Maintain power tools. Check for misalignment or binding of moving parts, breakage of parts and any other condition that may affect the power tool's operation. If damaged, have the power tool repaired before use.** Many accidents are caused by poorly maintained power tools.
- f) **Keep cutting tools sharp and clean.** Properly maintained cutting tools with sharp cutting edges are less likely to bind and are easier to control.
- g) **Use the power tool, accessories and tool bits etc. in accordance with these instructions, taking into account the working conditions and the work to be performed.** Use of the power tool for operations different from those intended could result in a hazardous situation.

### 5) Battery tool use and care

- a) **Recharge only with the charger specified by the manufacturer.** A charger that is suitable for one type of battery pack may create a risk of fire when used with another battery pack.
- b) **Use power tools only with specifically designated battery packs.** Use of any other battery packs may create a risk of injury and fire.
- c) **When battery pack is not in use, keep it away from other metal objects, like paper clips, coins, keys, nails, screws or other small metal objects, that can make a connection from one terminal to another.** Shorting the battery terminals together may cause burns or a fire.

# Safety Information

**Important** - Please read these instructions fully before starting assembly

## General Power Tool Safety Warnings

- d) **Under abusive conditions, liquid may be ejected from the battery; avoid contact.** If contact accidentally occurs, flush with water. If liquid contacts eyes, additionally seek medical help. Liquid ejected from the battery may cause irritation or burns.
- 6) **Service**  
**Have your power tool serviced by a qualified repair person using only identical replacement parts.** This will ensure that the safety of the power tool is maintained.

## Safety instruction for cutting

**Hold power tool by insulated gripping surfaces, when performing an operation where the cutting accessory may contact hidden wiring. Cutting accessory contacting a "live" wire may make exposed metal parts of the power tool "live" and could give the operator an electric shock.**

## General Safety Warnings for your Battery Charger



**WARNING:** Read all safety warnings and all instructions. Failure to follow the warnings and instructions may result in electric shock, fire and/or serious injury.

### Save all warnings and instructions for future reference.

- This appliance is not intended for use by persons (including children) with reduced physical, sensory or mental capabilities, or lack of experience and knowledge, unless they have been given supervision or instruction concerning use of the appliance by a person responsible for their safety.
- Children should be supervised to ensure that they do not play with the appliance. If the supply cord is damaged, it must be replaced by the manufacturer, its service agent or similarly qualified persons in order to avoid a hazard.

### Additional safety instructions for your Battery Charger

1. Before charging, read the instructions.
2. For charge 1.5Ah/2.0Ah/4.0Ah battery pack only.
3. Do not charge a leaking battery.
4. Do not use chargers for works other than those for which they are designed.
5. Before charging, ensure your charger is matching the local AC supply.
6. The charging device must be protected from moisture.
7. Do not use the charging device in the open.
8. Do not short out the contacts of battery or charger.
9. Respect the polarity "+/-" when charging.
10. Do not open the unit and keep out of the reach of children.
11. Do not charge the batteries of other manufactures or ill-suited models.
12. Ensure that the connection between the battery charger and battery is correctly positioned and is not obstructed by foreign bodies.
13. Keep battery charger's slots are free of foreign objects and protect against dirt and humidity. Store in a dry and frost-free place.
14. When charging batteries, ensure that the battery charger is in a well-ventilated area

# Safety Information

**Important** - Please read these instructions fully before starting assembly

## General Safety Warnings

and away from inflammable materials. Batteries can get hot during charging. Do not overcharge any batteries. Ensure that batteries and chargers are not left unsupervised during charging.

15. Do not recharge non-rechargeable batteries, as they can overheat and break.
16. Longer life and better performance can be obtained if the battery pack is charged when the air temperature is between 18°C and 24°C. Do not charge the battery pack in air temperatures below 4.5°C, or above 40.5°C. This is important as it can prevent serious damage to the battery pack.
17. Charge only battery pack of the same model provided by POSITEC and of models recommended by POSITEC

## Safety Warnings for battery pack

- a) **Do not dismantle, open or shred cells or battery pack.**
- b) **Do not short-circuit a battery pack. Do not store battery packs haphazardly in a box or drawer where they may short-circuit each other or be short-circuited by conductive materials.** When battery pack is not in use, keep it away from other metal objects, like paper clips, coins, keys, nails, screws or other small metal objects, that can make a connection from one terminal to another. Shorting the battery terminals together may cause burns or a fire.
- c) **Do not expose battery pack to heat or fire. Avoid storage in direct sunlight.**
- d) **Do not subject battery pack to mechanical shock.**
- e) **In the event of battery leaking, do not allow the liquid to come into contact with the skin or eyes. If contact has been made, wash the affected area with copious amounts of water and seek medical advice.**
- f) **Seek medical advice immediately if a cell or battery pack has been swallowed.**
- g) **Keep battery pack clean and dry.**
- h) **Wipe the battery pack terminals with a clean dry cloth if they become dirty.**
- i) **Battery pack needs to be charged before use. Always refer to this instruction and use the correct charging procedure.**
- j) **Do not maintain battery pack on charge when not in use.**
- k) **After extended periods of storage, it may be necessary to charge and discharge the battery pack several times to obtain maximum performance.**
- l) **Battery pack gives its best performance when it is operated at normal room temperature [20 °C ± 5 °C].**
- m) **When disposing of battery packs, keep battery packs of different electrochemical systems separate from each other.**
- n) **Recharge only with the charger specified by manufacturer. Do not use any charger other than that specifically provided for use with the equipment. A charger that is suitable for one type of battery pack may create a risk of fire when used with another battery pack.**
- o) **Do not use any battery pack which is not designed for use with the equipment.**
- p) **Keep battery pack out of the reach of children.**
- q) **Retain the original product literature for future reference.**
- r) **Remove the battery from the equipment when not in use.**
- s) **Dispose of properly.**

# In The Box

## Parts

- ① Tool-less accessory clamping lever
- ② On/Off switch
- ③ Battery pack release button \*
- ④ Battery pack \*
- ⑤ Variable speed control
- ⑥ Venting slot
- ⑦ LED light
- ⑧ Flange

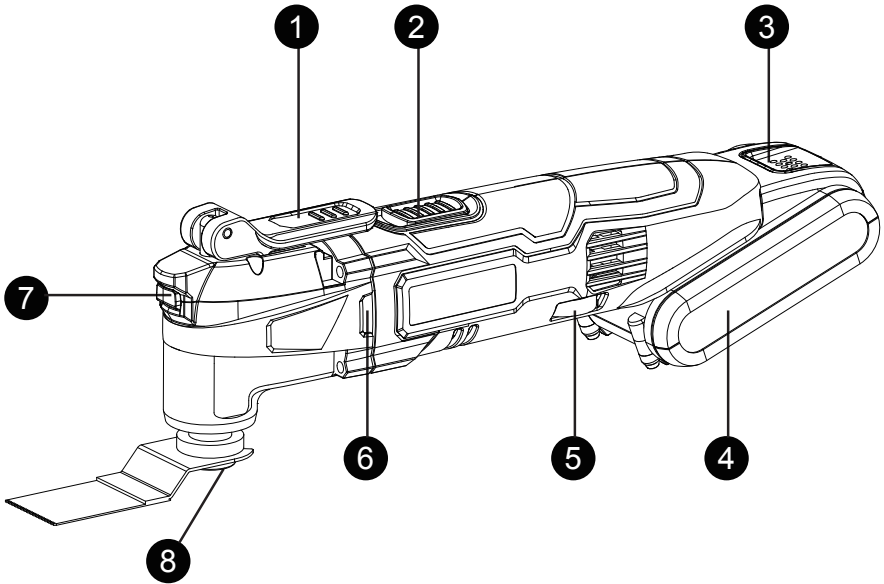

## Accessories

1-1/8" 28mm standard end cut blade	1
1-3/8" 35mm standard end cut blade	1
Rigid scraping blade	1
Sanding pad	1
Sanding sheet (60#/80#/120#)	3



# Operating Instructions



**NOTE:** Before using the tool, read the instruction book carefully.

## Intended Use

The machine is intended for dry sanding of wood, plastic, filler and coated surfaces.

## BEFORE PUTTING INTO OPERATION

### Charging the battery

#### NOTE:

- Do not use any charger other than that specifically provided for use with the equipment.
- If the battery pack is very hot you must remove your battery pack from the charger and allow time for the battery to cool down before recharging.
- The battery in your new tool is not charged when it leaves the plant. Therefore it must be full charged before using the first time.
- Please charge the battery to reach full or no less than half charge before storage. If the tool will not be used for long periods of time, charge the battery every 3-6 months.

### Charging procedure (See Fig. A1)

- Plug the charger into an appropriate outlet. The light will be green.
- Slide the battery pack into the charger, the light will turn to red to indicate the charging process has started.
- When charging is completed, the light will turn to green. The pack is now fully charged, unplug the charger and remove the battery pack.



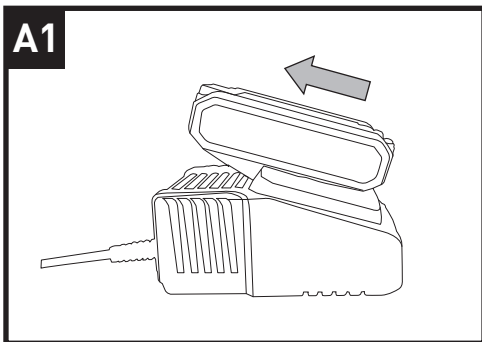

**WARNING:** When battery charge runs out after continuously use or exposure to direct sunlight or heat, allow time for the tool to cool down before re-charging to achieve the full charge.



# Operating Instructions

## Charging indicator

This charger is designed to detect some problems that can arise with battery packs. Indicator lights indicate problems (see table below). If this occurs, insert a new battery pack to determine if the charger is OK. If the new battery charges correctly, then the original pack is defective and should be returned to a service center or recycling service center. If the new battery pack displays the same problem as the original Battery Pack, have the charger tested at an authorized service center.

Light	Status
Red on ● 	Charging
Green on ● 	Fully Charged
Light off	Defective Battery

## Charging the battery (for ACG18LD/ACG18LD3)

Do not use any charger other than that specifically provided for use with the equipment.

If the battery pack is very hot you must remove your battery pack from the charger and allow time for the battery to cool down before recharging.

Please charge the battery to reach full before storage. If the tool will not be used for long periods of time, charge the battery every 3 months.

### CHARGING PROCEDURE (See Fig. A2, A3, A4)

- 1) Plug the charger into an appropriate outlet. The light will be green.
- 2) Slide the battery pack into the charger, make sure the battery is in the correct charge position firmly. the light will turn to red to indicate the charging process has started.
- 3) When charging is completed, the light will turn to green.
- 4) After fully charged, unplug the charger and remove the battery pack.

**NOTE:** If the battery pack is locked in the charger, press the battery pack release button and remove it.

 **WARNING:** When battery charge runs out after continuously use or exposure to direct sunlight or heat, allow time for the tool to cool down before re-charging to achieve the full charge.

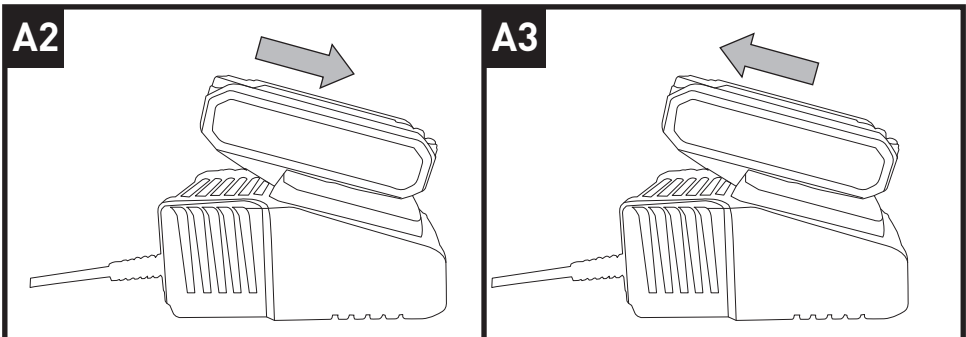

# Operating Instructions

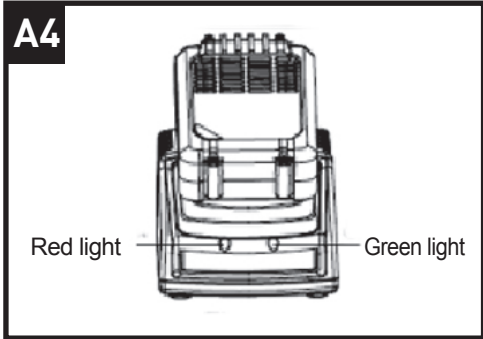

## Charging indicator

This charger is designed to detect some problems that can arise with battery packs. Indicator lights indicate problems (see table below). If this occurs, insert a new battery pack to determine if the charger is OK. If the new battery charges correctly, then the original pack is defective and should be returned to a service center or recycling service center. If the new battery pack displays the same problem as the original Battery Pack, have the charger tested at an authorized service center.

Light	ON/OFF flash	Status
Red on ●	—————	Charging
Red flash	- - - - -	Defective battery
Green on ●	—————	Fully charged
Green flash	- - - - -	Battery too Hot/cold

## Charging the battery (for ACG218Z2)

### NOTE:

- Do not use any charger other than that specifically provided for use with the equipment.
- If the battery pack is very hot you must remove your battery pack from the charger and allow time for the battery to cool down before recharging.
- The battery in your new tool is not charged when it leaves the plant. Therefore it must be full charged before using the first time.
- Please charge the battery to reach full or no less than half charge before storage. If the tool will not be used for long periods of time, charge the battery every 3-6 months.

### CHARGING PROCEDURE (See Fig. A5)

- Plug the charger into an appropriate outlet. The light will be green.
- Slide the battery pack into the charger, the light will turn to red to indicate the charging process has started.

# Operating Instructions

3) When charging is completed, the light will turn to green. The pack is now fully charged, unplug the charger and remove the battery pack.

**⚠ WARNING:** When battery charge runs out after continuous use or exposure to direct sunlight or heat, allow time for the battery to cool down before re-charging to achieve the full charge.

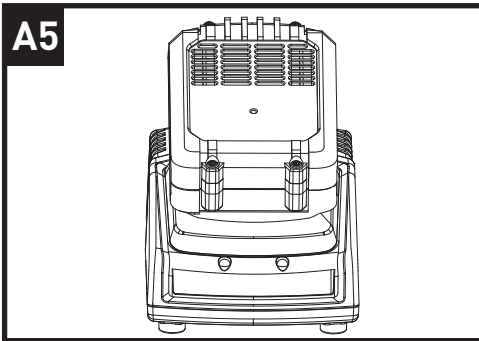

## CHARGING INDICATOR

This charger is designed to detect some problems that can arise with battery packs. Indicator lights indicate problems (see table below). If this occurs, insert a new battery pack to determine if the charger is OK. If the new battery charges correctly, then the original pack is defective and should be returned to a service center or recycling service center. If the new battery pack displays the same problem as the original Battery Pack, have the charger tested at an authorized service center.

Light	ON/OFF flash	Status
Red on ●	—————	Charging
Red flash	- - - - -	Defective battery
Green on ●	—————	Fully charged
Green flash	- - - - -	Battery too Hot/cold

## TO REMOVE THE BATTERY PACK (See Fig. B1)

Depress the Battery Pack Release Button (2) firmly first and then slide the Battery Pack out from your tool.

## TO INSTALL THE BATTERY PACK (See Fig. B2)

Slide the fully charged Battery Pack onto the tool with sufficient force until it clicks into position.

**NOTE:** The accessories of battery charger and battery pack illustrated or described are not included in delivery.

# Operating Instructions

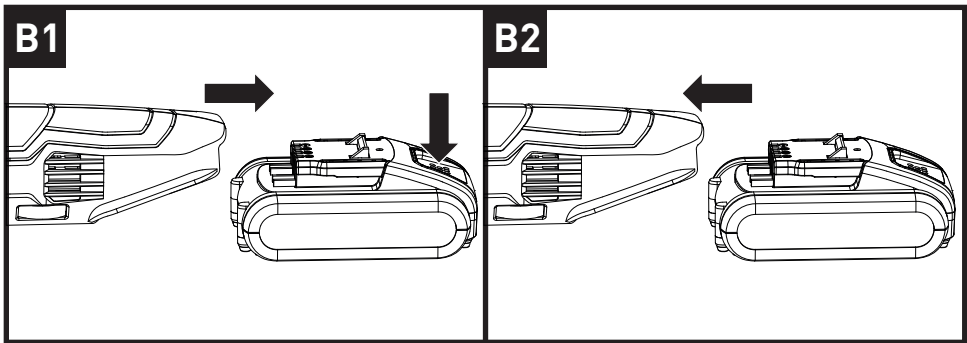

## OPERATION

### Intended Use

The power tool is intended for sawing and separating wooden materials, plastic, plaster, non-ferrous metals and fasteners (e.g. nails and clamps) as well as for working on soft wall tiles and for dry grinding of small surfaces. It is especially suitable for working close to edges and for flush cutting.



**WARNING:** Do not touch the gear box after long working time, because it could be hot.

### 1. MOUNTING ACCESSORIES (See Fig. C1-C3)

**Caution:** For all work or when changing accessories, always wear protective gloves. Avoid danger of injury from the sharp edges of the accessories. Accessories can become very hot while working, presenting danger of burns! Make sure the tool is unplugged prior to changing accessories.



**WARNING:** To reduce the risk of injury, do not let the sharp side of the accessory face back toward the user's hand.

**The tool free system makes you change the accessories without using an Allen key.**

- 1) Flip the tool-less accessory clamping lever forward to the open position.
- 2) Rotate the lever counterclockwise to loosen the flange.
- 3) Insert the accessory onto the Accessory Interface, then press down the flange with finger to keep blade temporarily secure.
- 4) Rotate the lever clockwise until accessory is tightened securely.
- 5) Flip lever back down.
- 6) Return lever to seated position.

# Operating Instructions

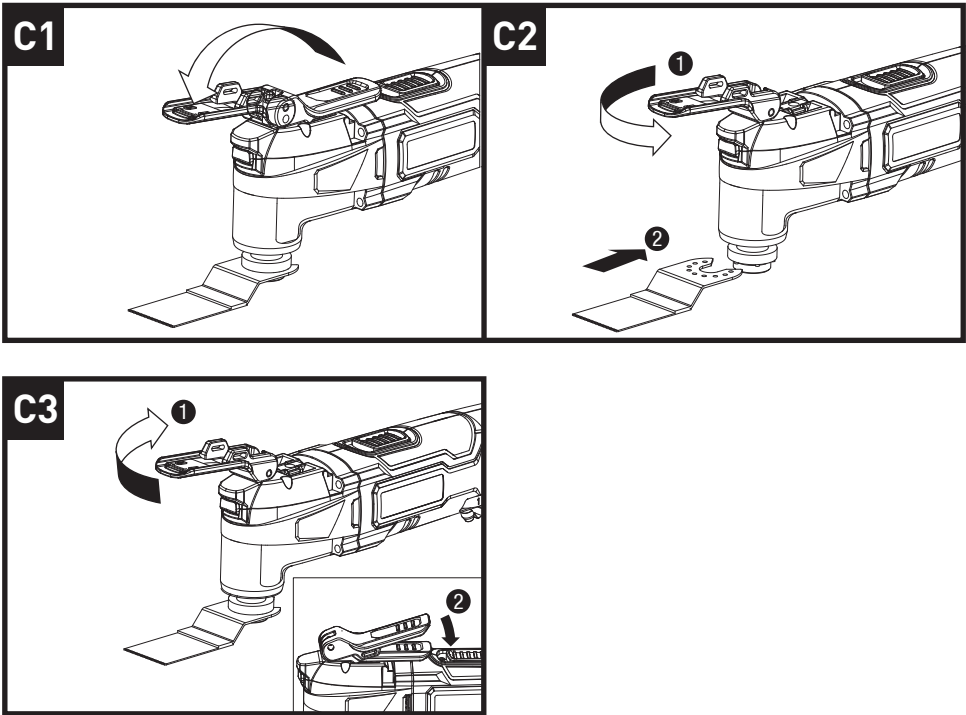

## 2. MOUNTING/CHANGING THE SANDING SHEET (See Fig. D)

Align the sanding sheet and press it onto the sanding pad by hand.

Firmly press the power tool with the sanding sheet against a flat surface and briefly switch the power tool on. This provides for good adhesion and prevents premature wear.

If one point has become worn, pull off the sanding sheet, turn it 120° and place it on again.

## 3. OPERATING THE ON/OFF SWITCH (See Fig. E)

To start the machine, push the On/Off switch forward so that the "1" mark is indicated on the switch.

To switch off the machine, push the On/Off switch toward the rear so that the "0" mark is indicated on the switch.

# Operating Instructions

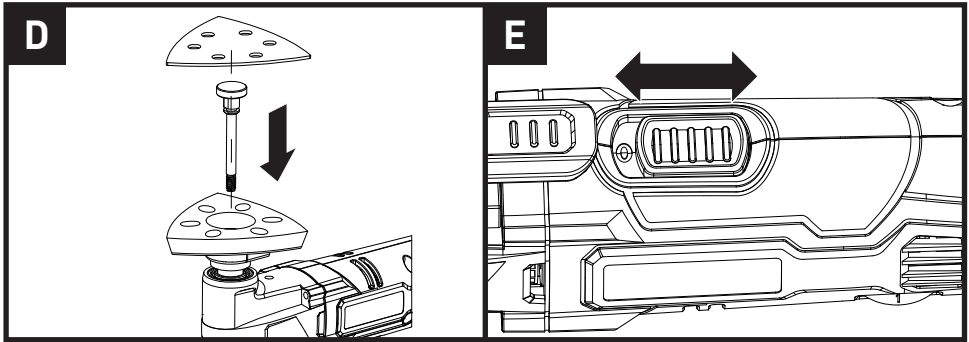

#### 4. USING THE VARIABLE SPEED CONTROL (See Fig. F)

Select oscillation frequency (speed) while the motor is running.

The variable speed control can be used to set the optimum oscillating frequency according to the accessories used and the respective application.

High oscillation frequency: Sanding, sawing, rasping and polishing stone and metal.

Low oscillation frequency: Polishing varnishes.

#### 5. LED LIGHT

The sight light allows you to keep a clear view under less illuminated circumstances. To turn on the light simply press the on/off switch. When you release the on/off switch, the light will be off.

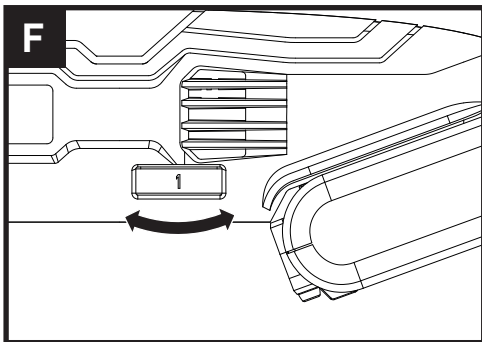

# Working Hints For Your Tool

If your power tool becomes too hot, especially when used at low speed, set the speed to maximum and run it with no load for 2-3 minutes to cool the motor. Avoid prolonged usage at very low speeds. Always keep the blade sharp.

Always ensure the workpiece is firmly held or clamped to prevent movement.

Any movement of the material may affect the quality of the cutting or sanding finish.

Start your tool before working and turn it off only after you stop working.

Do not start sanding without having the sandpaper fitted.

Do not allow the sandpaper to wear away, it will damage the sanding pad. The guarantee does not cover sanding pad wear and tear.

Use coarse grit paper to sand rough surfaces, medium grit for smooth surfaces and fine grit for finishing surfaces. If necessary, first make a test run on scrap material.

Excessive force will reduce the working efficiency and cause motor overload. Replacing the accessory regularly will maintain optimum working efficiency.

## Maintenance

**Remove the battery pack from the tool before carrying out any adjustment, servicing or maintenance.**

Your power tool requires no additional lubrication or maintenance.

There are no user serviceable parts in your power tool. Never use water or chemical cleaners to clean your power tool. Wipe clean with a dry cloth. Always store your power tool in a dry place. Keep the motor ventilation slots clean. Keep all working controls free of dust. Occasionally you may see sparks through the ventilation slots. This is normal and will not damage your power tool.

## For Battery tools





The ambient temperature range for the use and storage of tool and battery is 0°C-45°C.

The recommended ambient temperature range for the charging system during charging is 0°C-40°C.



# Technical Data

## Technical Data Table

Voltage		18 V 		
No load speed		5000-20000/min		
Oscillations angle		3.0°		
Machine weight		0.84kg		
Charging time		1.5Ah battery	2.0Ah battery	4.0Ah battery
	400mA charger (HYCH0102000400S)	3-5hrs	5-7hrs	10-12hrs
	1.5A Charger (ACG18LD)	60min	80min	160min
	3.0A Charger (ACG18LD3)	40min	60min	120min
Charger Input		100-240V-50/60Hz		
Charger Output		10.8--20V  400mA by slow charger 10.8--20V  1.5A by 1.5A fast charger 14.4--20V  3.0A by 3.0A fast charger		
Applicable battery		1.5/2.0/4.0Ah Li-ion battery		
Charger Protection class				

**Staple your purchase receipt here**  
**Before returning this product for**  
**warranty or any other reason, please call.**  
**POSITEC AUSTRALIA PTY LIMITED**  
**ABN 14 101 682 357**  
**Unit 15, 23 Narabang Way Belrose 2085 NSW Australia**  
**FREE CALL 1300 889 028**  
**EMAIL:salesau@positecgroup.com**





