

# TOOLPRO

## 18V Brushless Polisher

Instruction Manual

CP18BD.9

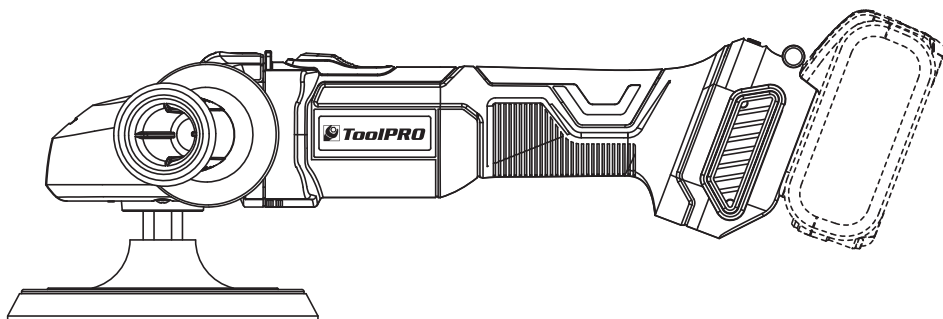

# **ToolPRO**

### After Sales Support

FREE CALL 1300 889 028  
EMAIL: [salesau@positecgroup.com](mailto:salesau@positecgroup.com)

**Important** - Please read these instructions fully before operating or maintaining your Angle Polisher

These instructions contain important information that will help you get the best from your Angle Polisher, ensuring it remains safe to operate.

If you need help or have damaged or missing parts, call the Customer Helpline on 1300889028

# Contents

<b>Safety Information .....</b>	<b>3</b>
<b>In The Box .....</b>	<b>11</b>
<b>Accessories .....</b>	<b>11</b>
<b>Operating Instructions.....</b>	<b>12</b>
<b>Working Hints For Your Angle Grinder.....</b>	<b>18</b>
<b>Maintenance .....</b>	<b>18</b>
<b>Trouble Shooting .....</b>	<b>18</b>
<b>Technical Data .....</b>	<b>19</b>

# Safety Information

**Important** - Please read these instructions fully before starting assembly

## Warning Symbols



To reduce the risk of injury, Please read the instruction manual



Warning



Wear ear protection



Wear eye protection



Wear dust mask



Indoor use only



Do not expose to rain or water



Do not burn



Waste electrical products must not be disposed of with household waste. Please recycle where facilities exist. Check with your local authorities or retailer for recycling advice.



Li-Ion



Li-Ion

Li-ion battery. This product has been marked with a symbol relating to 'separate collection' for all battery packs and battery pack. It will then be recycled or dismantled in order to reduce the impact on the environment. Battery packs can be hazardous for the environment and for human health since they contain hazardous substances.



T 2A

Fuse



Positive terminal



Negative terminal



RCM marking



Not permitted for face grinding with abrasive cutting off wheels

**ABN:** Australian Business Number. By this number, business information such as entity type, status, business location etc. can be found at website <http://abr.business.gov.au>.  
ABN of Positec Australia Pty Limited is 14 101 682 357

# Safety Information

**Important** - Please read these instructions fully before starting assembly

## General Power Tool Safety Warnings



**WARNING!** Read all safety warnings and all instructions. Failure to follow the warnings and instructions may result in electric shock, fire and/or serious injury.

**Save all warnings and instructions for future reference.**

The term "power tool" in the warnings refers to your mains-operated (corded) power tool or battery-operated (cordless) power tool.

### 1) Work area safety

- a) **Keep work area clean and well lit.** Cluttered or dark areas invite accidents.
- b) **Do not operate power tools in explosive atmospheres, such as in the presence of flammable liquids, gases or dust.** Power tools create sparks which may ignite the dust or fumes.
- c) **Keep children and bystanders away while operating a power tool.** Distractions can cause you to lose control.

### 2) Electrical safety

- a) **Power tool plugs must match the outlet. Never modify the plug in any way. Do not use any adapter plugs with earthed (grounded) power tools.** Unmodified plugs and matching outlets will reduce risk of electric shock.
- b) **Avoid body contact with earthed or grounded surfaces, such as pipes, radiators, ranges and refrigerators.** There is an increased risk of electric shock if your body is earthed or grounded.
- c) **Do not expose power tools to rain or wet conditions.** Water entering a power tool will increase the risk of electric shock.
- d) **Do not abuse the cord. Never use the cord for carrying, pulling or unplugging the power tool. Keep cord away from heat, oil, sharp edges or moving parts.** Damaged or entangled cords increase the risk of electric shock.
- e) **When operating a power tool outdoors, use an extension cord suitable for outdoor use.** Use of a cord suitable for outdoor use reduces the risk of electric shock.
- f) **If operating a power tool in a damp location is unavoidable, use a residual current device (RCD) protected supply.** Use of an RCD reduces the risk of electric shock.

### 3) Personal safety

- a) **Stay alert, watch what you are doing and use common sense when operating a power tool. Do not use a power tool while you are tired or under the influence of drugs, alcohol or medication.** A moment of inattention while operating power tools may result in serious personal injury.
- b) **Use personal protective equipment. Always wear eye protection.** Protective equipment such as dust mask, non-skid safety shoes, hard hat, or hearing protection used for appropriate conditions will reduce personal injuries.
- c) **Prevent unintentional starting. Ensure the switch is in the off-position before connecting to power source and/or battery pack, picking up or carrying the tool.** Carrying power tools with your finger on the switch or energising power tools that have the switch on invites accidents.
- d) **Remove any adjusting key or wrench before turning the power tool on.** A wrench or a

# Safety Information

**Important** - Please read these instructions fully before starting assembly

## General Power Tool Safety Warnings

- key left attached to a rotating part of the power tool may result in personal injury.
- e) **Do not overreach. Keep proper footing and balance at all times.** This enables better control of the power tool in unexpected situations.
  - f) **Dress properly. Do not wear loose clothing or jewellery. Keep your hair, clothing and gloves away from moving parts.** Loose clothes, jewellery or long hair can be caught in moving parts.
  - g) **If devices are provided for the connection of dust extraction and collection facilities, ensure these are connected and properly used.** Use of dust collection can reduce dust-related hazards.
- 4) **Power tool use and care**
- a) **Do not force the power tool. Use the correct power tool for your application.**  
The correct power tool will do the job better and safer at the rate for which it was designed.
  - b) **Do not use the power tool if the switch does not turn it on and off.** Any power tool that cannot be controlled with the switch is dangerous and must be repaired.
  - c) **Disconnect the plug from the power source and/or the battery pack from the power tool before making any adjustments, changing accessories, or storing power tools.** Such preventive safety measures reduce the risk of starting the power tool accidentally.
  - d) **Store idle power tools out of the reach of children and do not allow persons unfamiliar with the power tool or these instructions to operate the power tool.**  
Power tools are dangerous in the hands of untrained users.
  - e) **Maintain power tools. Check for misalignment or binding of moving parts, breakage of parts and any other condition that may affect the power tool's operation. If damaged, have the power tool repaired before use.** Many accidents are caused by poorly maintained power tools.
  - f) **Keep cutting tools sharp and clean.** Properly maintained cutting tools with sharp cutting edges are less likely to bind and are easier to control.
  - g) **Use the power tool, accessories and tool bits etc. in accordance with these instructions, taking into account the working conditions and the work to be performed.** Use of the power tool for operations different from those intended could result in a hazardous situation.
- 5) **Battery tool use and care**
- a) **Recharge only with the charger specified by the manufacturer.** A charger that is suitable for one type of battery pack may create a risk of fire when used with another battery pack.
  - b) **Use power tools only with specifically designated battery packs.** Use of any other battery packs may create a risk of injury and fire.
  - c) **When battery pack is not in use, keep it away from other metal objects, like paper clips, coins, keys, nails, screws or other small metal objects, that can make a connection from one terminal to another.** Shorting the battery terminals together may cause burns or a fire.
  - d) **Under abusive conditions, liquid may be ejected from the battery; avoid contact.**

# Safety Information

**Important** - Please read these instructions fully before starting assembly

## General Power Tool Safety Warnings

If contact accidentally occurs, flush with water. If liquid contacts eyes, additionally seek medical help. Liquid ejected from the battery may cause irritation or burns.

### 6) Service

Have your power tool serviced by a qualified repair person using only identical replacement parts. This will ensure that the safety of the power tool is maintained.

## Safety Instructions For All Operations

### Safety Warnings Common for Polishing:

- a) **This power tool is intended to function as a polisher. Read all safety warnings, instructions, illustrations and specifications provided with this power tool.** Failure to follow all instructions listed below may result in electric shock, fire and/or serious injury.
- b) **Operations such as grinding, sanding, wire brushing, or cutting-off are not recommended to be performed with this power tool.** Operations for which the power tool was not designed may create a hazard and cause personal injury.
- c) **Do not use accessories which are not specifically designed and recommended by the tool manufacturer.** Just because the accessory can be attached to your power tool, it does not assure safe operation.
- d) **The rated speed of the accessory must be at least equal to the maximum speed marked on the power tool.** Accessories running faster than their rated speed can break and fly apart.
- e) **The outside diameter and the thickness of your accessory must be within the capacity rating of your power tool.** Incorrectly sized accessories cannot be adequately guarded or controlled.
- f) **Threaded mounting of accessories must match the grinder spindle thread. For accessories mounted by flanges, the arbour hole of the accessory must fit the locating diameter of the flange.** Accessories that do not match the mounting hardware of the power tool will run out of balance, vibrate excessively and may cause loss of control.
- g) **Do not use a damaged accessory. Before each use inspect the accessory such as backing pad for cracks, tear or excess wear. If power tool or accessory is dropped, inspect for damage or install an undamaged accessory.** After inspecting and installing an accessory, position yourself and bystanders away from the plane of the rotating accessory and run the power tool at maximum no-load speed for one minute. Damaged accessories will normally break apart during this test time.
- h) **Wear personal protective equipment. Depending on application, use face shield, safety goggles or safety glasses. As appropriate, wear dust mask, hearing protectors, gloves and workshop apron capable of stopping small abrasive or workpiece fragments.** The eye protection must be capable of stopping flying debris generated by various operations. The dust mask or respirator must be capable of filtering particles generated by your operation. Prolonged exposure to high intensity noise may cause hearing loss.

# Safety Information

**Important** - Please read these instructions fully before starting assembly

## Safety Instructions For All Operations

- i) **Keep bystanders a safe distance away from work area. Anyone entering the work area must wear personal protective equipment.** Fragments of workpiece or of a broken accessory may fly away and cause injury beyond immediate area of operation.
- k) **Never lay the power tool down until the accessory has come to a complete stop.** The spinning accessory may grab the surface and pull the power tool out of your control.
- l) **Do not run the power tool while carrying it at your side.** Accidental contact with the spinning accessory could snag your clothing, pulling the accessory into your body.
- m) **Regularly clean the power tool's air vents.** The motor's fan will draw the dust inside the housing and excessive accumulation of powdered metal may cause electrical hazards.
- n) **Do not operate the power tool near flammable materials.** Sparks could ignite these materials.
- o) **Do not use accessories that require liquid coolants.** Using water or other liquid coolants may result in electrocution or shock.

## Further safety instructions for all operations

### Kickback and Related Warnings

Kickback is a sudden reaction to a pinched or snagged rotating wheel, backing pad, brush or any other accessory. Pinching or snagging causes rapid stalling of the rotating accessory which in turn causes the uncontrolled power tool to be forced in the direction opposite of the accessory's rotation at the point of the binding.

For example, if an abrasive wheel is snagged or pinched by the workpiece, the edge of the wheel that is entering into the pinch point can dig into the surface of the material causing the wheel to climb out or kick out. The wheel may either jump toward or away from the operator, depending on direction of the wheel's movement at the point of pinching. Abrasive wheels may also break under these conditions.

Kickback is the result of power tool misuse and/or incorrect operating procedures or conditions and can be avoided by taking proper precautions as given below.

- a) **Maintain a firm grip on the power tool and position your body and arm to allow you to resist kickback forces.** Always use auxiliary handle, if provided, for maximum control over kickback or torque reaction during start-up. The operator can control torque reactions or kickback forces, if proper precautions are taken.
- b) **Never place your hand near the rotating accessory.** Accessory may kickback over your hand.
- c) **Do not position your body in the area where power tool will move if kickback occurs.** Kickback will propel the tool in direction opposite to the wheel's movement at the point of snagging.
- d) **Use special care when working corners, sharp edges etc. Avoid bouncing and snagging the accessory.** Corners, sharp edges or bouncing have a tendency to snag the rotating accessory and cause loss of control or kickback.
- e) **Do not attach a saw chain woodcarving blade or toothed saw blade.** Such blades create frequent kickback and loss of control.

# Safety Information

**Important** - Please read these instructions fully before starting assembly

## **Safety Warnings Specific for Polishing Operations:**

- a) **Do not allow any loose portion of the polishing bonnet or its attachment strings to spin freely.** Tuck away or trim any loose attachment strings. Loose and spinning attachment strings can entangle your fingers or snag on the workpiece.

## **Safety Warnings for battery pack**

- a) Do not dismantle, open or shred cells or battery pack.
- b) Do not short-circuit a battery pack. Do not store battery packs haphazardly in a box or drawer where they may short-circuit each other or be short-circuited by conductive materials. When battery pack is not in use, keep it away from other metal objects, like paper clips, coins, keys, nails, screws or other small metal objects, that can make a connection from one terminal to another. Shorting the battery terminals together may cause burns or a fire.
- c) Do not expose battery pack to heat or fire. Avoid storage in direct sunlight.
- d) Do not subject battery pack to mechanical shock.
- e) In the event of battery leaking, do not allow the liquid to come into contact with the skin or eyes. If contact has been made, wash the affected area with copious amounts of water and seek medical advice.
- f) Seek medical advice immediately if a cell or battery pack has been swallowed.
- g) Keep battery pack clean and dry.
- h) Wipe the battery pack terminals with a clean dry cloth if they become dirty.
- i) Battery pack needs to be charged before use. Always refer to this instruction and use the correct charging procedure.
- j) Do not maintain battery pack on charge when not in use.
- k) After extended periods of storage, it may be necessary to charge and discharge the battery pack several times to obtain maximum performance.
- l) Battery pack gives its best performance when it is operated at normal room temperature (20 °C ± 5 °C).
- m) When disposing of battery packs, keep battery packs of different electrochemical systems separate from each other.
- n) Recharge only with the charger specified by POSITEC. Do not use any charger other than that specifically provided for use with the equipment. A charger that is suitable for one type of battery pack may create a risk of fire when used with another battery pack.
- o) Do not use any battery pack which is not designed for use with the equipment.
- p) Keep battery pack out of the reach of children.
- q) Retain the original product literature for future reference.
- r) Remove the battery from the equipment when not in use.
- s) Dispose of properly.



# Safety Information

**Important** - Please read these instructions fully before starting assembly

## General Safety Warnings



**WARNING: Read all safety warnings and all instructions.** Failure to follow the warnings and instructions may result in electric shock, fire and/or serious injury.

### Save all warnings and instructions for future reference.

- This appliance is not intended for use by persons (including children) with reduced physical, sensory or mental capabilities, or lack of experience and knowledge, unless they have been given supervision or instruction concerning use of the appliance by a person responsible for their safety.
- Children should be supervised to ensure that they do not play with the appliance. If the supply cord is damaged, it must be replaced by the manufacturer, its service agent or similarly qualified persons in order to avoid a hazard.

## Additional safety instructions for your Battery Charger

1. Before charging, read the instructions.
2. For charge Li-ion battery pack only.
3. Do not charge a leaking battery.
4. Do not use chargers for works other than those for which they are designed.
5. Before charging, ensure your charger is matching the local AC supply.
6. The charging device must be protected from moisture.
7. Do not use the charging device in the open.
8. Do not short out the contacts of battery or charger.
9. Respect the polarity "+/-" when charging.
10. Do not open the unit and keep out of the reach of children.
11. Do not charge the batteries of other manufactures or ill-suited models.
12. Ensure that the connection between the battery charger and battery is correctly positioned and is not obstructed by foreign bodies.
13. Keep battery charger's slots are free of foreign objects and protect against dirt and humidity. Store in a dry and frost-free place.
14. When charging batteries, ensure that the battery charger is in a well-ventilated area and away from inflammable materials. Batteries can get hot during charging. Do not overcharge any batteries. Ensure that batteries and chargers are not left unsupervised during charging.
15. Do not recharge non-rechargeable batteries, as they can overheat and break.
16. Longer life and better performance can be obtained if the battery pack is charged when the air temperature is between 18°C and 24°C. Do not charge the battery pack in air temperatures below 4.5°C, or above 40.5°C. This is important as it can prevent serious damage to the battery pack.
17. Charge only battery pack of the same model provided by POSITEC and of models recommended by POSITEC

# In The Box

## Parts

- ① Spindle lock button
- ② Auxiliary handle
- ③ On/Off Switch
- ④ Handle
- ⑤ Battery pack release button\*
- ⑥ Battery pack\*
- ⑦ Velcro backing pad
- ⑧ Foam disc\*

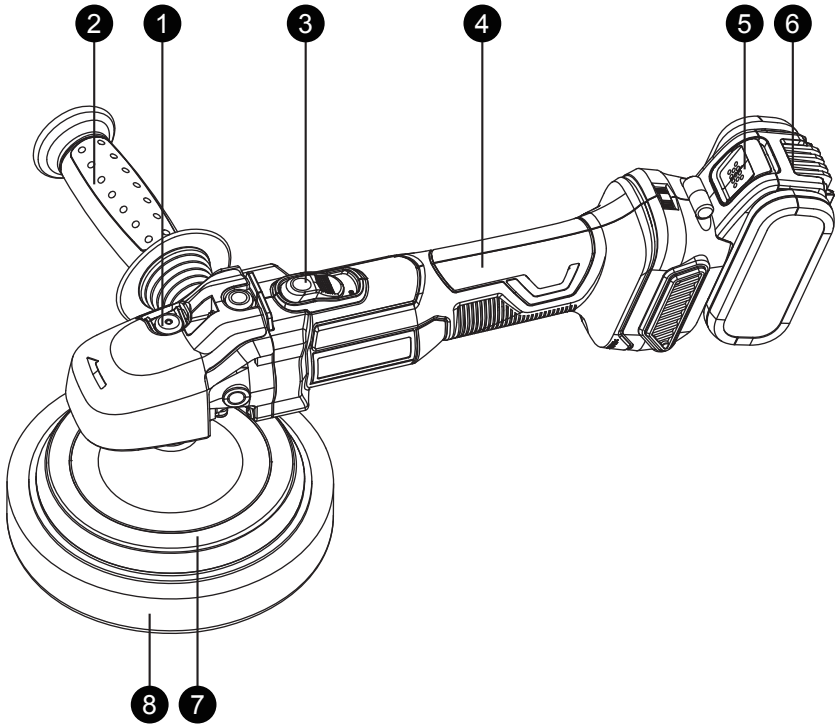

# Accessories

Auxiliary handle  
Velcro backing pad

1pc  
1pc

# Operating Instructions



**NOTE:** Before using the tool, read the instruction book carefully.

## Intended Use

The machine is intended for polishing floor, car and other coated surfaces.

## 1. ASSEMBLY

### 1.1 Assemble the auxiliary Handle (See Fig. A)

For your personal safety we recommend using the auxiliary handle at all time. There are 3 install position for auxiliary handle for easy control. Rotate the handle clockwise. Tighten fully.

### 1.2 Assemble the Velcro backing pad and the Foam disc .

Assemble the Velcro backing pad and the Foam disc .

Lock or loose the Velcro backing pad, the spindle lock button should be pressed. Screw Velcro backing pad securely on the tool. (See Fig. B1)

Place Foam disc securely on rotary plate and make sure it's centrosymmetric. Otherwise the polisher vibrates badly. (See Fig. B2)

**NOTE:** Remove the battery pack from the socket before carrying out the adjustment.

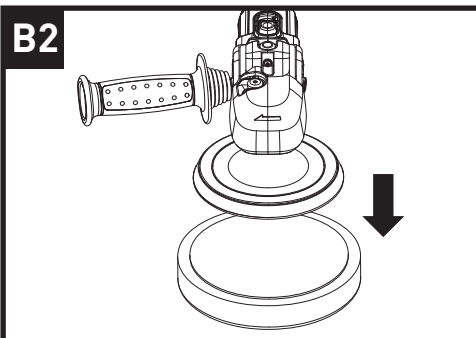
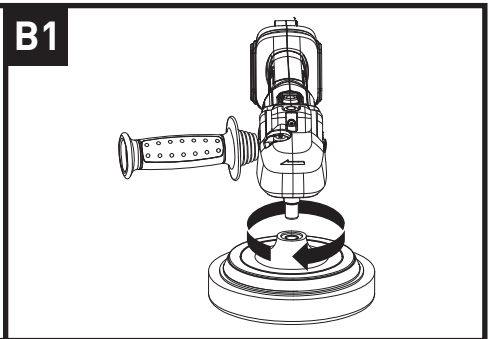
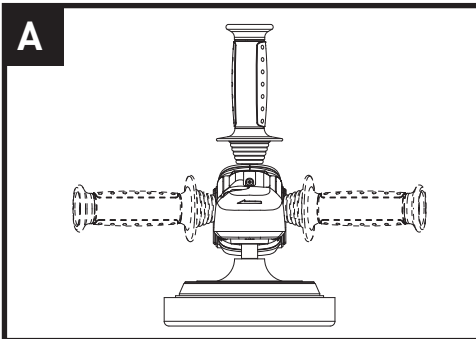

# Operating Instructions

## 2. BEFORE PUTTING INTO OPERATION



**WARNING:** The charger and battery pack are specially designed to work together so do not attempt to use any other devices. Never insert or allow metallic objects into your charger or battery pack connections because of an electrical failure and hazard will occur.

### CHARGING THE BATTERY PACK CHARGER ACG318GL

#### NOTE:

- a) Do not use any charger other than that specifically provided for use with the equipment.
- b) If the battery pack is very hot you must remove your battery pack from the charger and allow time for the battery to cool down before recharging.
- c) The battery in your new tool is not charged when it leaves the plant. Therefore it must be full charged before using the first time.
- d) Please charge the battery to reach full or no less than half charge before storage. If the tool will not be used for long periods of time, charge the battery every 3-6 months.

#### CHARGING PROCEDURE (SEE FIG. C1)

- 1) Plug the charger into an appropriate outlet. The light will be green.
- 2) Slide the battery pack into the charger, the light will turn to red to indicate the charging process has started.
- 3) When charging is completed, the light will turn to green. The pack is now fully charged, unplug the charger and remove the battery pack.

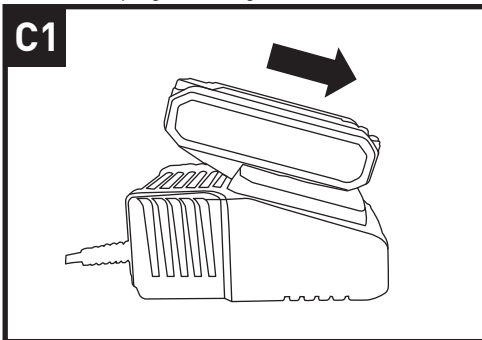



**WARNING:** When battery charge runs out after continuous use or exposure to direct sunlight or heat, allow time for the battery to cool down before re-charging to achieve the full charge.

#### CHARGING INDICATOR

This charger is designed to detect some problems that can arise with battery packs. Indicator lights indicate problems (see table below). If this occurs, insert a new battery pack to determine if the charger is OK. If the new battery charges correctly, then the original pack is defective and should be returned to a service center or recycling service center. If the new battery pack displays the same problem as the original Battery Pack, have the charger tested at an authorized service center.

# Operating Instructions

Light	Status
Red on ● 	Charging
Green on ● 	Fully Charged
Light off	Defective Battery

## CHARGER ACG18LD / ACG18LD3

Do not use any charger other than that specifically provided for use with the equipment. If the battery pack is very hot you must remove your battery pack from the charger and allow time for the battery to cool down before recharging.

Please charge the battery to reach full before storage. If the tool will not be used for long periods of time, charge the battery every 3 months.

## CHARGING PROCEDURE (SEE FIG. C2-C4)

- 1) Plug the charger into an appropriate outlet. The light will be green.
- 2) Slide the battery pack into the charger, make sure the battery is in the correct charge position firmly. the light will turn to red to indicate the charging process has started.
- 3) When charging is completed, the light will turn to green.
- 4) After fully charged, unplug the charger and remove the battery pack.

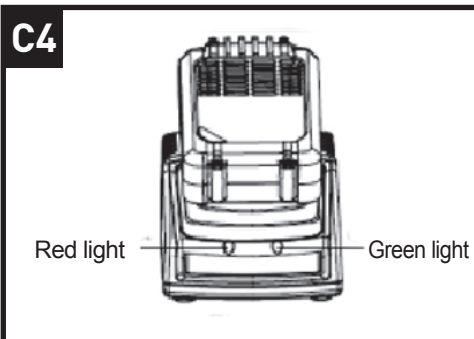
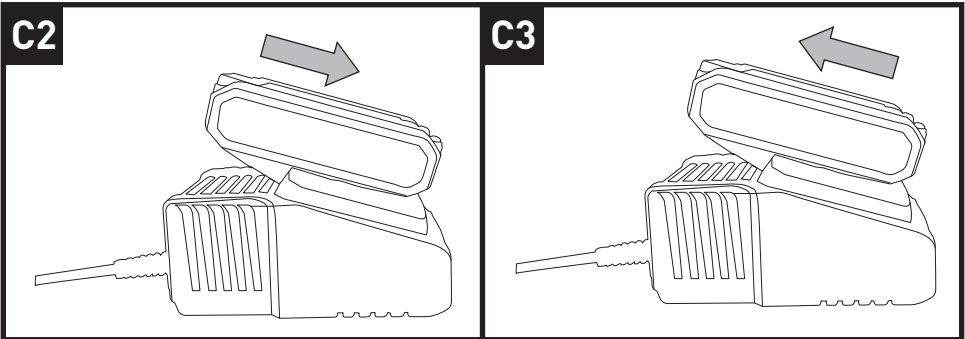









# Operating Instructions

**NOTE:** If the battery pack is locked in the charger, press the battery pack release button and remove it.

 **WARNING:** When battery charge runs out after continuous use or exposure to direct sunlight or heat, allow time for the battery to cool down before re-charging to achieve the full charge.

## CHARGING INDICATOR

This charger is designed to detect some problems that can arise with battery packs. Indicator lights indicate problems (see table below). If this occurs, insert a new battery pack to determine if the charger is OK. If the new battery charges correctly, then the original pack is defective and should be returned to a service center or recycling service center. If the new battery pack displays the same problem as the original Battery Pack, have the charger tested at an authorized service center.

Light	ON/OFF flash	Status
Red on  	————	Charging
Red flash  	- - - - -	Defective Battery
Green on  	————	Fully Charged
Green flash  	- - - - -	Battery Too Hot/Cold

## NOTE:

- Do not use any charger other than that specifically provided for use with the equipment.**
- If the battery pack is very hot you must remove your battery pack from the charger and allow time for the battery to cool down before recharging.**
- The battery in your new tool is not charged when it leaves the plant. Therefore it must be full charged before using the first time.**
- Please charge the battery to reach full or no less than half charge before storage. If the tool will not be used for long periods of time, charge the battery every 3-6 months.**

## CHARGING PROCEDURE (SEE FIG. C5)

- Plug the charger into an appropriate outlet. The light will be green.
- Slide the battery pack into the charger, the light will turn to red to indicate the charging process has started.
- When charging is completed, the light will turn to green. The pack is now fully charged, unplug the charger and remove the battery pack.



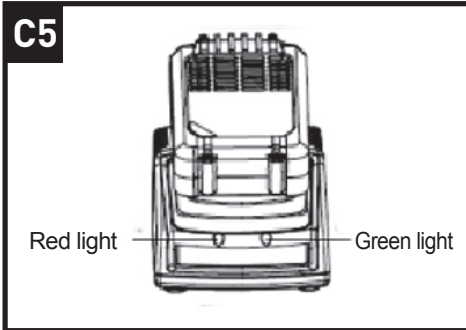

 **WARNING:** When battery charge runs out after continuous use or exposure to direct sunlight or heat, allow time for the battery to cool down before re-charging to achieve the full charge.

# Operating Instructions



This charger is designed to detect some problems that can arise with battery packs. Indicator lights indicate problems (see table below). If this occurs, insert a new battery pack to determine if the charger is OK. If the new battery charges correctly, then the original pack is defective and should be returned to a service center or recycling service center. If the new battery pack displays the same problem as the original Battery Pack, have the charger tested at an authorized service center.

**NOTE:** The accessories of battery charger (ACG318GL/ACG18LD/ACG18LD3/ACG218Z2) and battery pack (ABP118L1/ ABP118L2/ ABP118L25/ABP218L4Z/ABP118L6) illustrated or described are not included in CBP18GD.9 delivery.

Light	ON/OFF flash	Status
Red on 	—————	Charging
Red flash 	- - - - -	Defective Battery
Green on 	—————	Fully Charged
Green flash 	- - - - -	Battery Too Hot/Cold

# Operating Instructions

## OPERATION

### 1.SPREAD THE POLISH (SEE FIG. D)

Spread about a tablespoonful of polish evenly over the entire surface of the pad cover. Do not apply polish directly to car. The pad cover will not adsorb as much when reloading.

### 2. ON/OFF SWITCH (SEE FIG. E)

Always start and stop the polisher on against the car surface. Push the On/Off Switch forward as the arrow of "I" position shown to start the polisher. Push the switch backward as the arrow of "O" position shown to stop the polisher.

**NOTE:** The machine is equipped with the function of Accidental Start Protection. The machine will not run when you put the battery on the machine if switch is engaged "on" position to make sure safety to user. The machine will work only after you switching off and switching on again.

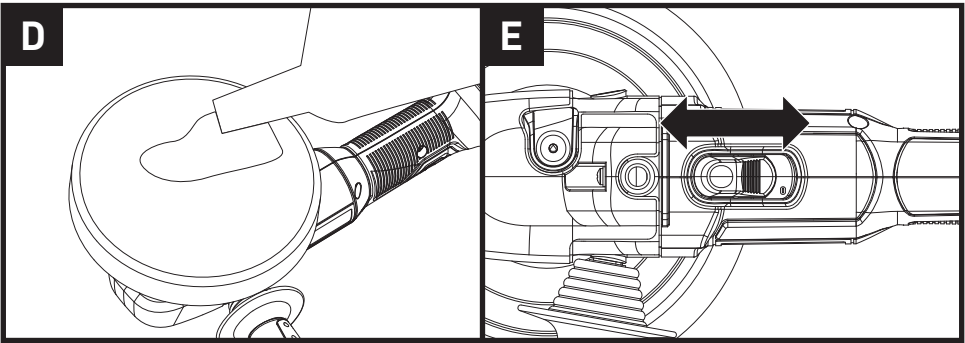

### 3. HAND GRIP AREAS(SEE FIG. F)

Always hold your car polisher firmly with both hands when operating.



**WARNING:** Always hold your car polisher firmly with both hands when operating.

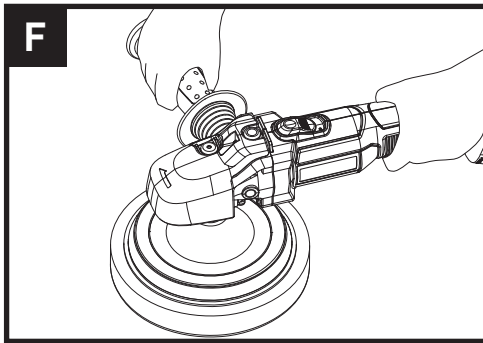

### 4. VARIABLE SPEED SWITCH ( SEE FIG. G)

The speed increases as you turn the Variable Speed Switch towards the higher number and decreases on the lower number.

Thumbwheel position 1 provides the slowest operating speed and position 6 the fastest.



# Operating Instructions

Speed may be changed while motor is running or while it is stopped (polisher works best on settings between position 4-6).

Number step	Speed range	Operation
1-3	850-1650/min	Recommend for lay on wax
4-6	2000-2800/min	Polishing operation

## 5. TO USE THE CAR POLISHER (SEE FIG. H)

Inside the battery pack into unit and do flat surfaces first, i.e.: bonnet boot and roof. Cover areas quickly with broad sweeping strokes in a crisscross pattern. Do not press down on polisher. The machine without any pressure will automatically do the best job.

## 6. FINAL WORK (SEE FIG. I)

Use long, sweeping strokes in a criss-cross pattern to bring out the shine. Do not over-press the polisher.

## 7. SANDING

Choose sanding paper carefully for each application for best operation and finish.

To have the best sanding result, it is recommended to work with lower speed.

Use the sanding feature for sanding off old paint from timber and metal surface. It can also be used for sanding timber smooth.

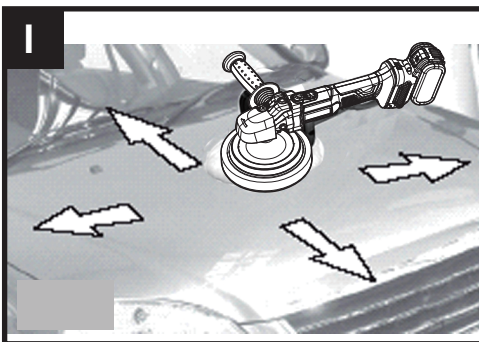
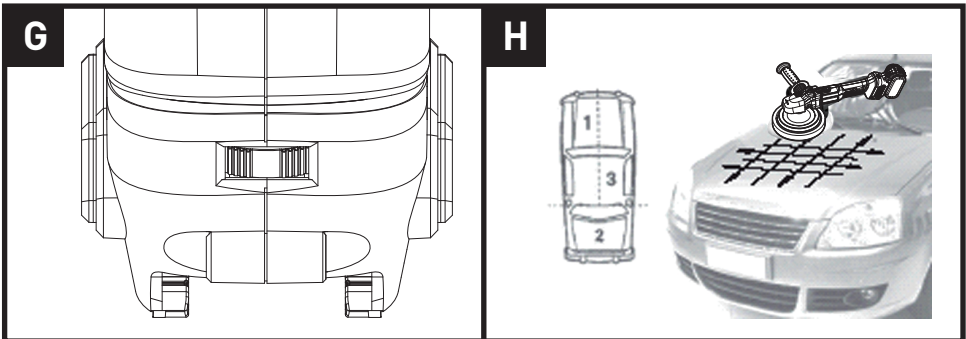

# Working Hints For Your Polisher

1. At all times, let the polisher do the work-do not force it or apply excessive pressure to the polisher. Preferably, use a light circular motion.  
Pressing too hard will slow down the machine's movement and affect the quality of the work.
2. The most common error, however, is applying too much wax. If pad absorbs too much wax, it will not last as long, and polishing is more difficult and takes longer.
3. If foam disc continually comes off Velcro backer pad, please try with a new foam disc.
4. If wax seems difficult to buff, you may have used too much wax.
5. The tool cannot be placed on the paint surface, there is a risk of scratching the paint.

## Maintenance

**Remove the battery pack from the socket before carrying out any adjustment, servicing or maintenance.**





Your power tool requires no additional lubrication or maintenance. There are no user serviceable parts in your power tool. Never use water or chemical cleaners to clean your power tool. Wipe clean with a dry cloth. Always store your power tool in a dry place. Keep the motor ventilation slots clean. Keep all working controls free of dust. Occasionally you may see sparks through the ventilation slots. This is normal.

## Trouble Shooting

1. If your power tool does not start, check the battery pack on the tool first.
2. If the polisher does not abrade surface, checking the pad. If the pad has been worn, replace the new pad and try again.
3. If a fault cannot be rectified, return the tool to an authorized dealer for repair.

# Technical Data

## Technical Data Table

Voltage		18 V 		
No-load speed		850-2800 /min		
Pad size		7" (180mm)		
Weight		1.8 kg		
Charging time		1.5Ah battery	2.0Ah battery	4.0Ah battery
	400mA charger (HYCH0102000400S)	3-5hrs	5-7hrs	10-12hrs
	1.5A Charger (ACG18LD)	60min	80min	160min
	3.0A Charger (ACG18LD3)	40min	60min	120min
Charger Input		100-240V-50/60Hz		
Charger Output		10.8--20V  400mA by slow charger 10.8--20V  1.5A by 1.5A fast charger 14.4--20V  3.0A by 3.0A fast charger		
Applicable battery		1.5/2.0/4.0Ah Li-ion battery		
Charger Protection class				

**Staple your purchase receipt here**  
**Before returning this product for**  
**warranty or any other reason, please call.**  
**POSITEC AUSTRALIA PTY LIMITED**  
**ABN 14 101 682 357**  
**Unit 15, 23 Narabang Way Belrose 2085 NSW Australia**  
**FREE CALL 1300 889 028**  
**EMAIL:salesau@positecgroup.com**

