

TOOLPRO

2000W Digital Display Heat Gun

Instruction Manual

PHG180C

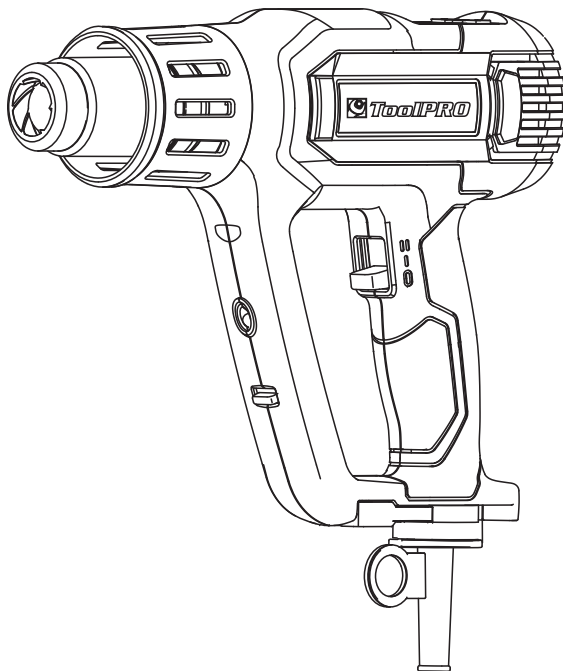

After Sales Support

FREE CALL 1300 889 028
EMAIL: salesau@positecgroup.com

Important - Please read these instructions fully before operating or maintaining your Heat Gun

These instructions contain important information that will help you get the best from your Heat Gun, ensuring it remains safe to operate.

If you need help or have damaged or missing parts, call the Customer Helpline on 1300 889 028

Contents

Safety Information	3
Accessories	4
In The Box	5
Operating Instructions	6
Maintenance	10
Trouble shooting	10
Technical data	10

Safety Information

Important - Please read these instructions fully before starting assembly

Warning Symbols



Read operator's manual



Wear eye protection



Wear dust mask



Double insulation



RCM marking

ABN: Australian Business Number. By this number, business information such as entity type, status, business location etc. can be found at website <http://abr.business.gov.au>.
ABN of Positec Australia Pty Limited is 14 101 682 357

Safety Information

Important - Please read these instructions fully before starting assembly

General safety warnings



WARNING! Read all safety warnings and all instructions. Failure to follow the warnings and instructions may result in electric shock, fire and/or serious injury.

Save all warnings and instructions for future reference.

- This appliance is not intended for use by persons (including children) with reduced physical, sensory or mental capabilities, or lack of experience and knowledge, unless they have been given supervision or instruction concerning use of the appliance by a person responsible for their safety.

- Children should be supervised to ensure that they do not play with the appliance.

If the supply cord is damaged, it must be replaced by the manufacturer, its service agent or similarly qualified persons in order to avoid a hazard.

Additional safety warnings for your heat gun

1. Before connecting the unit to the mains - ensure the unit is switched OFF because it will achieve maximum heat in a little time.
2. Always wear protective gloves and eyewear because it can reach 600 Centigrade.
3. Always place the appliance on its stand after use and allow it to cool down before storage and never touch the heat deflector.
4. Never attempt to use the appliance to dry animals, clothing or hair.
5. Never use this appliance as a hair dryer.
6. Be aware that heat may be conducted to combustible materials that are out of sight.
7. Be careful When using this appliance in places where there are combustible materials or gases, extreme caution must be taken to prevent fire or explosion.
8. Do not apply to the same place for a long time.
9. Do not use in presence of an explosive atmosphere. Always use it in ventilated areas.
10. Do not leave the heat gun unattended when it is switched on.
11. This product is designed for light domestic use only, it is not designed for industrial purposes and every care has been taken to make the heat gun safe, accidents can happen. By following the simple safety guide, you can avoid serious accidents.

Accessories

Scraper	1
Glass protection nozzle	1
Flat nozzle	1
Hook nozzle	1
Concentration nozzle	1

Original Instructions

In The Box

Parts

- ① Wind pipe
- ② Heat protection guard
- ③ Main body
- ④ Air cooling window
- ⑤ On/off switch
- ⑥ Stand supporter
- ⑦ Hook
- ⑧ Power cord
- ⑨ LED light switch
- ⑩ LED light cover
- ⑪ LCD cover
- ⑫ Temperature control button
- ⑬ °F/°C button
- ⑭ Scraper
- ⑮ Flat nozzle
- ⑯ Glass protection nozzle
- ⑰ Hook nozzle
- ⑱ Concentration nozzle

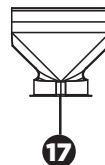
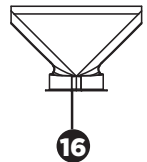
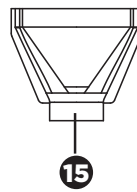
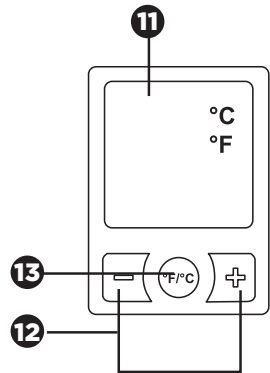
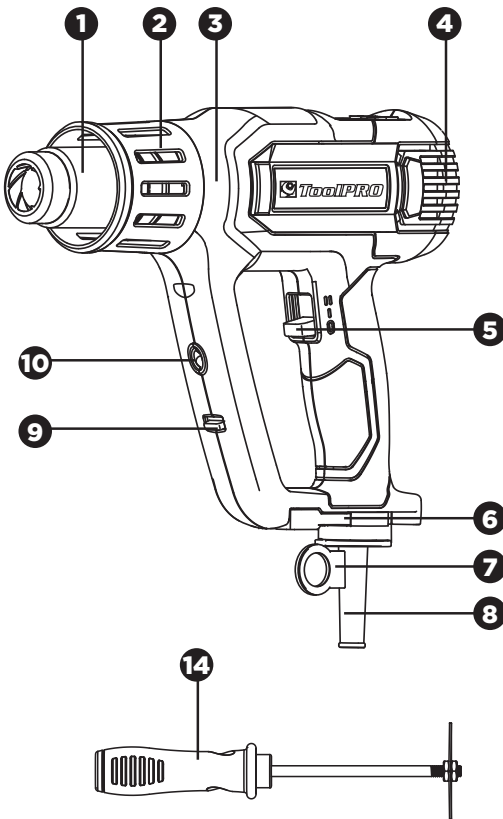

Operating Instructions



NOTE: Before using the tool, read the instruction book carefully.

BEFORE USING THE TOOL

Before starting the job it is advisable to test the workpiece for the ideal temperature to use. The description below gives an indication of the likely heat settings required but always start with the low heat setting.

The distance between the nozzle and the workpiece will vary according to the material being worked on but this should always be at least 50 mm or more on any heat setting. All applications, with the exception of removing paint from the window frames, can be performed without using a nozzle; however for best results nozzles are recommended.

PUTTING INTO OPERATION (SEE FIG A)

1. SWITCHING ON/OFF

SWITCHING ON:

To put into operation, slide the on/off switch (5) to position I or II.

Switching off:

To switch off, slide the on/off switch (5) to the stop at position 0.

2. SETTING THE AIR FLOW AND TEMPERATURE (SEE FIG B)

The switch (5) can be set to two blower settings. Suitable airflow and temperature combinations can be selected according to the applications.

I = 50 - 600°C (120 - 1100°F), 300 L/min (8.1CFM)

II = 50 - 600°C (120 - 1100°F), 500L/min (13.5CFM)

The air setting I is suitable for Bending Plastic and heating-shrinking plastic.

The air setting II is suitable for stripping paint and defrosting pipes.

Temperature can be adjusted in increments of 10 °C (20°F) from 50°C (120°F) to 600°C (1100°F) by pressing the temperature control button (12) on the LCD cover (11).

°F or °C can be selected by pressing °F / °C

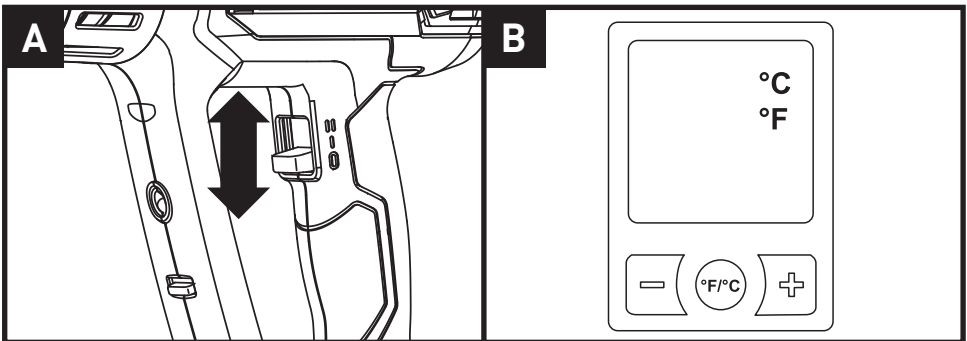

Operating Instructions

3. NOZZLES SELECTION

The kit is supplied with 4 different shaped nozzles, which can be used as follows:

1) CONCENTRATION NOZZLE

This nozzle directs a concentrated heat flow to the workpiece. It is ideal for use when removing paint in awkward corners, crevices, mouldings, beading, architraves or whenever precise paint removal is required.

2) FLAT NOZZLE

This nozzle directs a long narrow heat pattern to the workpiece, and is ideal for removing paint or varnish from large flat surfaces such as skirting boards, doors, stairs etc. It should be used in conjunction with a flat scraper. Vinyl tiles can be removed by softening the tile and adhesive.

3) GLASS PROTECTION NOZZLE

This nozzle deflects the heat away from glass or other fragile areas and back onto the workpiece.

4) HOOK NOZZLE

This nozzle disperses the heat flow evenly around the whole workpiece. It is ideal for defrosting frozen pipes, soldering pipe work, bending plastics and heat-shrinking electrical parts.

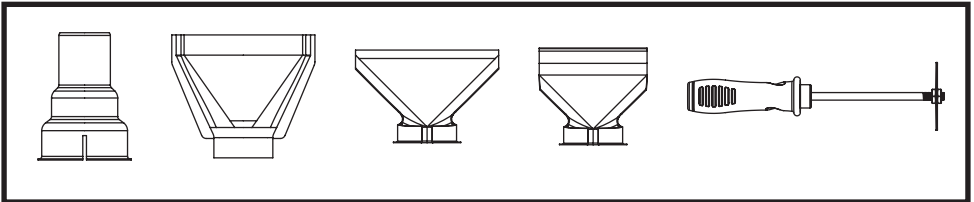

4. SHAVE HOOK

Take the handle from the set, remove the nut from the end, and fit the triangle blade in place by refitting and tightening the nut. The triangular shave hook is ideal for stripping paint from flat wooden surface and edges.

Remember to clean the blade after use with wire wool and lightly oil before storing.

5. REMOVING PAINT

Choose the required nozzle and fit onto the heat outlet. Select the scraper or shave hook required. Hold the gun with the nozzle approximately 50 mm from the surface of the paintwork and start with the lower heat setting. Move the heat gun slowly backwards and forwards until the paint blisters and bubbles. Immediately remove the paint with the scraper or shave hook. Aim to heat the paint just ahead of the scraper so that you can develop a continuous action. Do not heat the paint for too long as this will burn the paint, making it difficult to remove.

Most stickers can also be removed from paintwork by using the heat to soften the adhesive. Be careful not to direct the heat for too long if you are trying just to remove the stickers as this will blister the paint.

Operating Instructions

6. REMOVING PAINT FROM WINDOW FRAMES

Always use the glass protection nozzle. Ensure you have the nozzle facing the correct way to deflect the heat away from the glass before you switch on. Rotate the gun or nozzle 90° as you move to horizontal or vertical bead. Allow nozzle to cool before attempting to turn it. Paint can be removed from profile surfaces by using a shave hook and/or a soft wire brush.



WARNING! Glass can break easily.

7. DEFROSTING FROZEN PIPES

Choose the hook nozzle and fit over the wind pipe (1). Always heat from one or other end of the frozen portion, not from the middle.



WARNING! Do not attempt to defrost PVC pipes. Always check that it is a water pipe and not a gas pipe. Do not heat a gas pipe.

8. SHRINK SEATING ELECTRICAL CABLES

Choose the hook nozzle and fit over the wind pipe (1). Select a heat-shrinkable sleeve with a diameter matching that of the workpiece. Evenly heat the sleeve.

9. BENDING PLASTIC TUBE

Choose the hook nozzle and fit over the wind pipe (1). Turn the gun upside down and place on its clip stand so that it is resting on a secure bench with the nozzle pointing upwards. To avoid buckling or kinking the tube, fill the tube with dry sand and seal at both ends. Heat the tube evenly by moving from side to side and bend to required shape.



WARNING! Protect hands from heat.

10. STAND SUPPORTER USE (SEE FIG C, D)

This gun can be used in stationary mode.

1. Firstly fold down the Stand supporter (6).
2. Set the gun onto a level, stable workbench. Be sure that the tool will not tip over.
3. Secure the power cord (8) to prevent entanglement or pulling the gun off the workbench.
4. Turn the gun on by selecting the desired air flow.

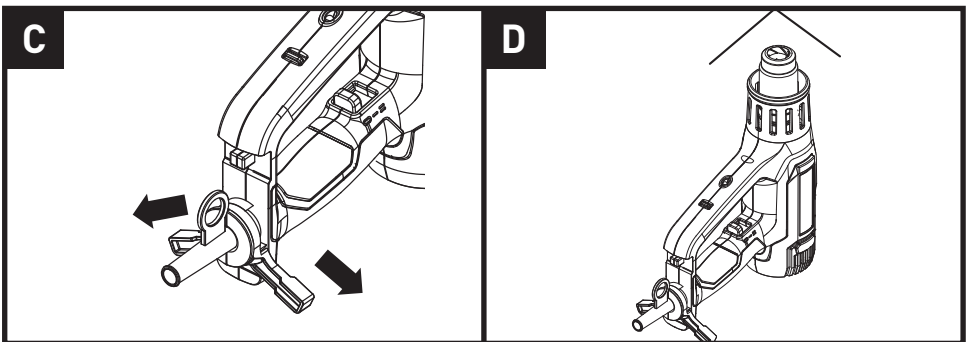

Operating Instructions

11. LED LIGHT (SEE FIG. E)

Switching on:

To switch on, slide the LED light switch (9) up.

Switching off:

To switch off, slide the LED light switch (9) down.

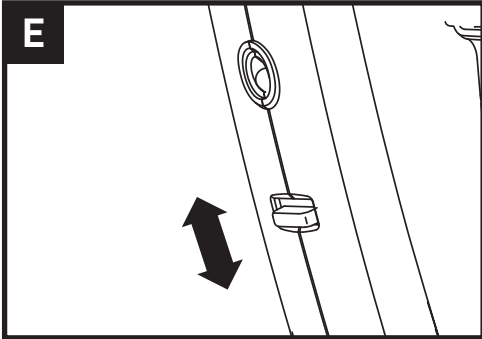

Maintenance

Remove the plug from the socket before carrying out any adjustment, servicing or maintenance.

There are no user serviceable parts in your power tool. Never use water or chemical cleaners to clean your power tool. Wipe clean with a dry cloth. Always store your power tool in a dry place. Keep the motor ventilation slots clean. Keep all working controls free of dust. Occasionally you may see sparks through the ventilation slots. This is normal and will not damage your power tool.

If the supply cord is damaged, it must be replaced by the manufacturer, its service agent or similarly qualified persons in order to avoid a hazard.

Trouble shooting

1. If your heat gun will not operate, check the power at the power outlet.
2. If the outlet of the heat gun very hot, please rest until cold.
3. If a fault can not be rectified return the tool to an authorized dealer for repair.

Technical data

Technical Data Table

Voltage	230-240V~50Hz
Power	2000W
Temperature/Flow rate	I =50 - 600°C(120 - 1100°F), 300 L/min (8.1CFM)
	II=50 - 600°C(120 - 1100°F), 500L/min (13.5CFM)
Machine weight	0.91kg
Protection class	□/II

**Staple your purchase receipt here
Before returning this product for
warranty or any other reason, please call.**

POSITEC AUSTRALIA PTY LIMITED

ABN 14 101 682 357

Unit 15, 23 Narabang Way Belrose 2085 NSW Australia

FREE CALL 1300 889 028

EMAIL: salesau@positecgroup.com

