

TOOLPRO

18V Cordless Jigsaw

Instruction Manual

CSJ18G.9

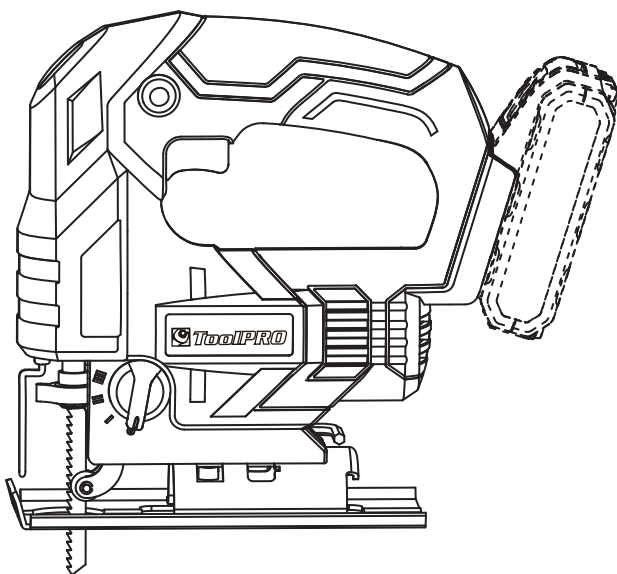

ToolPRO

After Sales Support

FREE CALL 1300 889 028
EMAIL:salesau@positecgroup.com

Important - Please read these instructions fully before operating or maintaining your jig saw

These instructions contain important information that will help you get the best from your jig saw, ensuring it remains safe to operate.

If you need help or have damaged or missing parts, call the Customer Helpline on 1300 889 028

Contents

| | |
|--|-----------|
| Safety Information | 3 |
| In The Box | 9 |
| Accessories | 9 |
| Operating Instructions | 10 |
| Working hints for your Jig Saw | 13 |
| Maintenance | 17 |
| Disposal of an exhausted battery pack | 17 |
| Troubleshooting | 17 |
| Technical Data | 18 |

Safety Information

Important - Please read these instructions fully before starting assembly

Warning Symbols



To reduce the risk of injury, Please read the instruction manual



Warning



Wear ear protection



Wear eye protection



Wear dust mask



Indoor use only



Do not expose to rain or water



Do not burn



Waste electrical products must not be disposed of with household waste. Please recycle where facilities exist. Check with your local authorities or retailer for recycling advice.



Li-Ion



Li-Ion

Li-ion battery. This product has been marked with a symbol relating to 'separate collection' for all battery packs and battery pack. It will then be recycled or dismantled in order to reduce the impact on the environment. Battery packs can be hazardous for the environment and for human health since they contain hazardous substances.



Fuse



Positive terminal



Negative terminal



Read the operator's manual



Double insulation



RCM marking

ABN: Australian Business Number. By this number, business information such as entity type, status, business location etc. can be found at website <http://abr.business.gov.au>.
ABN of Positec Australia Pty Limited is 14 101 682 357

Safety Information

Important - Please read these instructions fully before starting assembly

General Power Tool Safety Warnings

 **WARNING!** Read all safety warnings and all instructions. Failure to follow the warnings and instructions may result in electric shock, fire and/or serious injury.

Save all warnings and instructions for future reference.

The term "power tool" in the warnings refers to your mains-operated (corded) power tool or battery-operated (cordless) power tool.

1) Work area safety

- a) Keep work area clean and well lit.** Cluttered or dark areas invite accidents.
- b) Do not operate power tools in explosive atmospheres, such as in the presence of flammable liquids, gases or dust.** Power tools create sparks which may ignite the dust or fumes.
- c) Keep children and bystanders away while operating a power tool.** Distractions can cause you to lose control.

2) Electrical safety

- a) Power tool plugs must match the outlet. Never modify the plug in any way. Do not use any adapter plugs with earthed (grounded) power tools.** Unmodified plugs and matching outlets will reduce risk of electric shock.
- b) Avoid body contact with earthed or grounded surfaces, such as pipes, radiators, ranges and refrigerators.** There is an increased risk of electric shock if your body is earthed or grounded.
- c) Do not expose power tools to rain or wet conditions.** Water entering a power tool will increase the risk of electric shock.
- d) Do not abuse the cord. Never use the cord for carrying, pulling or unplugging the power tool. Keep cord away from heat, oil, sharp edges or moving parts.** Damaged or entangled cords increase the risk of electric shock.
- e) When operating a power tool outdoors, use an extension cord suitable for outdoor use.** Use of a cord suitable for outdoor use reduces the risk of electric shock.
- f) If operating a power tool in a damp location is unavoidable, use a residual current device (RCD) protected supply.** Use of an RCD reduces the risk of electric shock.

3) Personal safety

- a) Stay alert, watch what you are doing and use common sense when operating a power tool. Do not use a power tool while you are tired or under the influence of drugs, alcohol or medication.** A moment of inattention while operating power tools may result in serious personal injury.
- b) Use personal protective equipment. Always wear eye protection.** Protective equipment such as dust mask, non-skid safety shoes, hard hat, or hearing protection used for appropriate conditions will reduce personal injuries.
- c) Prevent unintentional starting. Ensure the switch is in the off-position before connecting to power source and/or battery pack, picking up or carrying the tool.** Carrying power tools with your finger on the switch or energising power tools that have the switch on invites accidents.
- d) Remove any adjusting key or wrench before turning the power tool on.** A wrench or a

Safety Information

Important - Please read these instructions fully before starting assembly

General Power Tool Safety Warnings

key left attached to a rotating part of the power tool may result in personal injury.

- e) **Do not overreach. Keep proper footing and balance at all times.** This enables better control of the power tool in unexpected situations.
 - f) **Dress properly. Do not wear loose clothing or jewellery. Keep your hair, clothing and gloves away from moving parts.** Loose clothes, jewellery or long hair can be caught in moving parts.
 - g) **If devices are provided for the connection of dust extraction and collection facilities, ensure these are connected and properly used.** Use of dust collection can reduce dust-related hazards.
- 4) Power tool use and care**
- a) **Do not force the power tool. Use the correct power tool for your application.** The correct power tool will do the job better and safer at the rate for which it was designed.
 - b) **Do not use the power tool if the switch does not turn it on and off.** Any power tool that cannot be controlled with the switch is dangerous and must be repaired.
 - c) **Disconnect the plug from the power source and/or the battery pack from the power tool before making any adjustments, changing accessories, or storing power tools.** Such preventive safety measures reduce the risk of starting the power tool accidentally.
 - d) **Store idle power tools out of the reach of children and do not allow persons unfamiliar with the power tool or these instructions to operate the power tool.** Power tools are dangerous in the hands of untrained users.
 - e) **Maintain power tools. Check for misalignment or binding of moving parts, breakage of parts and any other condition that may affect the power tool's operation. If damaged, have the power tool repaired before use.** Many accidents are caused by poorly maintained power tools.
 - f) **Keep cutting tools sharp and clean.** Properly maintained cutting tools with sharp cutting edges are less likely to bind and are easier to control.
 - g) **Use the power tool, accessories and tool bits etc. in accordance with these instructions, taking into account the working conditions and the work to be performed.** Use of the power tool for operations different from those intended could result in a hazardous situation.
- 5) Battery tool use and care**
- a) **Recharge only with the charger specified by the manufacturer.** A charger that is suitable for one type of battery pack may create a risk of fire when used with another battery pack.
 - b) **Use power tools only with specifically designated battery packs.** Use of any other battery packs may create a risk of injury and fire.
 - c) **When battery pack is not in use, keep it away from other metal objects, like paper clips, coins, keys, nails, screws or other small metal objects, that can make a connection from one terminal to another.** Shorting the battery terminals together may cause burns or a fire.
 - d) **Under abusive conditions, liquid may be ejected from the battery; avoid contact. If contact accidentally occurs, flush with water. If liquid contacts eyes, additionally seek medical help.** Liquid ejected from the battery may cause irritation or burns.

Safety Information

Important - Please read these instructions fully before starting assembly

General Power Tool Safety Warnings

6) Service

Have your power tool serviced by a qualified repair person using only identical replacement parts. This will ensure that the safety of the power tool is maintained.

Additional safety rules for your jig saw

1. Always wear a dust mask.
2. Hold power tool by insulated gripping surfaces when performing an operation where the cutting tool may contact hidden wiring. Cutting accessory contacting a "live" wire may make exposed metal parts of the power tool "live" and could give the operator an electric shock.



WARNING: Some dust particles created by power sawing, contain chemicals known to cause cancer, birth defects or other reproductive harm. Some examples of these chemicals are:

- Lead from lead-based paints.
- Crystalline silica from bricks and cement and other masonry products.
- Arsenic and chromium from chemically treated lumber.

Your risk from these exposures varies, depending upon how often you do this type of work. To reduce your exposure to these chemicals:

- Work in a well-ventilated area.
- Work with approved safety equipment, such as those dust masks that are specially designed to filter microscopic particles.

Safety Warnings for battery pack

- a) Do not dismantle, open or shred cells or battery pack.
- b) Do not short-circuit a battery pack. Do not store battery packs haphazardly in a box or drawer where they may short-circuit each other or be short-circuited by conductive materials. When battery pack is not in use, keep it away from other metal objects, like paper clips, coins, keys, nails, screws or other small metal objects, that can make a connection from one terminal to another. Shorting the battery terminals together may cause burns or a fire.
- c) Do not expose battery pack to heat or fire. Avoid storage in direct sunlight.
- d) Do not subject battery pack to mechanical shock.
- e) In the event of battery leaking, do not allow the liquid to come into contact with the skin or eyes. If contact has been made, wash the affected area with copious amounts of water and seek medical advice.
- f) Seek medical advice immediately if a cell or battery pack has been swallowed.
- g) Keep battery pack clean and dry.
- h) Wipe the battery pack terminals with a clean dry cloth if they become dirty.
- i) Battery pack needs to be charged before use. Always refer to this instruction and use the correct charging procedure.
- j) Do not maintain battery pack on charge when not in use.
- k) After extended periods of storage, it may be necessary to charge and discharge the battery pack several times to obtain maximum performance.
- l) Battery pack gives its best performance when it is operated at normal room temperature (20 °C ± 5 °C).

Safety Information

Important - Please read these instructions fully before starting assembly

General Power Tool Safety Warnings

- m) When disposing of battery packs, keep battery packs of different electrochemical systems separate from each other.
- n) **Recharge only with the charger specified by manufacturer.** Do not use any charger other than that specifically provided for use with the equipment. A charger that is suitable for one type of battery pack may create a risk of fire when used with another battery pack.
- o) **Do not use any battery pack which is not designed for use with the equipment.**
- p) **Keep battery pack out of the reach of children.**
- q) **Retain the original product literature for future reference.**
- r) **Remove the battery from the equipment when not in use.**
- s) **Dispose of properly.**

General Safety Warnings for Battery Charger

WARNING: Read all safety warnings and all instructions. Failure to follow the warnings and instructions may result in electric shock, fire and/or serious injury.

Save all warnings and instructions for future reference.

- This appliance is not intended for use by persons (including children) with reduced physical, sensory or mental capabilities, or lack of experience and knowledge, unless they have been given supervision or instruction concerning use of the appliance by a person responsible for their safety.

- Children should be supervised to ensure that they do not play with the appliance.

If the supply cord is damaged, it must be replaced by the manufacturer, its service agent or similarly qualified persons in order to avoid a hazard.

Additional safety instructions for your Battery Charger

1. Before charging, read the instructions.
2. For charge Li-ion battery pack only.
3. If the supply cord is damaged, it must be replaced by the manufacturer, its service agent or similarly qualified persons in order to avoid a hazard.
4. The battery terminal not connected to the chassis has to be connected first. The other connection is to be made to the chassis, remote from the battery and fuel line. The battery charger is then to be connected to the supply mains.
5. After charging, disconnect the battery charger from the supply mains. Then remove the chassis connection and then the battery connection.
6. Do not charge a leaking battery.
7. Do not use chargers for works other than those for which they are designed.
8. Before charging, ensure your charger is matching the local AC supply.
9. The charging device must be protected from moisture.
10. Do not use the charging device in the open.
11. Do not short out the contacts of battery or charger.
12. Respect the polarity "+/-" when charging.
13. Do not open the unit and keep out of the reach of children.
14. Do not charge the batteries of other manufactures or ill-suited models.
15. Ensure that the connection between the battery charger and battery is correctly positioned and is not obstructed by foreign bodies.

Safety Information

Important - Please read these instructions fully before starting assembly

General Power Tool Safety Warnings

16. Keep battery charger's slots free of foreign objects and protect against dirt and humidity. Store in a dry and frost-free place.
17. When charging batteries, ensure that the battery charger is in a well-ventilated area and away from inflammable materials. Batteries can get hot during charging. Do not overcharge any batteries. Ensure that batteries and chargers are not left unsupervised during charging.
18. Do not recharge non-rechargeable batteries, as they can overheat and break.
19. Longer life and better performance can be obtained if the battery pack is charged when the air temperature is between 18°C and 24°C. Do not charge the battery pack in air temperatures below 4.5°C, or above 40.5°C. This is important as it can prevent serious damage to the battery pack.
20. Charge only battery pack of the same model provided by manufacturer and of models recommended by manufacturer.

In The Box

Parts

- | | |
|-------------------|---------------------------|
| ① Lock-off Button | ⑦ Pendulum Action Control |
| ② On/Off switch | ⑧ Roller Guide |
| ③ Hand Grip Areas | ⑨ Wood cutting blade |
| ④ Allen key | ⑩ Tool-free Blade Holder |
| ⑤ Base Plate | ⑪ Finger Protection |
| ⑥ Angle Plate | |

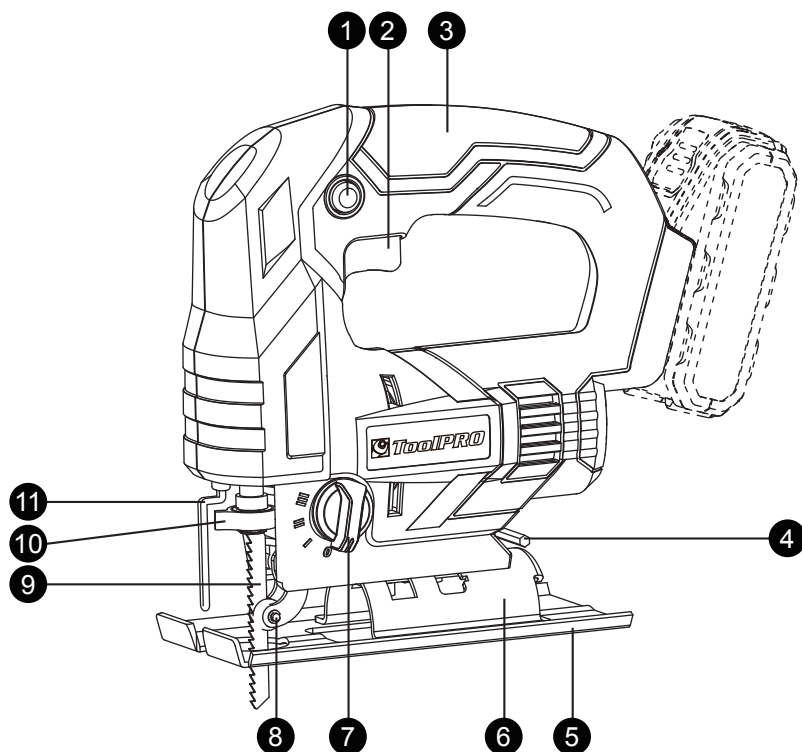

Accessories

Allen key
Wood cutting blade

1pc
1pc

Operating Instructions



NOTE: Before using the tool, read the instruction book carefully.

Intended Use

This tool is intended for sawing wood, plastic, metal and building materials while resting firmly on the workpiece. It is suitable for straight and curved cuts with bevel angles to 45°. The saw blade recommendations are to be observed.

1. CHARGING

We strongly recommend to use ToolPRO battery & charger kit. Please contact your local Supercheap Auto store for more details or log onto www.supercheapauto.com.au for Australia or www.supercheapauto.co.nz for New Zealand customers to find out more details.

BEFORE PUTTING INTO OPERATION

CHARGING THE BATTERY PACK (SEE FIG. A)

NOTE:

- a) **The battery in your new tool is not charged when it leaves the plant. Therefore it must be full charged before using the first time.**
- b) Do not use any charger other than that specifically provided for use with the equipment.
- c) If the battery pack is very hot you must remove your battery pack from the charger and allow time for the battery to cool down before recharging.
- d) Please charge the battery to reach full or no less than half charge before storage. If the tool will not be used for long periods of time, charge the battery every 3-6 months.

CHARGING PROCEDURE

- 1) Plug the charger into an appropriate outlet.
- 2) Place the battery pack into the charger
- 3) When charging is completed, unplug the charger and remove the battery pack.

Note: If the battery pack is locked in the charger, press the battery pack release button and remove it.







WARNING: When battery charge runs out after continuous use or exposure to direct sunlight or heat, allow time for the tool to cool down before re-charging to achieve the full charge.



Operating Instructions

CHARGING INDICATOR

1、 Fast charger(See fig. A1)

| Light | ON/OFF flash | Status |
|---|--------------|-------------------|
| Red on ●  | ———— | Charging |
| Red flash ☀  | - - - - - | Defective Battery |
| Green on ●  | ———— | Fully Charged |
| Green flash ☀  | - - - - - | Hot/Cold Delay |

2、 Slow charger(See fig. A2)

| Light | ON/OFF flash | Status |
|---|--------------|---------------|
| Green flash ●  | - - - - - | Charging |
| Green on ●  | ———— | Fully Charged |

A1

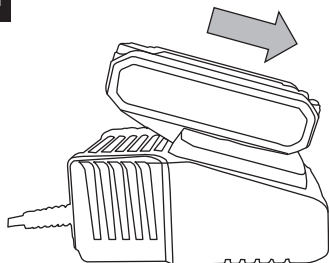

A2

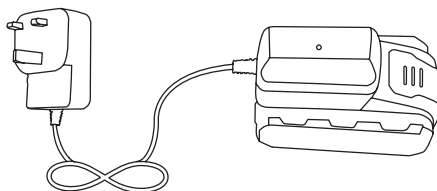

Operating Instructions

1. INSTALLING AND REMOVING THE BATTERY PACK (not supplied)

A) TO REMOVE THE BATTERY PACK (SEE FIG B1)

Depress the Battery Pack Release Button firmly first and then slide the Battery Pack out from your tool.

B) TO INSTALL THE BATTERY PACK (SEE FIG B2)

Slide the fully charged Battery Pack onto the tool with sufficient force until it clicks into position.

2. HAND GRIP AREAS

Always ensure you maintain a firm grip whilst operating your jigsaw.

3. ALLEN KEY STORAGE

The allen key (4) is placed at the position as shown in FIG C.

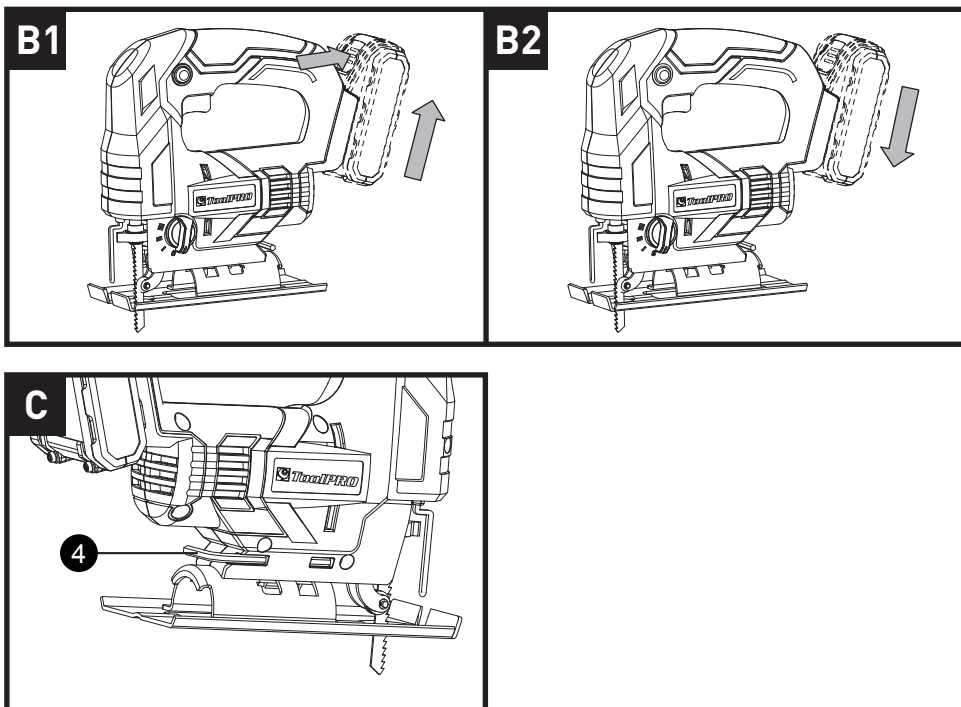

Operating Instructions

4. BLADE FITTING (SEE FIG. D, E, F)

NOTE: Before any work on the tool itself, remove the battery. Wear protective gloves when assembling the saw blade. You can only use the blade type shown in (FIG D). Don't use other blade types.

INSERTING THE SAW BLADE

To open the Tool-free Blade Holder (10) rotate the ring clockwise (Jigsaw upside down) and hold in position (SEE FIG D). Then fully insert the blade into the blade holder slot with blade teeth facing forward and release the ring, which will self rotate and clamp over the top of the blade. Push the blade into the blade holder again to ensure it is locked in position. Ensure the edge of the blade is located in the groove of the blade guide (SEE FIG F).

REMOVING THE SAW BLADE

To remove a blade, hold the blade and rotate the blade holder ring clockwise then lift out the blade (blade could be spring ejected).

WARNING: blade teeth are very sharp. For best cutting results ensure you use a blade suited to the material and cut quality you need.

5. ROLLER GUIDE

Ensure the blade is located and runs smoothly in the groove (SEE FIG F) otherwise the pendulum function will not work correctly and the blade will not be supported during cutting.

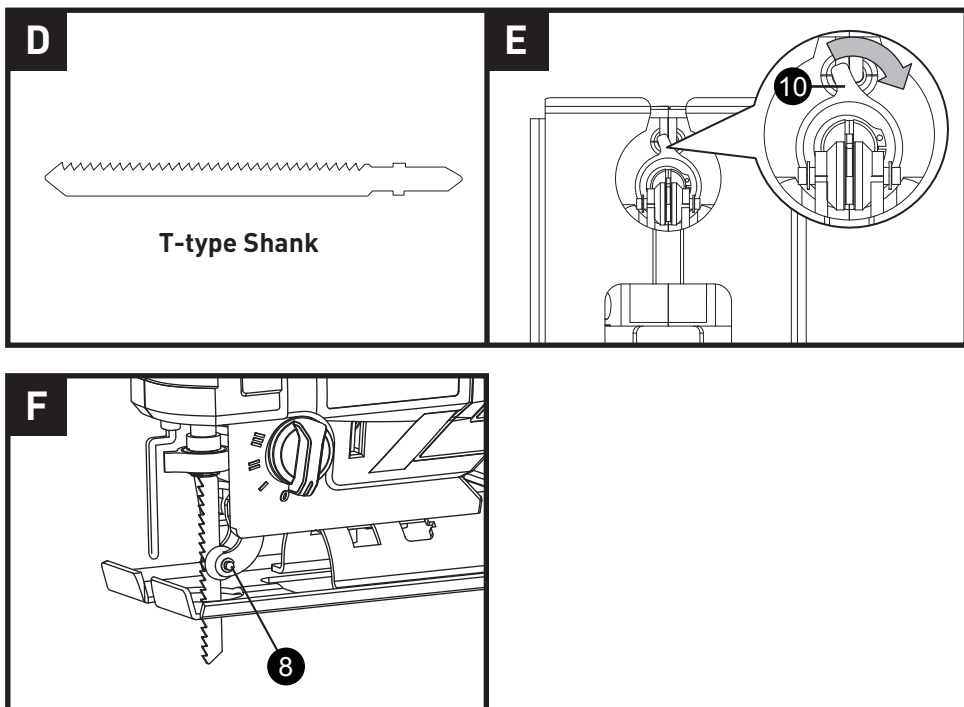

Operating Instructions

6. ADJUSTING THE CUTTING ANGLE (SEE FIG. G, H)

Using a Allen key (4). Loosen the bolts securing the base plate (SEE FIG G). For preset angles rotate so the lines of the angle on the base plate and angle plate (6) superposition at the desired angle (0°, 15°, 30°, 45°) (SEE FIG H). For other miter angles, rotate to your desired angle (use a protractor scale). Following one of the above procedures, hold the base plate in position and firmly tighten the bolts to clamp the base plate at the desired angle. Finally, check the angle and ensure the base plate is firmly clamped. The angle markings on the base plate are accurate for most general purposes but it is recommended for accurate work to set the angle with a protractor and make a test cut on other material.

7. STARTING OPERATION

1) LOCK OFF SWITCH

The lock off switch (2) is used to prevent unintentional starting. For starting operation of the tool, first depress the lock-off button (1) and hold it in position, then press the lock off switch and release the lever to start operation.

For safety reasons the lock off switch of the tool cannot be locked; it must remain pressed during the entire operation.

2) FINGER PROTECTION

The finger protection is located in front of the blade holder. Whilst working, it will help prevent accidental contact with moving blade.

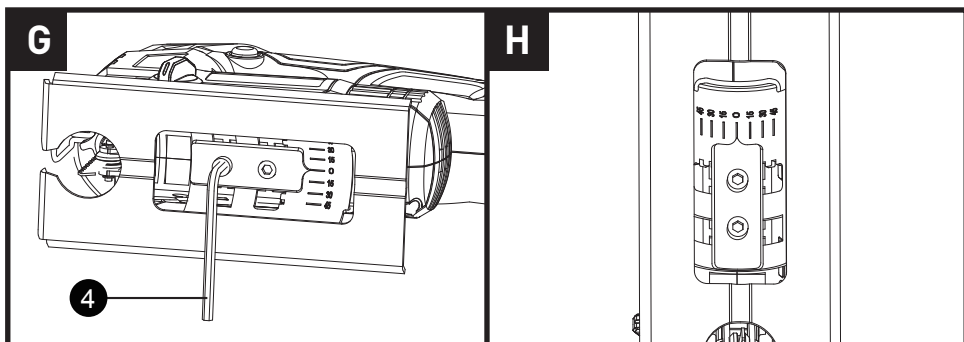

Operating Instructions

8. PENDULUM ACTION CONTROL (SEE FIG I)

The pendulum action varies the forward cutting angle of the blade for increased cutting efficiency. This can also be adjusted during no load running. Refer to the chart 1 for more details. Do not use excessive blade force when cutting with the pendulum action. The blade cuts on the upward stroke only.

| Chart 1 | |
|---------|--|
| 0 | Thin materials. Fine cuts. Tight curves. |
| I | Hard materials, (e.g. steel & chipboard) |
| II | Thick materials (e.g. wood) & plastic |
| III | Fast cuts (e.g. softwood). Cutting in the direction of the wood grain. |

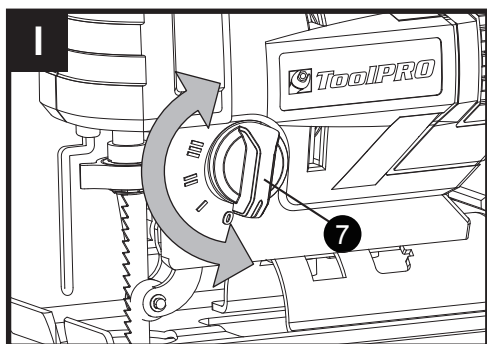

Working hints for your Jig Saw

If your jig saw becomes too hot, especially when used at low speed, set the speed to maximum and run no Load for 2-3 minutes to cool the motor. Avoid prolonged usage at very low speeds.

GENERAL

Always use a blade suited to the material and material thickness to be cut. Always ensure the work-piece is firmly held or clamped to prevent movement. For easier control, use low speed to start cutting, then increase to correct speed.

Any movement of the material may affect the quality of the cut. The blade cuts on the upward stroke and may chip the uppermost surface or face of the work piece. Ensure your uppermost surface is a non-visible surface when your work is finished.

1. CUTTING LAMINATES

Use a fine tooth blade when cutting most laminates and thin wood materials. To reduce edge chipping, clamp pieces of waste wood at both ends on both sides and cut through the waste wood during cutting.

2. CIRCLE CUTTING

Do not use the pendulum action when cutting tight circles or angles.

3. PLUNGE SAWING

Plunge cutting may be used only on soft materials such as wood, aerated concrete, gypsum plaster boards, etc.

Use only short saw blades.

Place the front edge of the base plate on the workpiece and switch on. Press the tool firmly against the workpiece and plunge the saw blade slowly into the workpiece.

As soon as the complete surface of the base plate rests on the work piece, continue to saw along the cutting line. (SEE FIG J, K)

4. METAL CUTTING

Use a finer tooth blade for ferrous metals and a coarse tooth blade for non-ferrous metals.

When cutting thin sheet metals, always clamp wood on both sides of the sheet to reduce vibration or tearing of the sheet metal. Both wood and sheet metal must be cut. Do not force the cutting blade when cutting thin metal or sheet steel, as they are harder materials and will take longer to cut. Excessive blade force may reduce the life of the blade or damage the motor. To reduce heat during metal cutting, add a little lubricant along the cutting line.

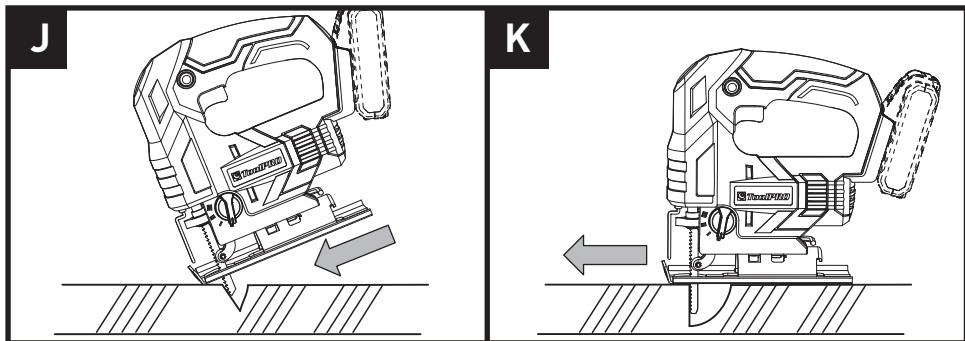

Maintenance

Before any work on the tool itself, remove the battery pack.

There are no user serviceable parts in your power tool. Never use water or chemical cleaners to clean your power tool. Wipe clean with a dry cloth. Always store your power tool in a dry place. Keep the motor ventilation slots clean. Keep all working controls free of dust. Occasionally you may see sparks through the ventilation slots. This is normal and will not damage your power tool.

Disposal of an exhausted battery pack



Li-Ion

To preserve natural resources, please recycle or dispose of the battery pack properly. This battery pack contains Lithium batteries. Consult your local waste authority for information regarding available recycling and/or disposal options.

Discharge your battery pack by operating your tool, then remove the battery pack from the tool housing and cover the battery pack connections with heavy-duty adhesive tape to prevent short circuit and energy discharge. Do not attempt to open or remove any of the components.

Troubleshooting

Symptom: The tool suddenly stops during operation.

Possible Causes:



- (1) Over load
- (2) Battery temperature too high
- (3) Low battery capacity

Possible Solution:

- (1) Relieve the load on the machine immediately and allow cooling for approx. 30 seconds at the highest no-load speed.
- (2) Cool down a little while and use again, or change the battery pack.
- (3) Charge the battery pack.

Technical Data

Technical Data Table

| | | |
|------------------|-------|---|
| Voltage | | 18V  |
| No load speed | | 0-2400/min |
| Stroke length | | 19mm |
| Cutting capacity | Wood | 65mm |
| | Steel | 5mm |
| Bevel capacity | | ±45° |
| Machine weight | | 1.82kg (Including battery) |
| Charging time | | 1-1.5hr by fast charger, 3-5hrs by slow charger |
| Charger Input | | 100-240V~50/60Hz |
| Charger Output | | 10.8~20V  1.5A by fast charger 10.8~20V  400mA by slow charger |
| Battery capacity | | 1.5/2.0Ah Li-ion battery |

**Staple your purchase receipt here
Before returning this product for
warranty or any other reason, please call.**

POSITEC AUSTRALIA PTY LIMITED

ABN 14 101 682 357

Unit 15, 23 Narabang Way Belrose 2085 NSW Australia

FREE CALL 1300 889 028

EMAIL:salesau@positecgroup.com

